



Deni Associates

7025 N.W. 4th St. - Plantation, Florida 33317

LEE COUNTY, FLORIDA
U.S.D.A. SOIL CONSERVATION SERVICE

MAPPING BY

HAMRICK AERIAL SURVEYS, INC.
CLEARWATER, FLORIDA

Marker Designation SCS-18 & TBM County LEE State FL

Located in Sec. 21 Twp. 43 S. Rge. 25 E. U.S.C.S. Quad Map FT. MYERS 7.5min.

To reach point from INT. OF US. 41 & SR. 78 IN N. FT. MYERS. GO E. ON SR. 78
6.5 MI. ± TO I-75 OVERPASS & MARKER.

Type of Marker 2" LEE CO. DISC, FLUSH W. GROUND Date set NOV. - DEC. 19 80

HORIZONTAL CONTROL originated on 2ND order control established by FLA. D.O.T. agency

in 1969, on North American 1927 datum.

Coordinates: North (y) 865408.192 East (x) 561601.218

(feet) 3rd Order State and Zone Florida, Mercator West

Reference Bearings to Station or Object:

Description	Bearing	Distance
<u>SCS-17</u>	<u>S 89° 59' 12.6" E</u>	<u>6393.640</u>
<u>SCS-19</u>	<u>N 88° 58' 57.4" W</u>	<u>4910.726</u>

Field Book 1 Page 23 Sketch by D.W. ALBERTSEN

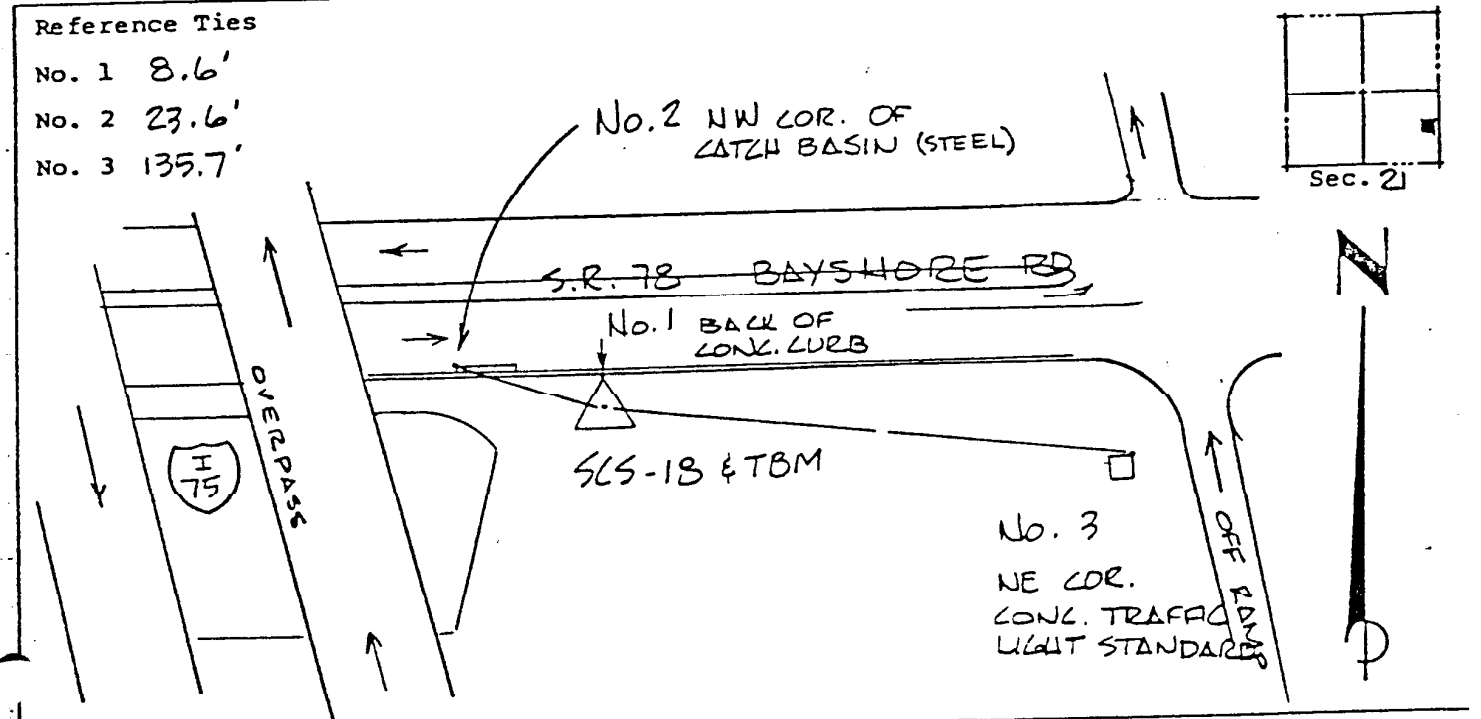

VERTICAL CONTROL originated on 1ST order control established by U.S.C. & G.S. agency

in 1966, on National Geodetic Survey Datum of 1929 datum.

Year 11.15 3rd Order Level Book 2 Page 9