



Dene Associates

7025 N.W. 4th St. • Plantation, Florida 33317

LEE COUNTY, FLORIDA
U.S.D.A. SOIL CONSERVATION SERVICE

MAPPING BY

HAMRICK AERIAL SURVEYS, INC.
CLEARWATER, FLORIDA

Marker Designation SCS-19 & TBM County LEE State FL
Located in Sec. 21 Twp. 43 S Rge. 25 E U.S.G.S. Quad Map FT. MYERS 7.5min

To reach point from INT. OF US 41 & SR. 78 IN N. FT. MYERS. GO E. ON SR. 78
5.5 MI. ± TO OLD BAYSHORE RD. & MARKER.

Type of Marker 2" LEE CO. DISC, 0.3' BLW. GRD. Date set NOV. - DEC. 19 80

HORIZONTAL CONTROL originated on 2ND order control established by FLA. D.O.T. agency

in 1969 year, on North American 1927 datum.

Coordinates: North (y) 865495.386 East (x) 556691.265

(feet) 3rd Order State and Zone Florida, Mercator West

Reference Bearings to Station or Object:

Description	Bearing	Distance
<u>SCS-18</u>	<u>S 88° 58' 57.4" E</u>	<u>4910.726</u>
<u>SCS-20</u>	<u>S 0° 15' 01.7" W</u>	<u>1354.515</u>

Field Book 1 Page 24 Sketch by D.W. ALBERTSEN

Reference Ties

- No. 1 25.3'
 - No. 2 63.6'
 - No. 3 63.0'
- N & T IN
P. POLE

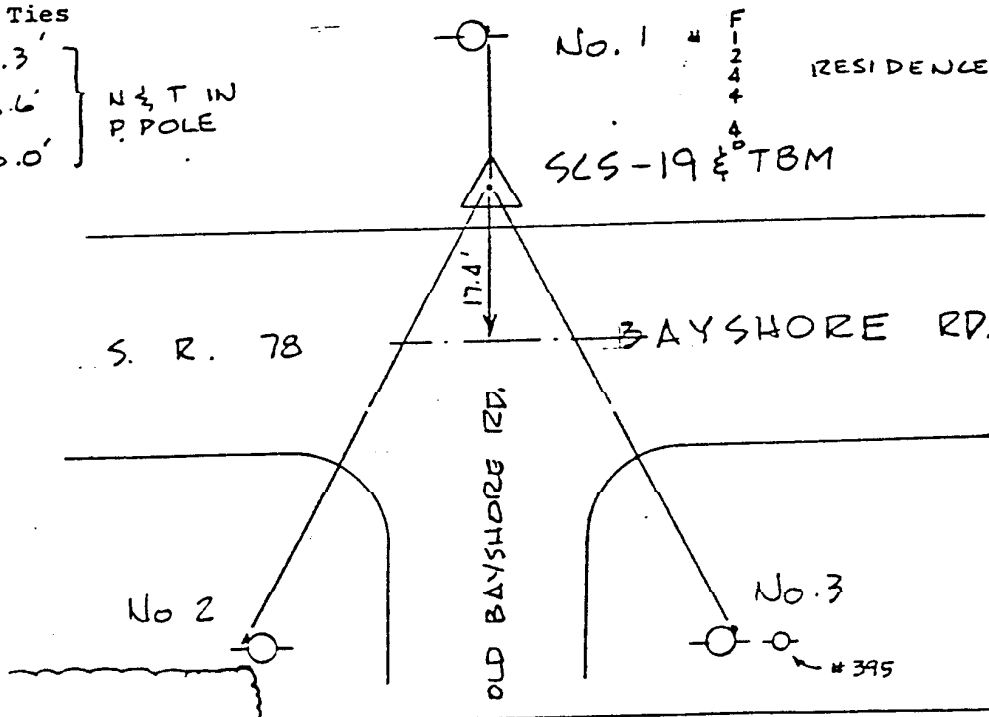

VERTICAL CONTROL originated on 1ST order control established by U.S.C. & G.S. agency

in 1966 year, on National Geodetic Survey Datum of 1929 datum.

Elevation 12.31, 3rd Order Level Book 2 Page 10