



Deni Associates

7025 N.W. 4th St. • Plantation, Florida 33317

LEE COUNTY, FLORIDA
U.S.D.A. SOIL CONSERVATION

MAPPING BY

HARRICK AERIAL SURVEYS
CLEARWATER, FLORIDA

Marker Designation SCS-29 & TBM County LEE State FL

Located in Sec. 18 Twp. 43 S. Rge. 25 E. U.S.G.S. Quad Map FT. MYERS

To reach point from INT. OF US. 41 & SR. 78 IN N. FT. MYERS. GO E. ON SR. 78
3.45 MI. ± TO SLATER RD. THENCE N. 2.5 MI. ± TO MARKER.

Type of Marker 2" LEE CO. DISC, D.S. B.W. GRD. Date set NOV. - DEC.

HORIZONTAL CONTROL originated on 2ND order control established by FLA. D.O.T. agency

in 1969, on North American 1927 datum.

Coordinates: North (y) 872258.512 East (x) 548619.19
(feet)

3rd Order State and Zone Florida, Mercator West

Reference Bearings to Station or Object:

Description	Bearing	Dist.
<u>SCS-28</u>	<u>S 1° 32' 19.1" W</u>	<u>148</u>
<u>SCS-30</u>	<u>N 5° 20' 08.2" W</u>	<u>144</u>

Field Book 1 Page 35 Sketch by D.W. ALBERTSEN

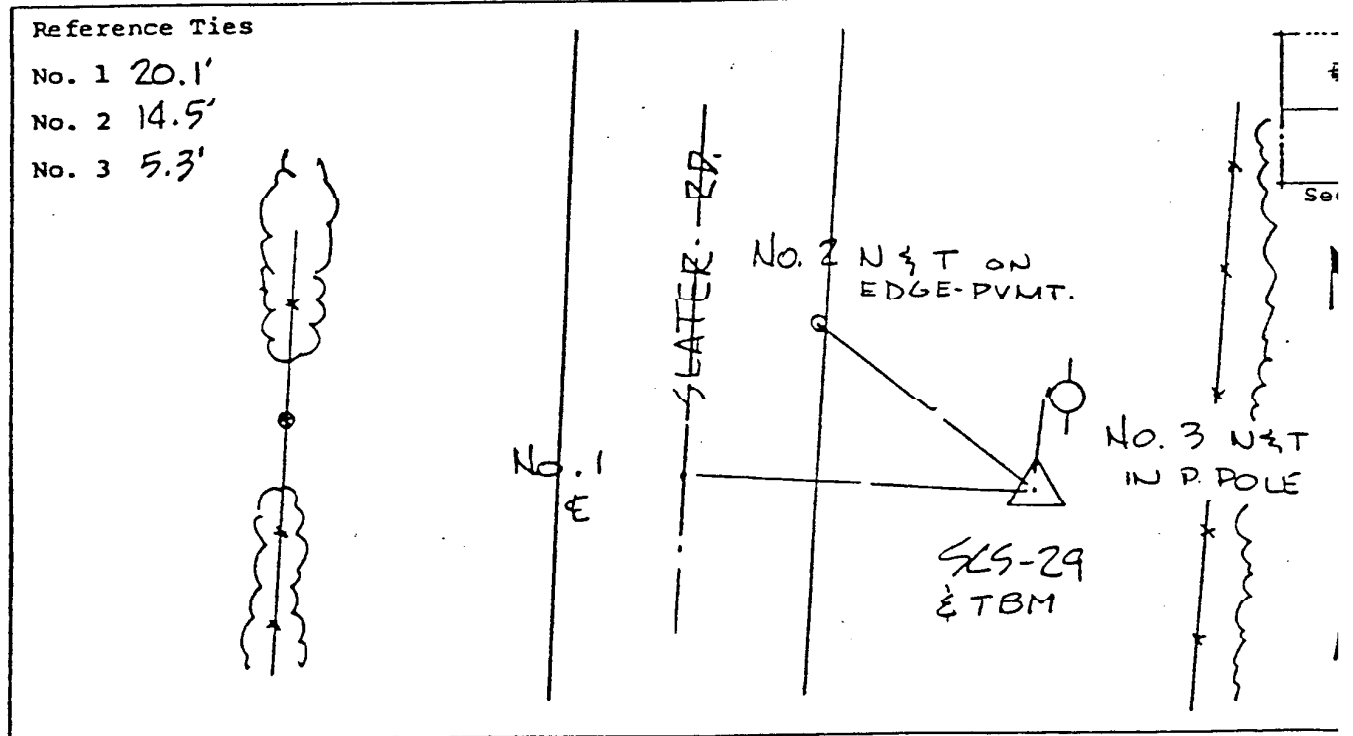

VERTICAL CONTROL originated on 1ST order control established by U.S.C. & G.S. agency

in 1966, on National Geodetic Survey Datum of 1929 datum.

17.87 3rd Order Level Book ? Page 15