



# Dani Associates

7025 N.W. 4th St. • Plantation, Florida 33317

## LEE COUNTY, FLORIDA AERIAL MAPPING PROJECT

MAPPING BY  
HAMRICK AERIAL SURVEYS, INC.  
CLEARWATER, FLORIDA

Marker Designation DNR R-26 County LEE State FL  
Located in Sec. 26 Twp. 435 Rge. 20E u.s.c.s. Quad Map PORT BOCA GRANDE 7.5mir

To reach point from INT. GASPARILLA RD. & LEE-CHARLOTTE CO. LINE:  
GO S 3.1 MI ± TO "T" IN ROAD; THENCE W 0.1 MI ± TO GULF BLVD.;  
THENCE CONTINUE S. 1.65 MI ± TO BEND IN ROAD; THENCE ALONG  
CURVES 0.35 MI ± TO SAND ROAD E.S.; THENCE S. 0.1 MI ± TO MARKER.

Type of Marker STD. BRASS DISC SET IN CONC. Date <sup>RECOVERED</sup> FEB. 19 81

HORIZONTAL CONTROL originated on \_\_\_\_\_ order control established by \_\_\_\_\_ agency

in \_\_\_\_\_, on North American 1927 datum.

Coordinates: North (y) \_\_\_\_\_ East (x) \_\_\_\_\_  
(feet) 3rd Order State and Zone Florida, Mercator West

Reference Bearings to Station or Object:

Description	Bearing	Distance

Field Book \_\_\_\_\_ Page \_\_\_\_\_ Sketch by A. LETHEBY

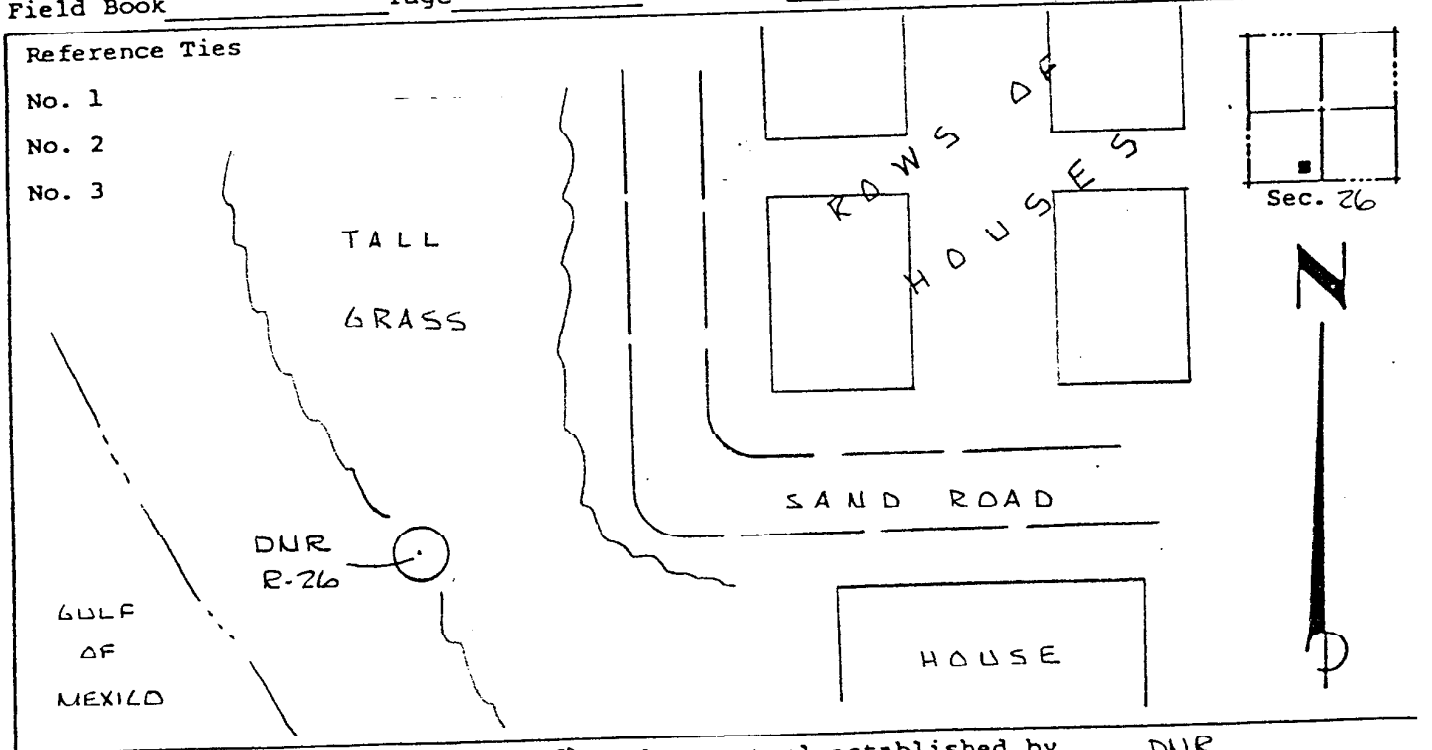

VERTICAL CONTROL originated on 3<sup>rd</sup> order control established by DNR agency

in 1975, on National Geodetic Survey Datum of 1929 datum.

Elevation 05.67, 3rd Order Level Book V3 Page 46