



*Went Associates*  
7025 N.W. 4th St. - Plantation, Florida 33317

LEE COUNTY, FLORIDA  
U.S.D.A. SOIL CONSERVATION SERVICE  
MAPPING BY  
HAMRICK AERIAL SURVEYS, INC.  
CLEARWATER, FLORIDA

Marker Designation TBM SV-5 County LEE State FL  
Located in Sec. 14 Twp. 43 S. Rge. 25 E. U.S.G.S. Quad Map FORT MYERS 7.5min

To reach point from INT. OF US. 41 & RTE. 78 IN N. FT. MYERS. GO E. ON RTE. 78  
8.5 MI± TO PALM CREEK DR. N. THEN GO N. 1.5 MI± TO CURVE IN THE RD.  
RIGHT. THEN GO NW. ALONG DIRT TRAIL PARALELLING POWER LINE 0.15 MI±  
TO MARKER.

Type of Marker 8" SPIKE IN W. FACE OF P. POLE Date set NOV. - DEC. 19 80  
HORIZONTAL CONTROL originated on \_\_\_\_\_ order control established by \_\_\_\_\_  
in \_\_\_\_\_, on North American 1927 datum. \_\_\_\_\_ agency  
year  
Coordinates: North (y) \_\_\_\_\_ East (x) \_\_\_\_\_  
(feet)  
3rd Order State and Zone Florida, Mercator West

Reference Bearings to Station or Object:

Description	Bearing	Distance

Field Book 1 Page \_\_\_\_\_ Sketch by B. R. HOMOLA

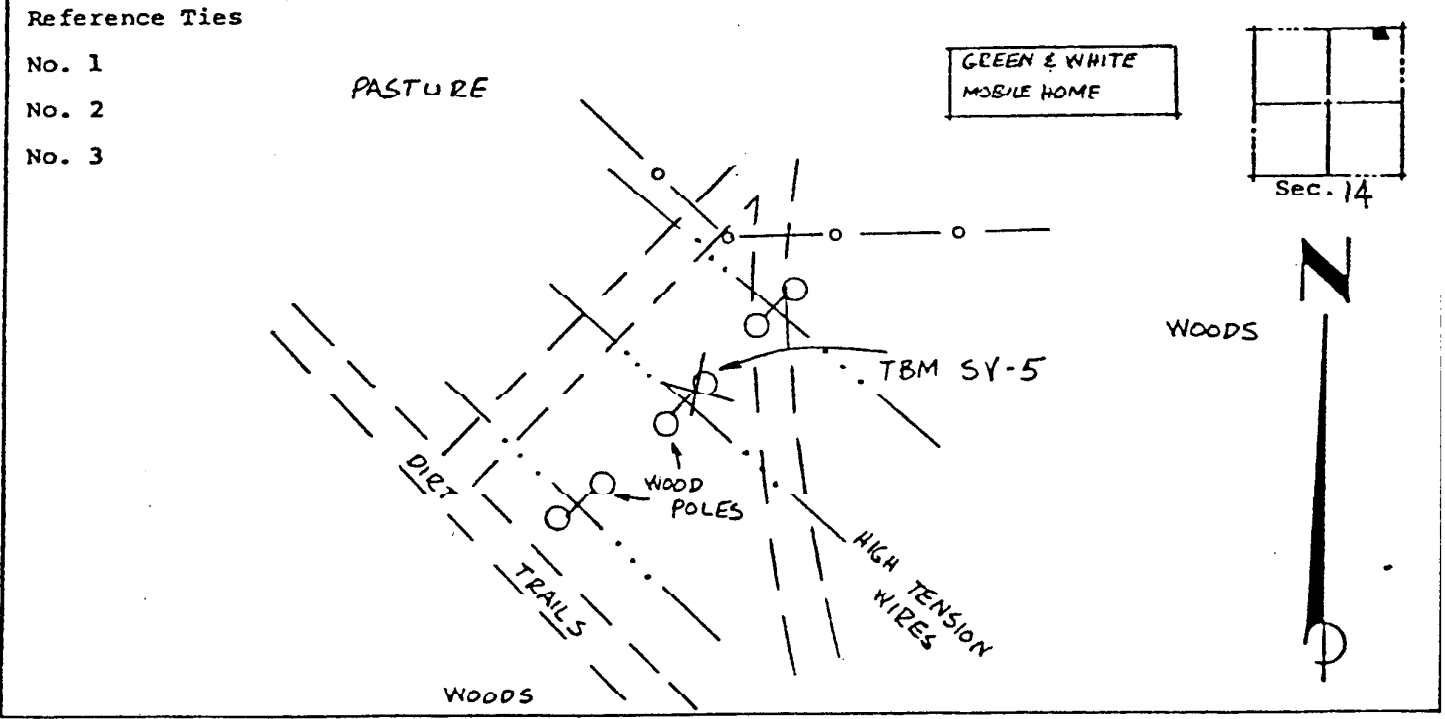

VERTICAL CONTROL originated on 1st order control established by U.S.C. & G.S. agency  
in 1966, on National Geodetic Survey Datum of 1929 datum.  
year  
Elevation 21.62, 3rd Order Level Book 3 Page 4