



7025 N.W. 4th St. - Plantation, Florida 33317

U.S.D.A. SOIL CONSERVATION SERVICE

MAPPING BY

HAMRICK AERIAL SURVEYS, INC.  
CLEARWATER, FLORIDA

Marker Designation TBM BAYSHORE County LEE State FL

Located in Sec. 15 Twp. 43 S. Rge. 25 E. U.S.G.S. Quad Map FORT MYERS 7.5min.

To reach point from INT US 41 & SR 78 IN N. FT MYERS; GO E. ON SR 78  
7.0 MI ± TO NALLE RD.; THENCE N. 1.4 MI ± TO MARKER.

Type of Marker STD US & GS BRASS DISC. IN CONC. Date set (Recovered) NOV. - DEC. 19 80  
elev.

HORIZONTAL CONTROL originated on \_\_\_\_\_ order control established by \_\_\_\_\_ agency

in \_\_\_\_\_, on North American 1927 datum.

Coordinates: North (y) \_\_\_\_\_ East (x) \_\_\_\_\_  
(feet)

3rd Order

State and Zone Florida, Mercator West

Reference Bearings to Station or Object:

Description	Bearing	Distance

Field Book 1 Page \_\_\_\_\_ Sketch by A LETHERY

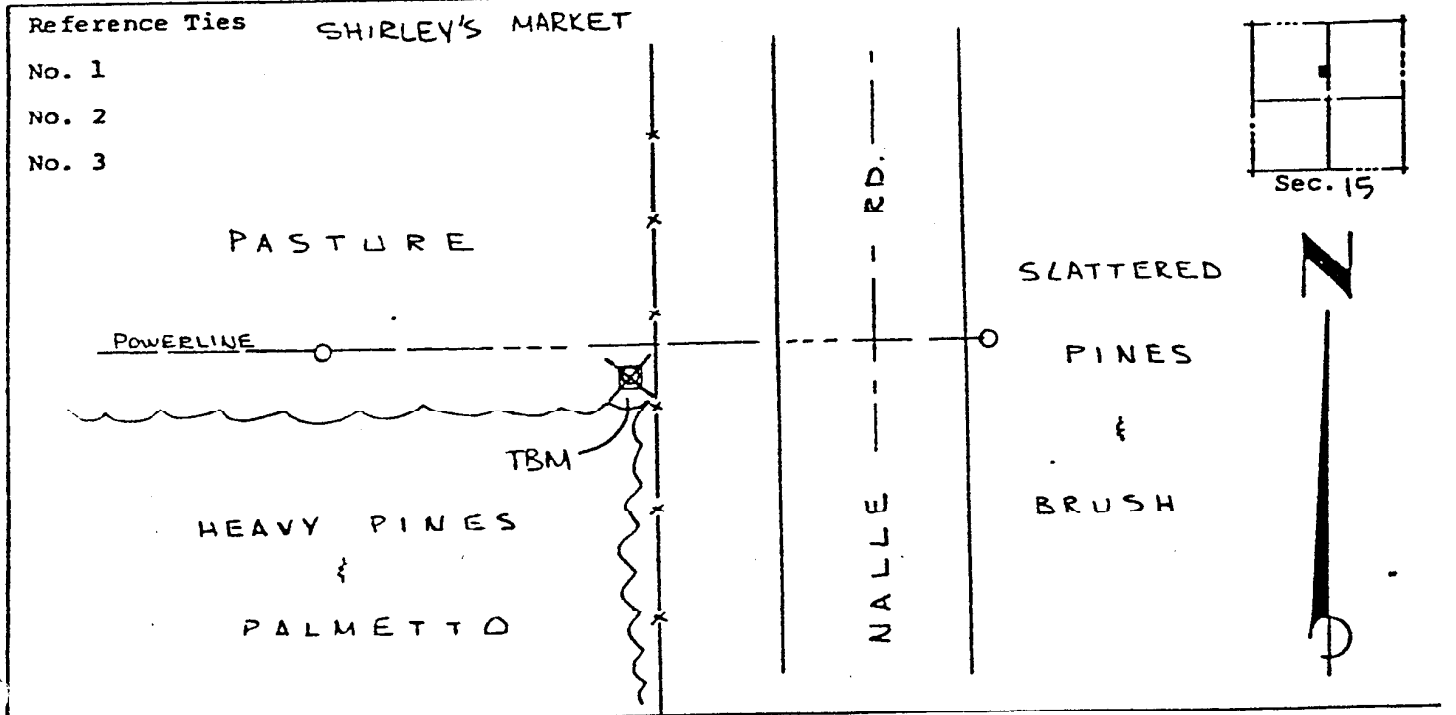

VERTICAL CONTROL originated on 1st order control established by U.S.C. & G.S. agency

in 1966, on National Geodetic Survey Datum of 1929 datum.

year 1933, 3rd Order Level Book 2 Page 18