



Deni Associates

7025 N.W. 4th St. - Plantation, Florida 33317

LEE COUNTY, FLORIDA AERIAL MAPPING PROJECT

MAPPING BY
HAMRICK AERIAL SURVEYS, INC.
CLEARWATER, FLORIDA

Marker Designation B G - 6 & TBM County LEE State FL

Located in Sec. 14 Twp. 43 S Rgc. 20 E U.S.G.S. Quad Map PLACIDA 7.5min.

To reach point from INT. GASPARIILLA RD. + LEE-CHARLOTTE CO. LINE:
Go S. ON GASPARIILLA RD + 2.65 MI TO A CROSS STREET;
Go W. ON STREET TO A GRAVEL PARKING LOT + STATION.

Type of Marker CUNISELED "+" ON SEAWALL 0.9' S. OF EXPAU - Date set FEB, 19 81

HORIZONTAL CONTROL originated on 2ND order control established by USC + GS agency

in 1961 year, on North American 1927 datum.

Coordinates: North (y) 878,850.529 East (x) 413,617.274
(feet)

3rd Order State and Zone Florida, Mercator West

Reference Bearings to Station or Object:

Description	Bearing	Distance
<u>BG-5</u>	<u>S 1° 27' 30.3" E</u>	<u>1992.658</u>
<u>BG-7</u>	<u>N 5° 40' 12.9" W</u>	<u>3996.535</u>

Field Book H-3 Page 11 Sketch by G L W

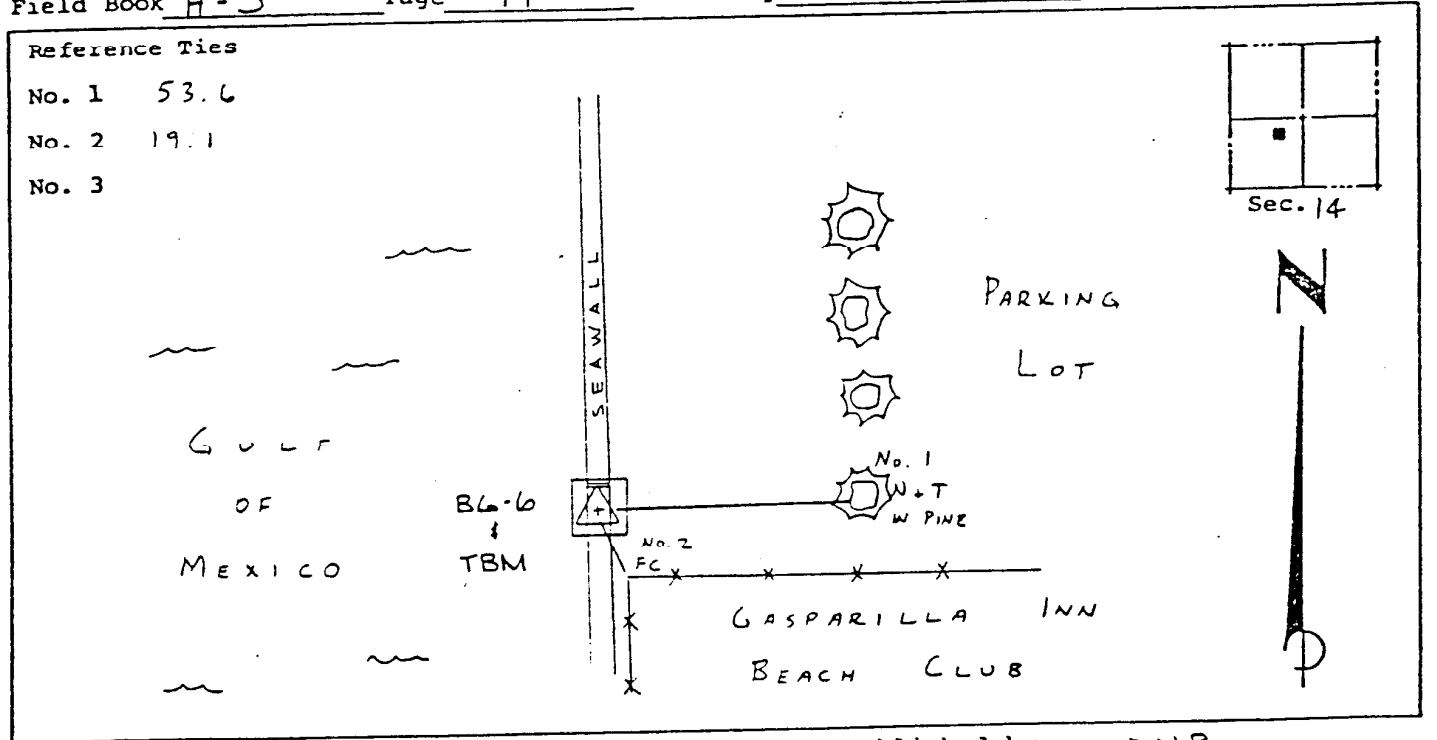

VERTICAL CONTROL originated on 3RD order control established by DNR agency

in 1975 year, on National Geodetic Survey Datum of 1929 datum.

Elevation 10.28, 3rd Order Level Book V3 Page 49