



7025 N.W. 4th St. - Plantation, Florida 33317

MAPING BY
HAMRICK AERIAL SURVEYS, INC.
CLEARWATER, FLORIDA

Marker Designation TBM SV-31 County LEE State FL
Located in Sec. 7 Twp. 43S Rge. 25E U.S.G.S. Quad Map TUCKERS CORNER 7.5mi

To reach point from INT US 41 & SR 78 IN N. FT. MYERS : GO E. ON SR 78
3.45 MI ± TO SLATER RD. ; THENCE N 40 MI ± TO NALLE GRADE RD. ;
THENCE W 0.5 MI ± TO MARKER.

Type of Marker TOP OF 4"X4" CONC. POST Date set NOV. - DEC. 19 80
HORIZONTAL CONTROL originated on _____ order control established by _____ agency

in _____, on North American 1927 datum.
Coordinates: North (y) _____ East (x) _____

(feet) 3rd Order State and Zone Florida, Mercator West

Reference Bearings to Station or Object:

Description	Bearing	Distance

Field Book 1 Page _____ Sketch by A. LETHEBY

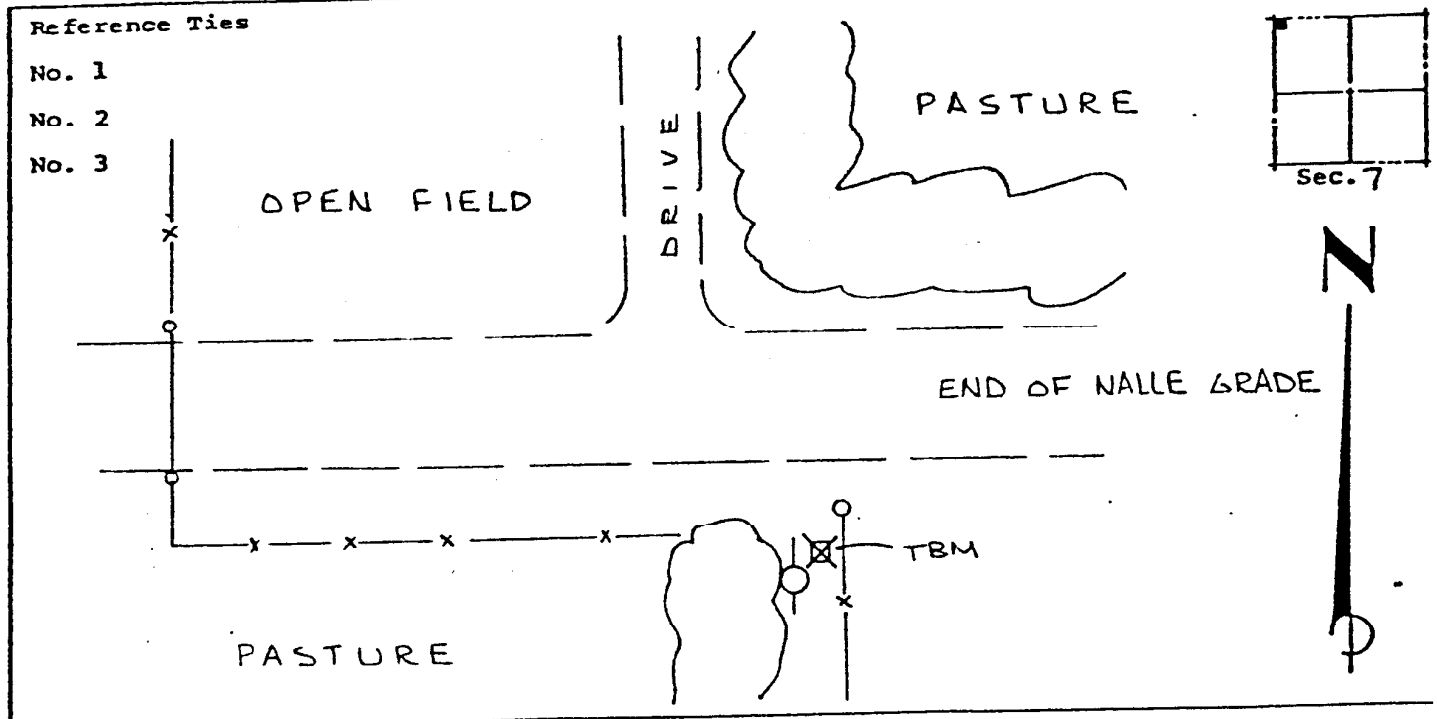

VERTICAL CONTROL originated on 1st order control established by USC & GS agency

in 1966, on National Geodetic Survey Datum of 1929 datum.

year 1966 Elevation 25.92, 3rd Order Level Book 2 Page 55