



7025 N.W. 4th St. - Plantation, Florida 33317

U.S.D.A. SOIL CONSERVATION SERVICE
MAPPING BY
HAMRICK AERIAL SURVEYS, INC.
CLEARWATER, FLORIDA

Marker Designation TRM SV-22 County LEE State FL
Located in Sec. 6 Twp. 43S Rge. 25E U.S.G.S. Quad Map TUCKERS CORNER 7.5min.

To reach point from INT US 41 & SR 78 IN N. FT. MYERS : GO E. ON SR 78
3.45 MI ± TO SLATER RD. THENCE N. 40 MI ± TO WAVE GRADE RD. ;
THENCE E 0.5 MI ± TO HUFFMASTER RD. ; THENCE N. 1.0 MI ± TO
MARKER

Type of Marker 2x2 CONC POST/SEC COR Date set NOV. - DEC. 19 80

HORIZONTAL CONTROL originated on _____ order control established by _____ agency
in _____, on North American 1927 datum.
year _____ East (x) _____

Coordinates: North (y) _____
(feet) _____ East (x) _____
3rd Order State and Zone Florida, Mercator West

Reference Bearings to Station or Object:

Description	Bearing	Distance

Field Book 1 Page _____ Sketch by A LETHEBY

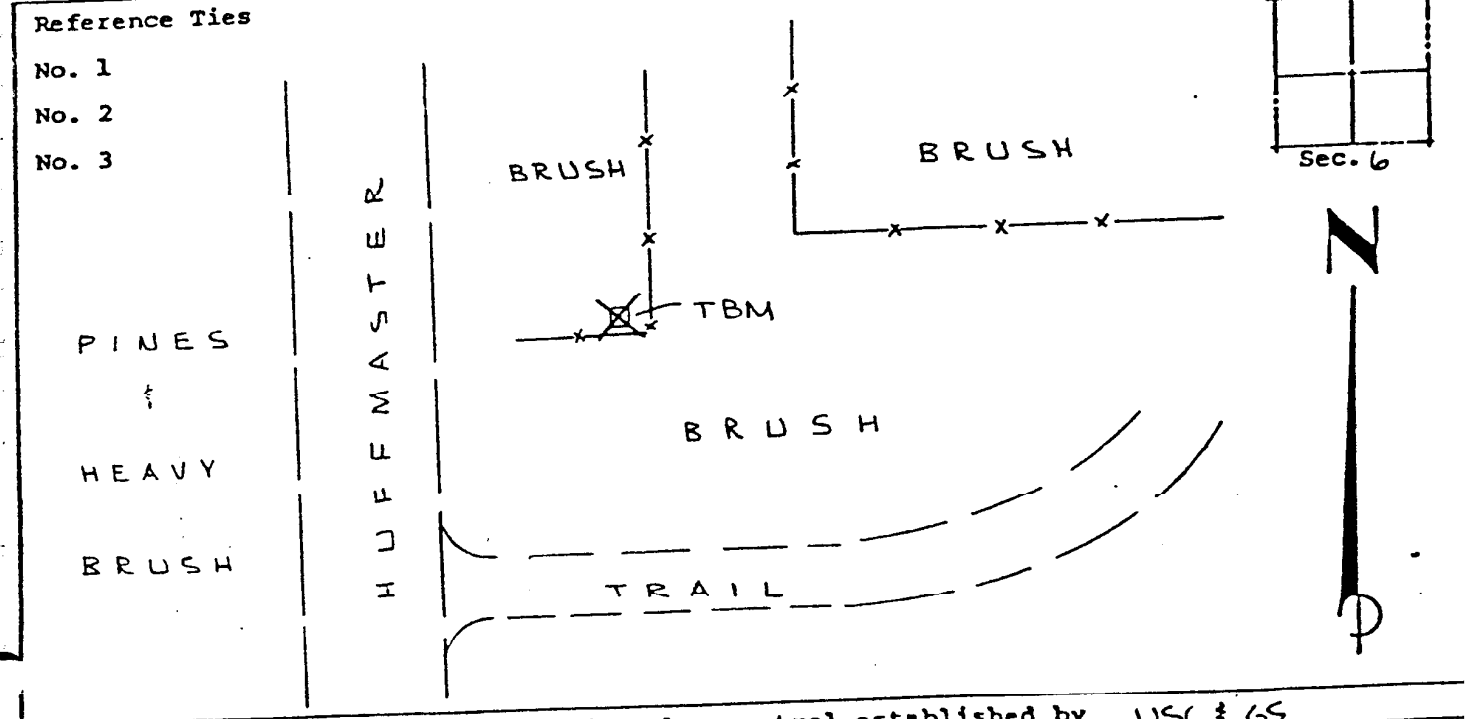

VERTICAL CONTROL originated on 1st order control established by USC & GS agency

in 1966, on National Geodetic Survey Datum of 1929 datum.
year _____
Elevation 24.34, 3rd Order Level Book 2 Page 51