



Deni Associates

7025 N.W. 4th St. • Plantation, Florida 33317

LEE COUNTY, FLORIDA
AERIAL MAPPING PROJECT

MAPPING BY
HAMRICK AERIAL SURVEYS, INC.
CLEARWATER, FLORIDA

Marker Designation USCGS BM F247 County LEE State FL

Located in Sec. 2 Twp. 48S Rge. 25E U.S.G.S. Quad Map BONITA SPRINGS 7.5min.

To reach point from INT. OF US. BUS. 41 & SR. 865 IN BONITA SPRINGS.
GO W. ON SR. 865 0.45 MI. TO MARKER.

Type of Marker FLA. SRD. CAP SET IN CONC. HEADWALL Date ^{RECOVERED} JAN. 19 81

HORIZONTAL CONTROL originated on _____ order control established by _____
in _____, on North American 1927 datum. _____ agency

Coordinates: North (y) _____ East (x) _____
(feet) _____
3rd Order State and Zone Florida, Mercator West

Reference Bearings to Station or Object:

| Description | Bearing | Distance |
|-------------|---------|----------|
| | | |
| | | |

Field Book _____ Page _____ Sketch by B. R. HOMOLA

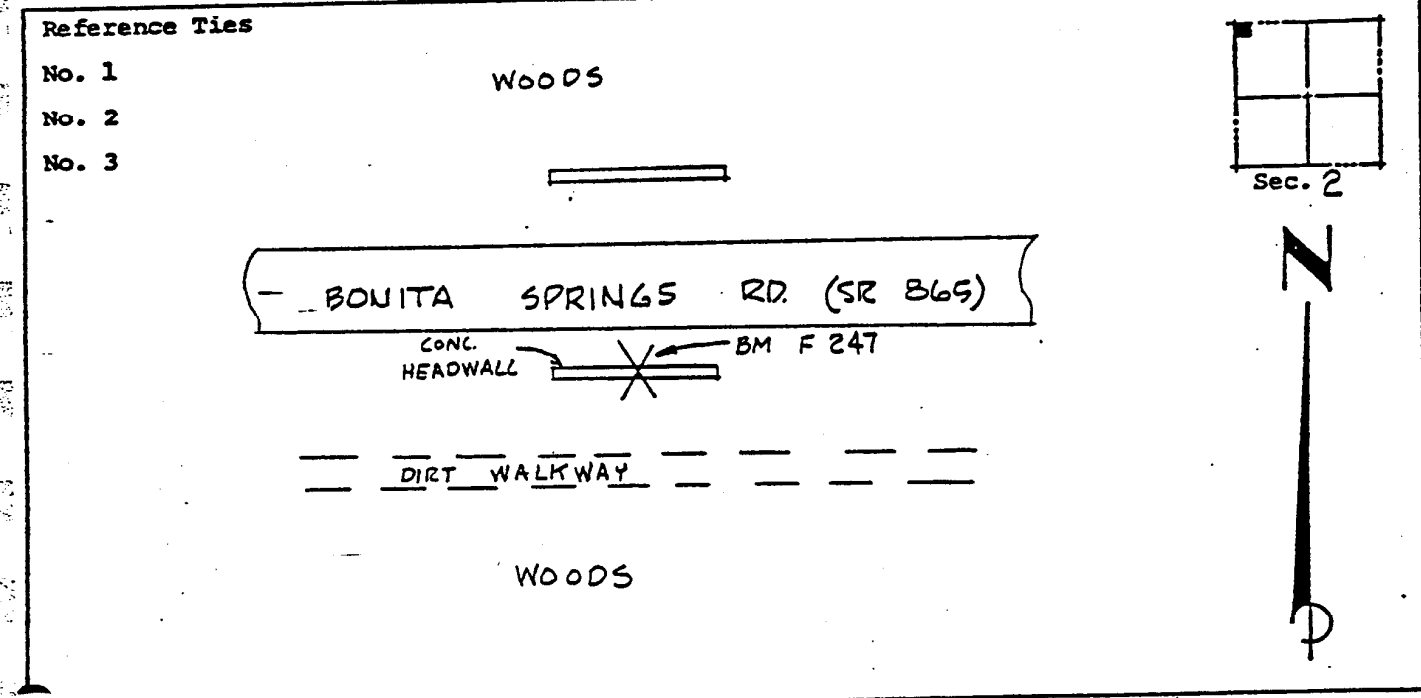

VERTICAL CONTROL originated on 1st order control established by USC & GS agency
in 1966, on National Geodetic Survey Datum of 1929 datum.

Elevation 12.523, 3rd Order Level Book V3 Page 16
(feet)