

Marker Designation USC&GS BM 11.50 County COLLIER State FL

Located in Sec. 5 Twp. 486 Rge. 25 E. U.S.G.S. Quad Map BONITA SPRINGS 7.5min.

To reach point from INT. OF US. BUS. 41 & SR. 865 IN BONITA SPRINGS.
GO W. ON SR. 865 2.5 MI.± TO VANDERBILT DR. & MARKER.

Type of Marker FLA. SRD. CAP SET IN CONC HEADWALL Date ^{RECOVERED} ~~set~~ JAN. 19 81

HORIZONTAL CONTROL originated on _____ order control established by _____
in _____, on _____ North American 1927 _____ datum. _____ agency

Coordinates: North (y) _____ East (x) _____
(feet) _____
3rd Order State and Zone Florida, Mercator West

Reference Bearings to Station or Object:

Description	Bearing	Distance

Field Book _____ Page _____ Sketch by B.R. HOMOLA

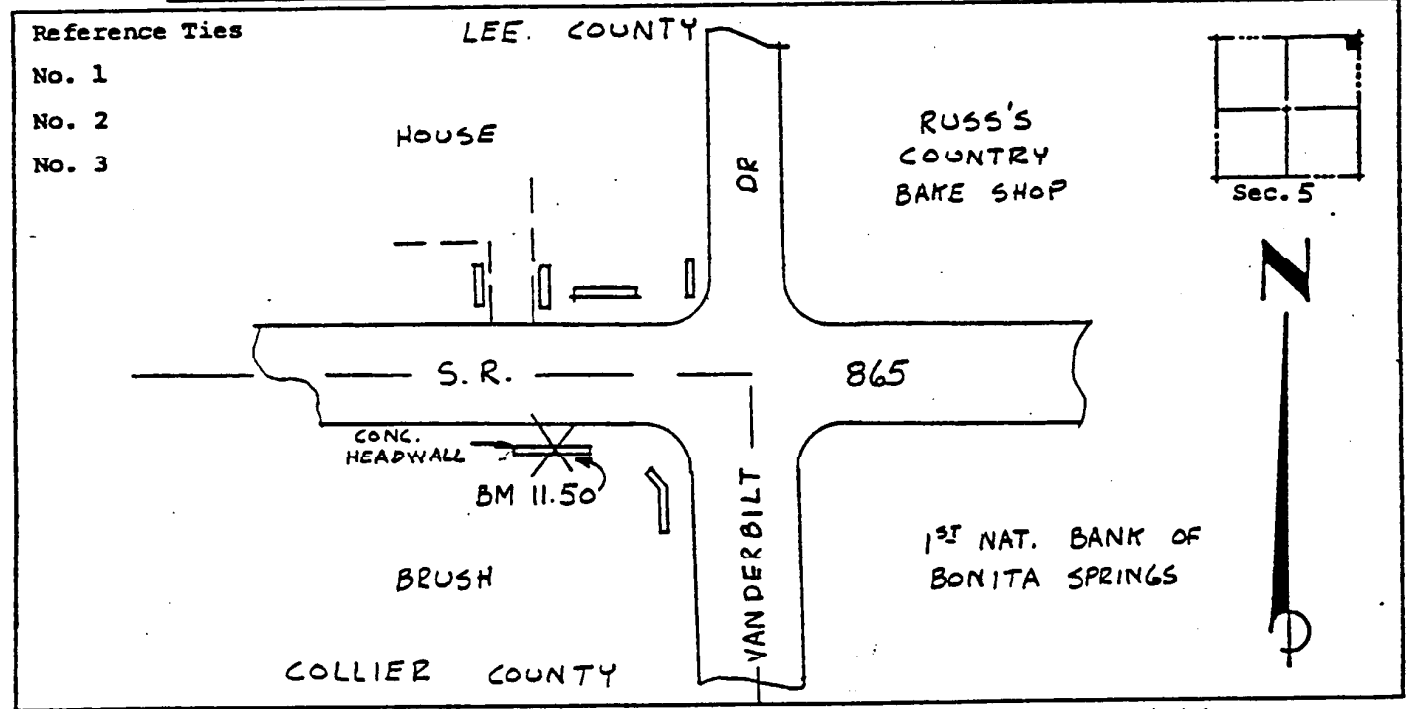

VERTICAL CONTROL originated on 1ST order control established by USC&GS agency

in 1966, on National Geodetic Survey Datum of 1929 datum.
year
Elevation 11.450, 3rd Order Level Book V3 Page 15
(feet)