



Deni Associates

7025 N.W. 4th St. • Plantation, Florida 33317

LEE COUNTY, FLORIDA
AERIAL MAPPING PROJECT

MAPPING BY
HAMRICK AERIAL SURVEYS, INC.
CLEARWATER, FLORIDA

Marker Designation USCGS BM J244 County LEE State FL
Located in Sec. 2 Twp. 48S Rge. 25E U.S.G.S. Quad Map BONITA SPRINGS 7.5min.

To reach point from INT. OF US. BUS. 41 & SR. 865 IN BONITA SPRINGS. GO SW.
ON US. BUS. 41 0.6 MI. TO MARKER.

Type of Marker BRASS CAP SET IN ROCK OUTCROP Date ^{RECOVERED} ~~set~~ JAN. 19 81

HORIZONTAL CONTROL originated on _____ order control established by _____
in _____, on _____ North American 1927 _____ datum. agency

Coordinates: North (y) _____ East (x) _____
(feet) 3rd Order State and Zone Florida, Mercator West

Reference Bearings to Station or Object:

Description	Bearing	Distance

Field Book _____ Page _____ Sketch by B. R. HOMOLA

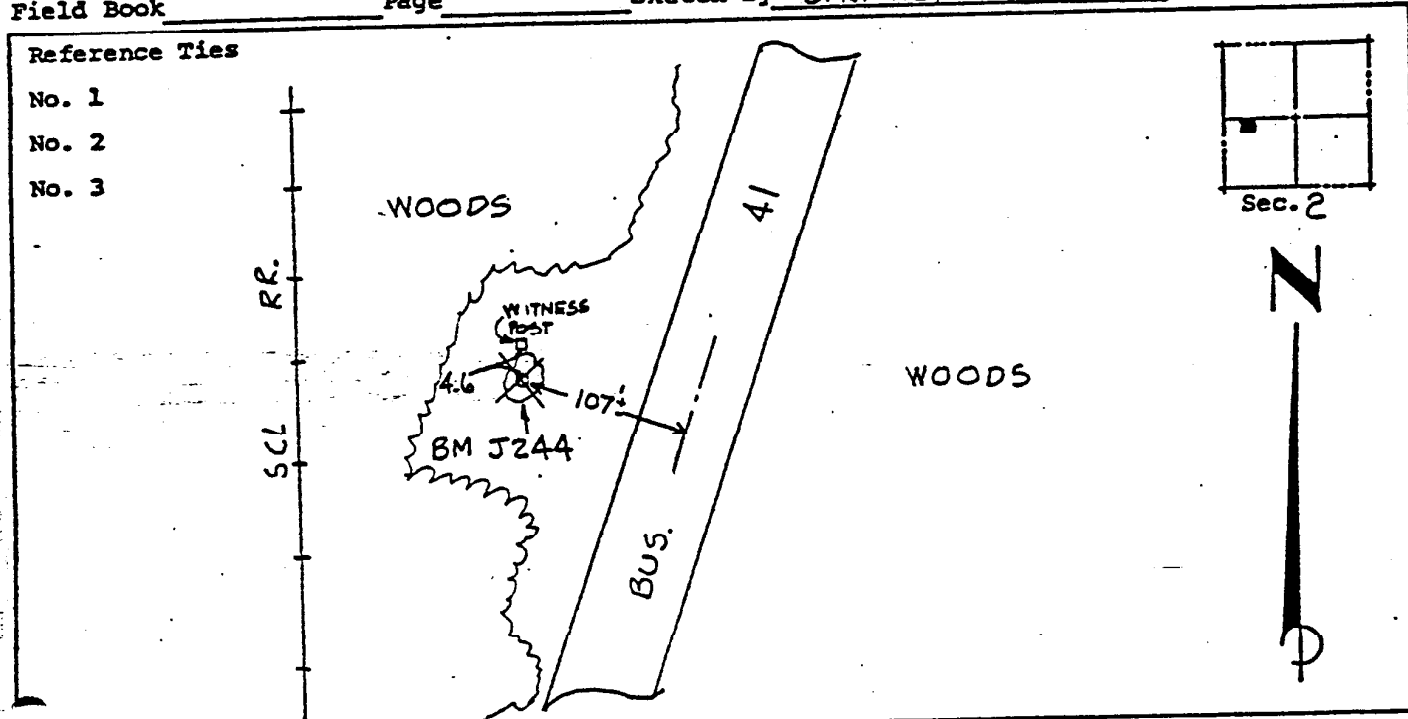

VERTICAL CONTROL originated on 1st order control established by USCGS agency

in 1966, on National Geodetic Survey Datum of 1929 datum.
year
Elevation 11.463, 3rd Order Level Book V3 Page _____
(feet)