



Deni Associates

7025 N.W. 4th St. - Plantation, Florida 33317

LEE COUNTY, FLORIDA
AERIAL MAPPING PROJECT

MAPPING BY
HAMRICK AERIAL SURVEYS, INC.
CLEARWATER, FLORIDA

Marker Designation TBM FMBV-15 County LEE State FL
Located in Sec. 1 Twp. 43S Rge. 25 E U.S.G.S. Quad Map BONITA SPRINGS 7.5min.

To reach point from U.S. 41 & SR 865 - BONITA BEACH RD. IN BONITA SPRINGS;
GO E. ON SR 865 2.3 MI ± TO TBM

Type of Marker EXISTING CHISELED "D" ON CONC. Date set JAN. 19 81

HORIZONTAL CONTROL originated on _____ order control established by _____ agency
in _____, on North American 1927 datum.
Coordinates: North (y) _____ East (x) _____
(feet)

Reference Bearings to Station or Object:
3rd Order State and Zone Florida, Mercator West

Description	Bearing	Distance

Field Book _____ Page _____ Sketch by D.W. ALBERTSEN

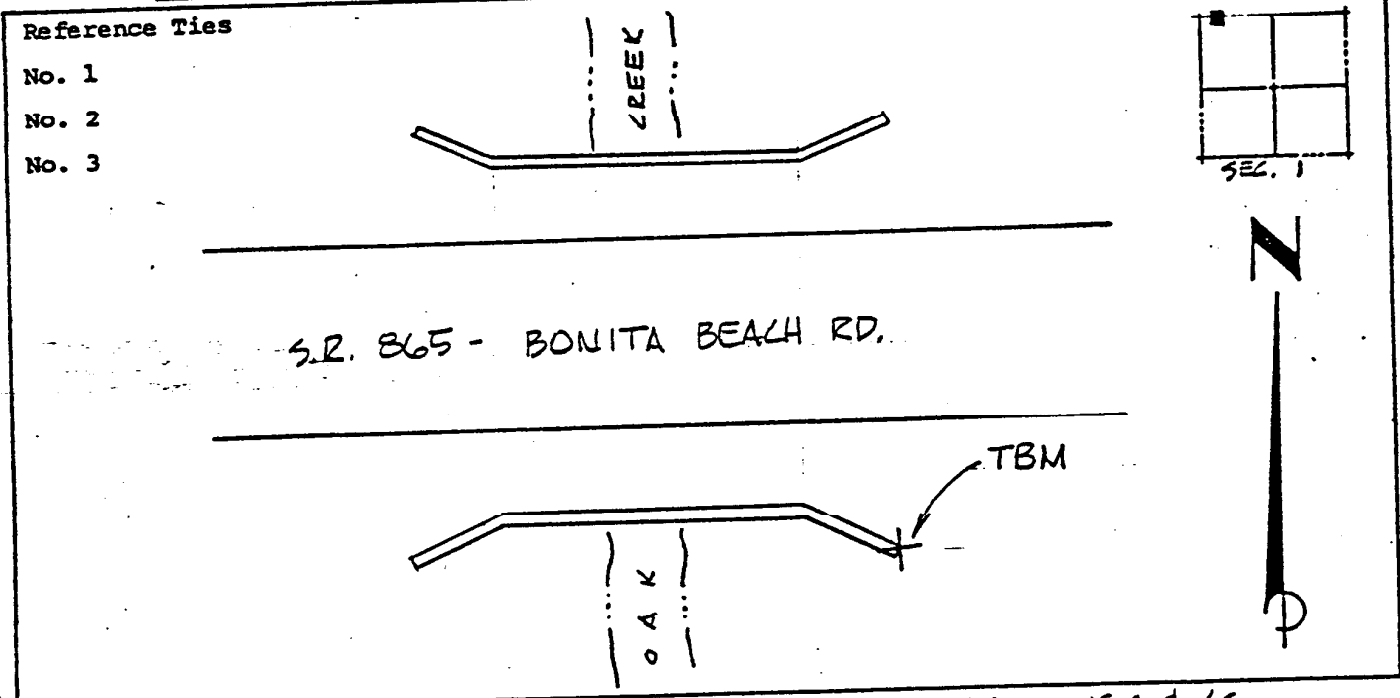

VERTICAL CONTROL originated on 1st order control established by USC & GS agency
in 1966, on National Geodetic Survey Datum of 1929 datum.

Elevation 11.60, 3rd Order Level Book V.3 Page 26
(feet)