



# Deni Associates

7025 N.W. 4th St. • Plantation, Florida 33317

## LEE COUNTY, FLORIDA AERIAL MAPPING PROJECT

MAPPING BY  
HAMRICK AERIAL SURVEYS, INC.  
CLEARWATER, FLORIDA

Marker Designation USC&GS BM E 247 County LEE State FL

Located in Sec. 3 Twp. 48 S. Rge. 25 E. U.S.G.S. Quad Map BONITA SPRINGS 7.5min.

To reach point from INT. OF US. BUS. 41 E SR. 865 IN BONITA SPRINGS.  
GO W. ON SR. 865 0.9 MI. TO MARKER.

Type of Marker FLA. SRD. CAP SET IN CONG. HEADWALL Date <sup>RECOVERED</sup> ~~set~~ JAN. 19 81

HORIZONTAL CONTROL originated on \_\_\_\_\_ order control established by \_\_\_\_\_

in \_\_\_\_\_, on North American 1927 datum. \_\_\_\_\_ agency

Coordinates: North (y) \_\_\_\_\_ East (x) \_\_\_\_\_  
(feet)

3rd Order State and Zone Florida, Mercator West

Reference Bearings to Station or Object:

Description	Bearing	Distance

Field Book \_\_\_\_\_ Page \_\_\_\_\_ Sketch by B. R. HOMOLA

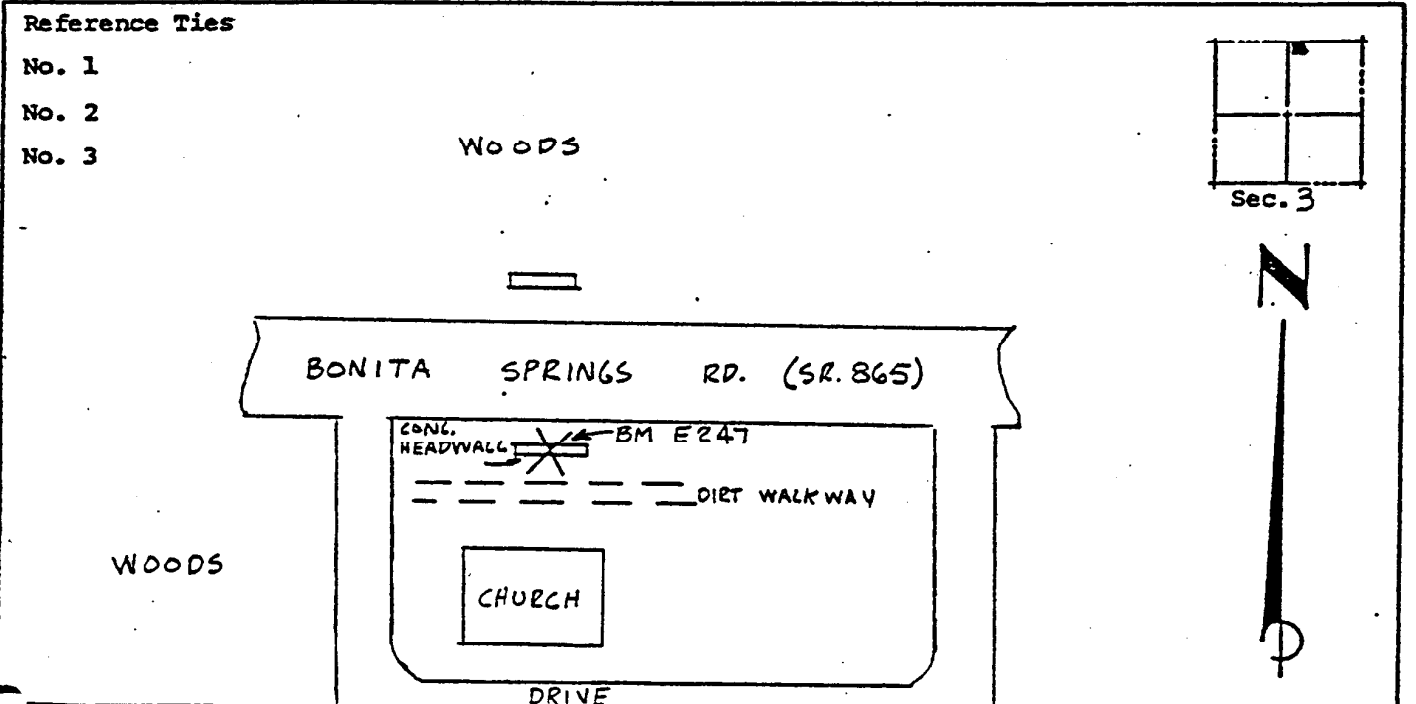

VERTICAL CONTROL originated on 1<sup>ST</sup> order control established by USC&GS agency

in 1966, on National Geodetic Survey Datum of 1929 datum.

year  
Elevation 16.335, 3rd Order Level Book V3 Page 16  
(feet)