



Deni Associates

7025 N.W. 4th St. • Plantation, Florida 33317

LEE COUNTY, FLORIDA AERIAL MAPPING PROJECT

MAPPING BY
HAMRICK AERIAL SURVEYS, INC.
CLEARWATER, FLORIDA

Marker Designation USC & GS BM L 244 County LEE State FL
Located in Sec. 35 Twp. 47S Rge. 25E U.S.G.S. Quad Map BONITA SPRINGS 7.5min.

To reach point from INT. OF US. BUS. 41 & SR. 865 IN BONITA SPRINGS. GO
N. ON US. BUS. 41 0.2 MI ± TO CULVERT @ OAK CREEK AND MARKER.

Type of Marker FLA. SRQ. CAP SET IN CONC. HEADWALL Date ^{RECOVERED} set JAN. 19 81

HORIZONTAL CONTROL originated on _____ order control established by _____

in _____, on _____ North American 1927 _____ datum. _____ agency

Coordinates: North (y) _____ East (x) _____
(feet)

3rd Order State and Zone Florida, Mercator West

Reference Bearings to Station or Object:

Description	Bearing	Distance

Field Book _____ Page _____ Sketch by B. R. HOMOLA

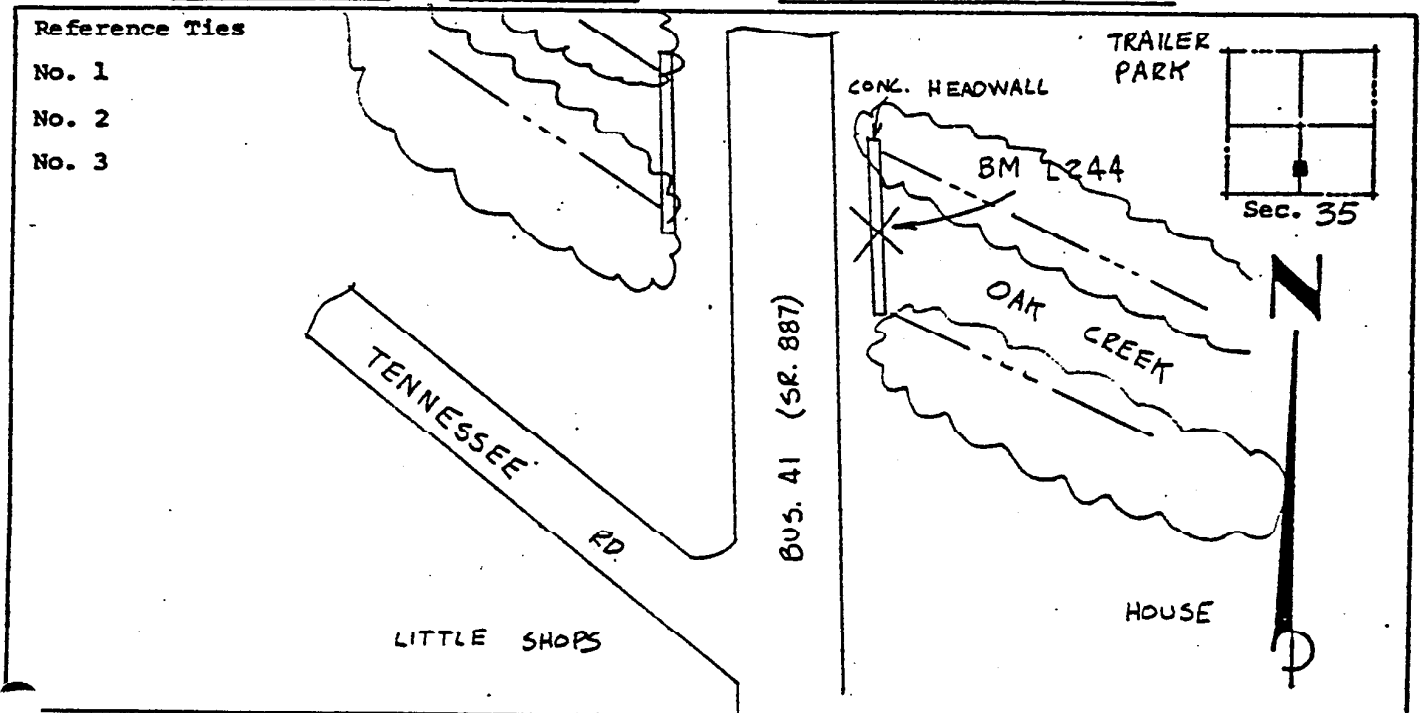

VERTICAL CONTROL originated on 1ST order control established by USC & GS

in 1966, on National Geodetic Survey Datum of 1929 datum. _____ agency

year _____
Elevation 8.077, 3rd Order Level Book V3 Page 17
(feet)