



**Deni Associates**  
 RT. 3, 11555 MARSHWOOD LN. S.W.  
 FORT MYERS, FL 33908

LEE COUNTY, FLORIDA  
 AERIAL MAPPING PROJECT

MAPPING BY  
 HAMRICK AERIAL SURVEYS, INC.  
 CLEARWATER, FLORIDA

DESIGNATION TBM SSMV-4 COUNTY LEE STATE FL

LOCATED IN SEC 30 TWP 47S RGE 26E USGS QUAD MAP CORKSCREW S.W.

TO REACH SURVEY MARK FROM INT. OF OLD US 41 & GOODWIN ST. IN BONITA SPRINGS:  
GO E. ON GOODWIN ST. 0.5 MI.± TO MATHESON AVE; THENCE N. 0.1 MI.± TO E.  
TERRY RD.; THENCE E. 1.25 MI.± TO MORTON AVE; THENCE N. 0.4 MI.± TO  
TOWER RD.; THENCE E. 0.7 MI.±; THENCE N. 0.4 MI.±; THENCE E. 0.15 MI.±;  
THENCE N. 0.25 MI.± TO MARK.

TYPE OF MARK EXISTING RR. SPIKE IN N. FACE OF 15" PINE DATE SET SEPT 19 82

HORIZONTAL CONTROL ORIGINATED ON \_\_\_\_\_ ORDER CONTROL ESTABLISHED BY \_\_\_\_\_  
 IN \_\_\_\_\_, ON \_\_\_\_\_

COORDINATES (FT) NORTH (Y) \_\_\_\_\_ EAST (X) \_\_\_\_\_  
 \_\_\_\_\_ ORDER STATE AND ZONE \_\_\_\_\_

REFERENCE BEARINGS TO STATION OR OBJECT

DESCRIPTION	BEARING	DISTANCE
_____	_____	_____
_____	_____	_____
_____	_____	_____

FIELD BOOK \_\_\_\_\_ PAGE \_\_\_\_\_ SKETCH BY B. R. HOMOLA

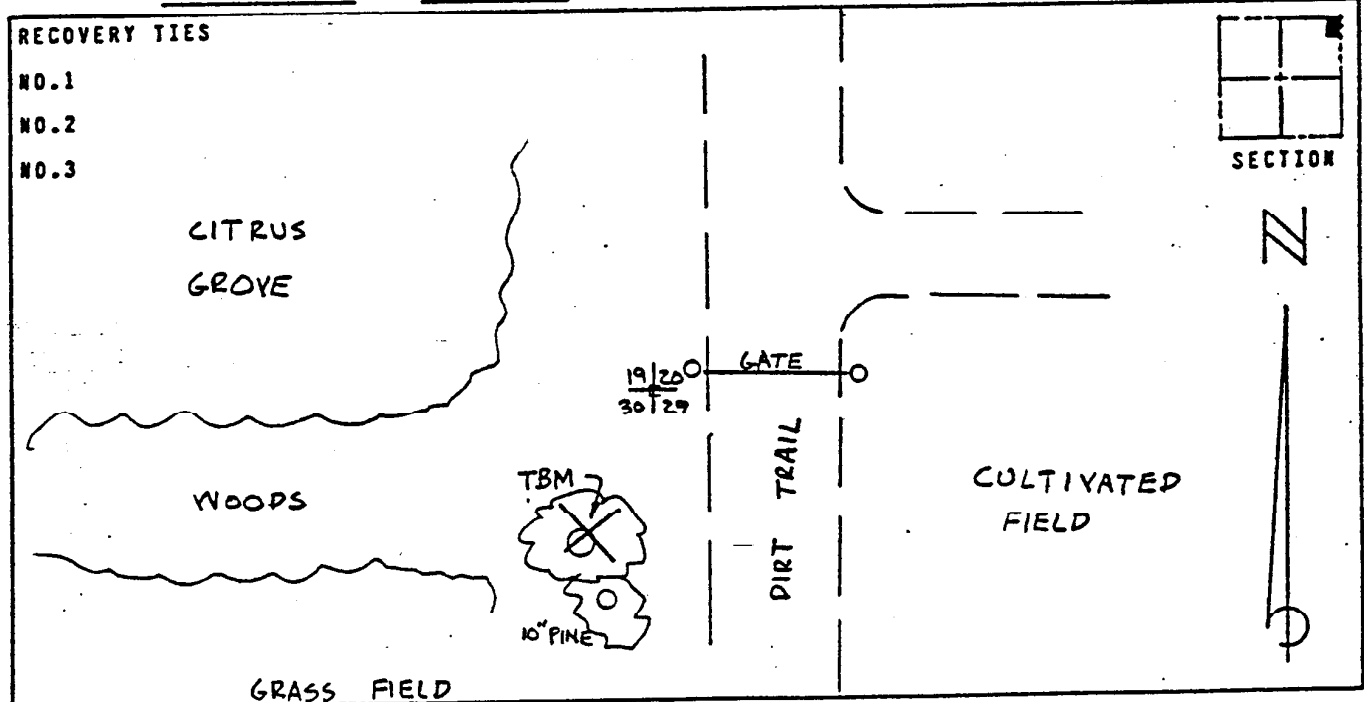

VERTICAL CONTROL ORIGINATED ON 1ST ORDER CONTROL ESTABLISHED BY USC & GS

IN 1966, ON NATIONAL GEODETIC VERTICAL DATUM 1929

ELEVATION (FT) 19.43, 3RD ORDER LEVEL BOOK V 10 PAGE 27