



# Deni Associates

7025 N.W. 4th St. • Plantation, Florida 33317

## LEE COUNTY, FLORIDA AERIAL MAPPING PROJECT

MAPPING BY  
HAMRICK AERIAL SURVEYS, INC.  
CLEARWATER, FLORIDA

Marker Designation USC & GS BM M 216 County LEE State FL

Located in Sec. 31 Twp. 47 S. Rge. 25 E. U.S.G.S. Quad Map BONITA SPRINGS 7.5min

To reach point from US. 41 & S.R. 865 - BONITA BEACH RD. IN BONITA SPRINGS  
GO W. ON S.R. 865 3.45 MI = TO BM.

Type of Marker STD. DISC IN 6" PIPE Date RECORDED AUGUST 19 80

HORIZONTAL CONTROL originated on 2nd order control established by FLA. D. O. T.

in year, on North American 1927 datum. agency

Coordinates: North (y) \_\_\_\_\_ East (x) \_\_\_\_\_  
(feet)

3rd Order

State and Zone Florida, Mercator West

Reference Bearings to Station or Object:

Description	Bearing	Distance

Field Book \_\_\_\_\_ Page \_\_\_\_\_ Sketch by D. W. ALBERTSEN

Reference Ties

- No. 1
- No. 2
- No. 3

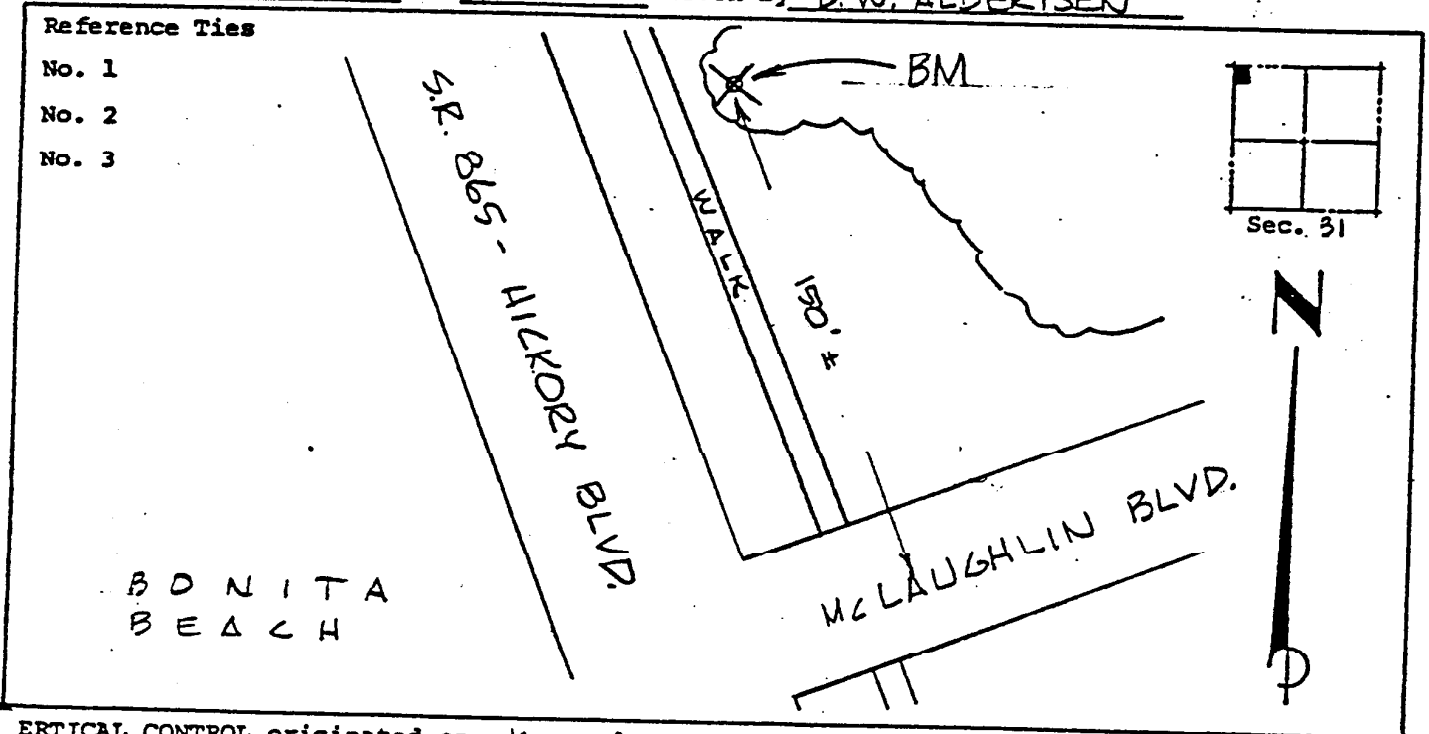

VERTICAL CONTROL originated on 1st order control established by USC & GS

in 1966, on National Geodetic Survey Datum of 1929 datum. agency

Elevation 3.760, 3rd Order Level Book \_\_\_\_\_ Page \_\_\_\_\_  
(feet)