

SURVEY MARK DESCRIPTION

**AGNOLI
BARBER &
BRUNDAGE, INC.**
Professional engineers, planners & land surveyors

NEW _____

RECOVERED _____

DESTROYED _____

NAME OR DESIGNATION WT 1 COUNTY Lee STATE FL

LOCATED IN SEC 28 TWP 47 S RGE 25 E USGS QUAD MAP Bonita Springs

TO REACH SURVEY MARK FROM WT 1 is located in the northeast quadrant of the intersection of U.S. 41 (S.R. 45) and West Terry Street in Bonita Springs

DESCRIPTION OF MARK 2" aluminum cap set in 12" dia poured-in-place concrete with No. 5 rebar, stamped "ABB Inc. WT-1" DATE SET 3/14/97

HORIZONTAL CONTROL ORIGINATED ON First Order ESTABLISHED BY NGS

CONTROL MONUMENTS UTILIZED I 75 81 A 10 & I 75 81 A 14

RECOVERED BY ABB DATE, CONDITION 3/27/97, Good

HORIZONTAL DATUM: NORTH AMERICAN DATUM OF 1983, 1990 ADJUSTMENT.

COORDINATES: Second ORDER, Class II

NORTHING (Y) 731976.633 (FT.) GRID Florida Transverse Mercator

EASTING (X) 719371.932 (FT.) ZONE West

FIELD BOOK _____ PAGE _____ SCALE FACTOR 0.99994576

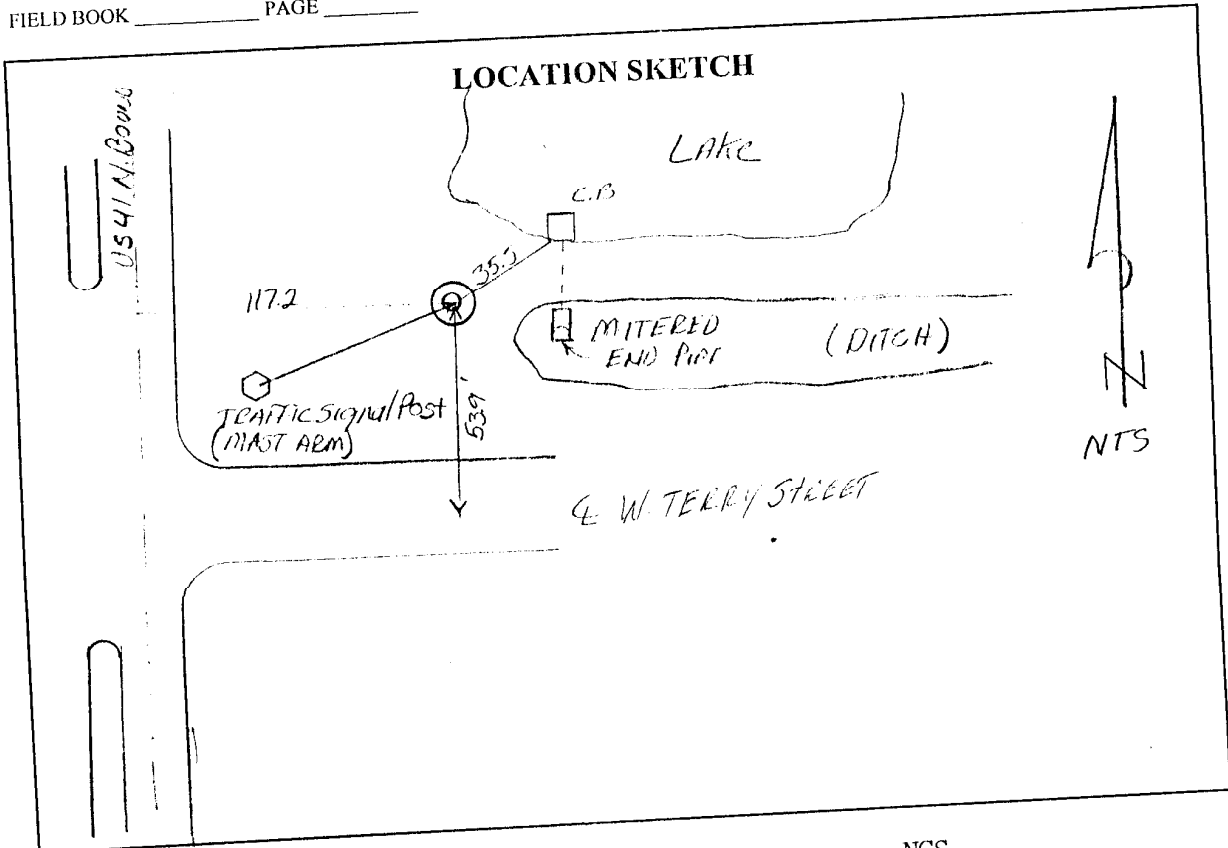

VERTICAL CONTROL ORIGINATED ON 1st-I ORDER CONTROL ESTABLISHED BY NGS

ELEVATION 10.214 (FT) = 3.113 (M), 3rd ORDER NGVD 1929 FIELD BOOK 702 PAGE 4

ELEVATION _____ (FT) = _____ (M), _____ ORDER NAVD 1988 CONTROL MONUMENTS T-244