



**Deni Associates**

7025 N.W. 4th St. • Plantation, Florida 33317

LEE COUNTY, FLORIDA  
AERIAL MAPPING PROJECT

MAPPING BY  
HAMRICK AERIAL SURVEYS, INC.  
CLEARWATER, FLORIDA

Marker Designation TBM FMBV-18 County LEE State FL  
Located in Sec. 27 Twp. 47S Rge. 25E U.S.G.S. Quad Map BONITA SPRINGS 7.5min.

To reach point from INT. OF US. BUS. 41 & SR. 865 IN BONITA SPRINGS. GO N. ON  
US. BUS. 41 1.0 MI. TO TERRY ST. SW. THENCE W. 1.5 MI. TO MARKER.

Type of Marker 8" SPIKE IN N. FACE OF P. POLE Date set JAN. 19 81

HORIZONTAL CONTROL originated on \_\_\_\_\_ order control established by \_\_\_\_\_  
in \_\_\_\_\_, on North American 1927 datum. agency \_\_\_\_\_  
year \_\_\_\_\_

Coordinates: North (y) \_\_\_\_\_ East (x) \_\_\_\_\_  
(feet) 3rd Order State and Zone Florida, Mercator West

Reference Bearings to Station or Object:

Description	Bearing	Distance

Field Book \_\_\_\_\_ Page \_\_\_\_\_ Sketch by B.R. HOMOLA

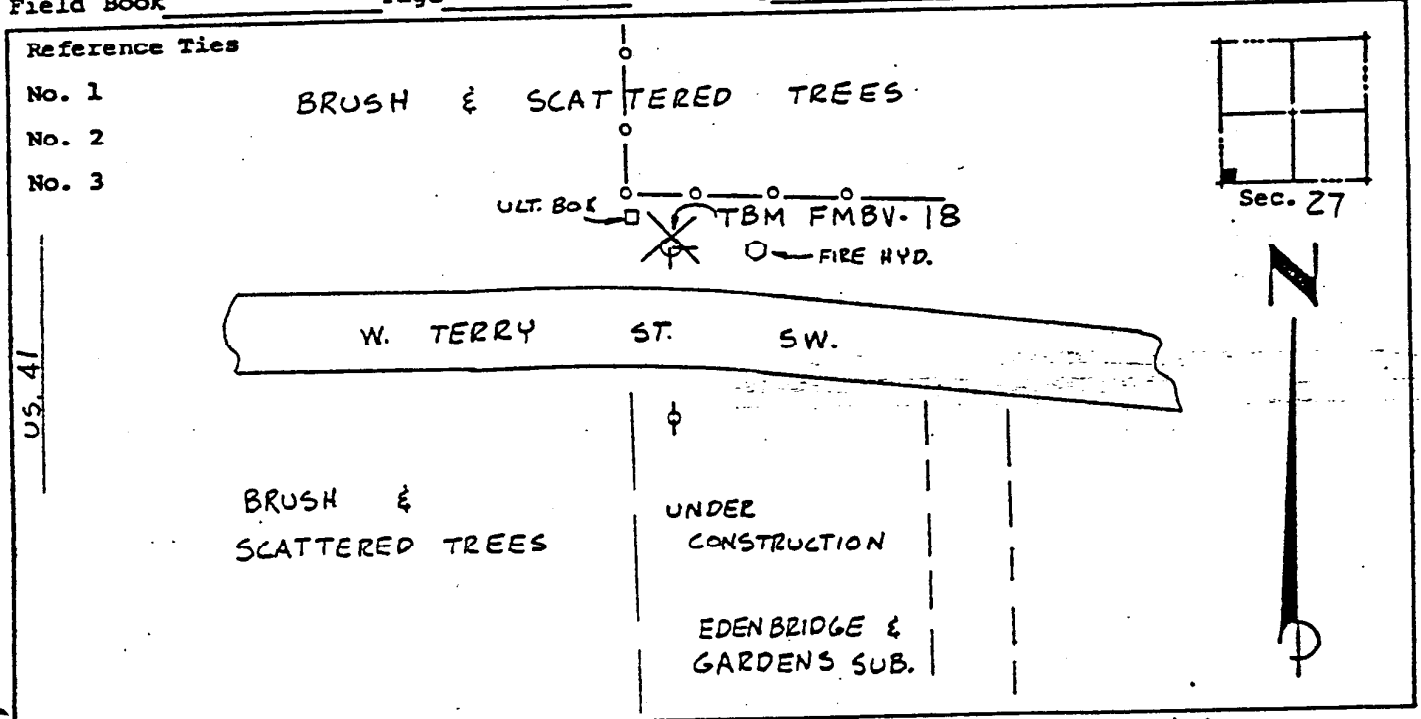

VERTICAL CONTROL originated on 1st order control established by USCGS agency \_\_\_\_\_  
in 1966, on National Geodetic Survey Datum of 1929 datum.

year \_\_\_\_\_  
Elevation 10.41, 3rd Order Level Book V2 Page 57  
(feet)