



Deni Associates

7025 N.W. 4th St. • Plantation, Florida 33317

LEE COUNTY, FLORIDA
AERIAL MAPPING PROJECT

MAPPING BY
HAMRICK AERIAL SURVEYS, INC.
CLEARWATER, FLORIDA

Marker Designation TBM FMBV-20 County LEE State FL

Located in Sec. 26 Twp. 47 S. Rge. 25 E. U.S.G.S. Quad Map BONITA SPRINGS 7.5min.

To reach point from OLD US 41 (SR 887 - IMPERIAL BLVD) BRIDGE
OVER THE IMPERIAL RIVER IN BONITA SPRINGS; GO N.
0.55 MI ± TO ROSEMARY DR; THENCE E. 0.5 MI ± TO
8TH ST.; THENCE N: 0.6 MI ± TO END OF TRAIL & TBM.

Type of Marker CHISELED "X" ON WEIR GATE FRAME Date set JAN 1981
ON ZMP ZULV.

HORIZONTAL CONTROL originated on _____ order control established by _____
in _____, on _____ North American 1927 _____ datum. _____ agency

Coordinates: North (y) _____ East (x) _____
(feet)

3rd Order State and Zone Florida, Mercator West

Reference Bearings to Station or Object:

Description	Bearing	Distance

Field Book _____ Page _____ Sketch by D.W. ALBERTSEN

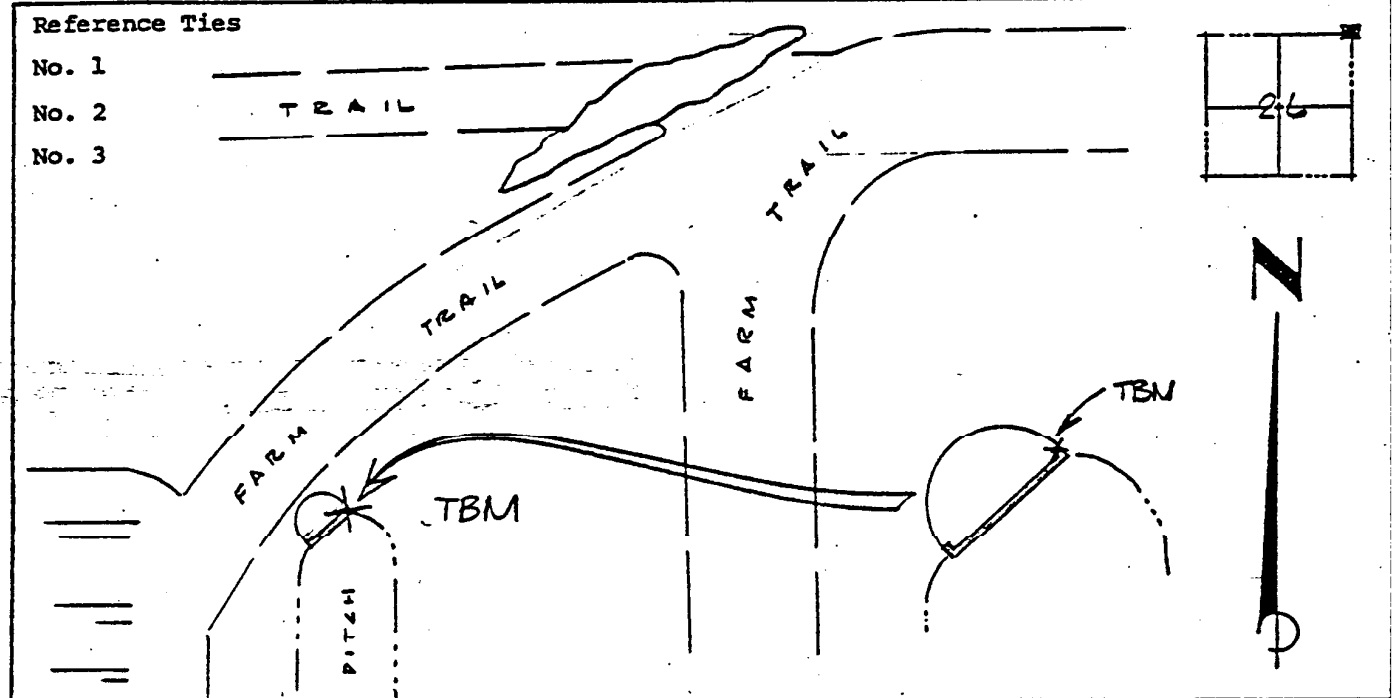

VERTICAL CONTROL originated on 1st order control established by USC & GS
agency

in 1966, on _____ National Geodetic Survey Datum of 1929 _____ datum.

Elevation 14.86, 3rd Order Level Book V3 Page 29
(feet)