



Deni Associates
 RT. 3, 11555 MARSHWOOD LN. S.W.
 FORT MYERS, FL 33908

LEE COUNTY, FLORIDA
 AERIAL MAPPING PROJECT

MAPPING BY
 HAMRICK AERIAL SURVEYS, INC.
 CLEARWATER, FLORIDA

DESIGNATION TBM SFMV-60 COUNTY LEE STATE FL.

LOCATED IN SEC 11 TWP 47S RGE 29E²⁵ USGS QUAD MAP ESTERO

TO REACH SURVEY MARK FROM INT. OF US. 41 & CORKSCREW RD. IN ESTERO: GO E. ON CORKSCREW RD. 2.0 MI. ± TO I-75; THENCE S. 1.8 MI. ± TO MARK.

TYPE OF MARK EXISTING DAT SURVEY DISC. DATE SET MAY 19 82

HORIZONTAL CONTROL ORIGINATED ON _____ ORDER CONTROL ESTABLISHED BY _____

IN _____, ON _____.

COORDINATES (FT) NORTH (Y) _____ EAST (X) _____

_____ ORDER STATE AND ZONE _____

REFERENCE BEARINGS TO STATION OR OBJECT

DESCRIPTION	BEARING	DISTANCE
_____	_____	_____
_____	_____	_____
_____	_____	_____

FIELD BOOK _____ PAGE _____ SKETCH BY E.S. ELLER

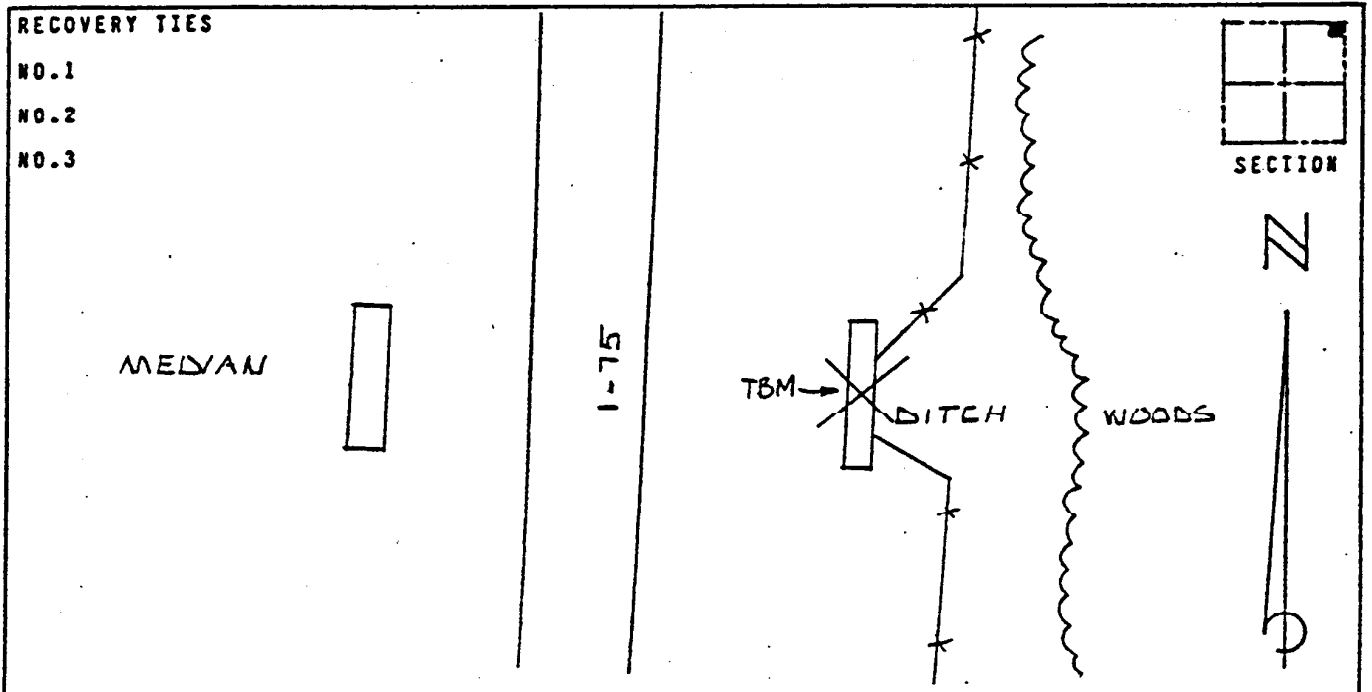

VERTICAL CONTROL ORIGINATED ON 1ST. ORDER CONTROL ESTABLISHED BY USC & GS

IN 1966, ON NATIONAL GEODETIC VERTICAL DATUM 1929.

ELEVATION (FT) 18.30, 3RD ORDER LEVEL BOOK V9 PAGE 31