



Deni Associates
 RT. 3, 11535 MARSHWOOD LN. S.W.
 FORT MYERS, FL 33908

LEE COUNTY, FLORIDA
 AERIAL MAPPING PROJECT

MAPPING BY
 HAMRICK AERIAL SURVEYS, INC.
 CLEARWATER, FLORIDA

DESIGNATION TBM - SFMV-62 COUNTY LEE STATE FL

LOCATED IN SEC 10TH 15TH TWP 47S RGE 25E USGS QUAD MAP ESTERD, FLA.

TO REACH SURVEY MARK FROM INT. OF US. 41 & CORKSCREW RD IN ESTERD: GO 1.0 MI ± E. TO
DIRT RD.; THENCE S. 0.4 MI ± TO DIRT RD.; THENCE 0.4 MI ± E.; THENCE S. 2.4 MI ±
TO MARK.

TYPE OF MARK 2" SPIKE IN E. FACE 8" PINE TREE DATE SET MAY 19 82

HORIZONTAL CONTROL ORIGINATED ON _____ ORDER CONTROL ESTABLISHED BY _____
 IN _____, ON _____

COORDINATES (FT) NORTH (Y) _____ EAST (X) _____
 _____ ORDER STATE AND ZONE _____

REFERENCE BEARINGS TO STATION OR OBJECT

DESCRIPTION	BEARING	DISTANCE

FIELD BOOK _____ PAGE _____ SKETCH BY C.L.B.

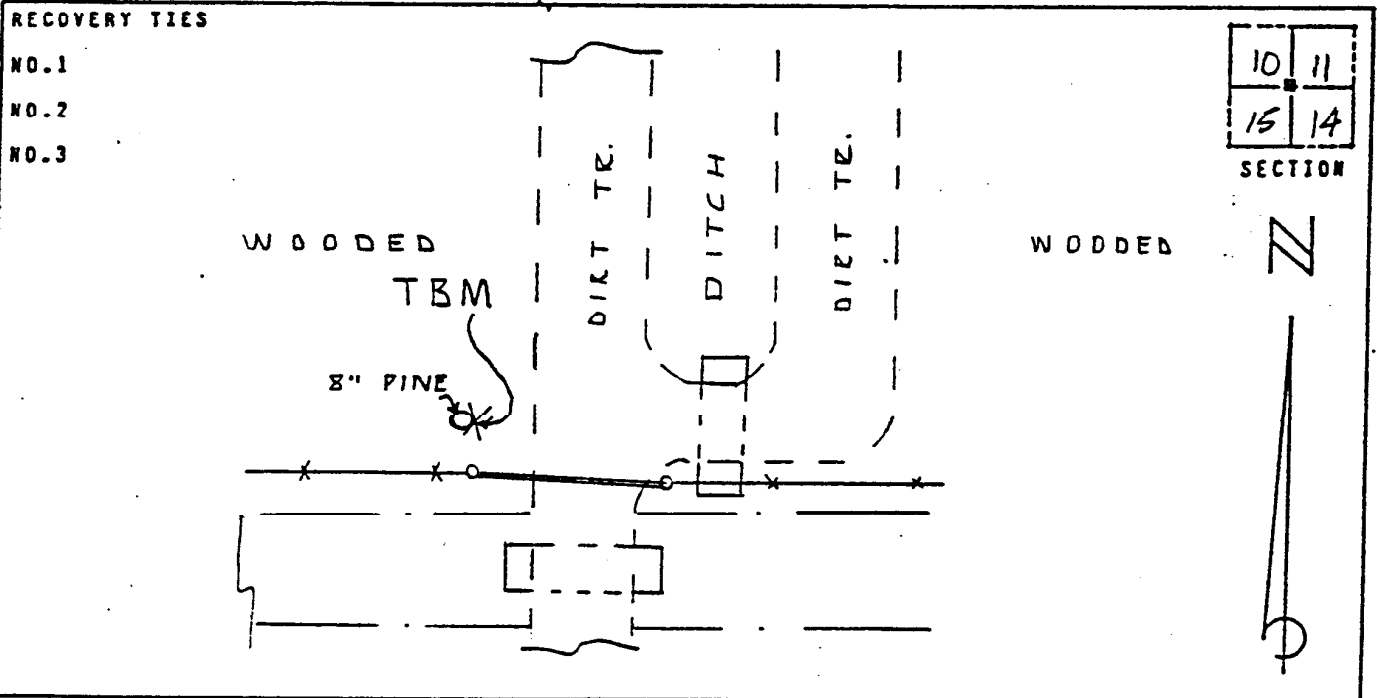

VERTICAL CONTROL ORIGINATED ON 1ST ORDER CONTROL ESTABLISHED BY USC & GS
 IN 1966, ON NATIONAL GEODETIC VERTICAL DATUM 1929

ELEVATION (FT) 17.48, 3RD ORDER LEVEL BOOK V8 PAGE 41