



Deni Associates

7025 N.W. 4th St. • Plantation, Florida 33317

LEE COUNTY, FLORIDA
AERIAL MAPPING PROJECT

MAPPING BY
HAMRICK AERIAL SURVEYS, INC.
CLEARWATER, FLORIDA

Marker Designation TBM FMBV-27 County LEE State FL
Located in Sec. 16 15 Twp. 47S Rge. 25E U.S.G.S. Quad Map ESTERO 7.5min.

To reach point from INT. OF US. 41 & CORKSCREW RD. IN ESTERO GO. E. ON
CORKSCREW RD. 0.35 MI.± TO DIRT RD. S. THENCE S. 0.75 MI.± TO
END OF RD. @ STEEL GATE. THENCE S. ALONG SCL. RR. 2.0 MI.±.
TO JUNK YARD & MARKER.

Type of Marker TOP OF BOLT HOLDING BRASS CAP IN CONG. POST Date set JAN. 19 81

HORIZONTAL CONTROL originated on _____ order control established by _____
in _____, on North American 1927 datum. _____ agency

Coordinates: North (y) _____ East (x) _____
(feet)

3rd Order

State and Zone Florida, Mercator West

Reference Bearings to Station or Object:

Description	Bearing	Distance

Field Book _____ Page _____ Sketch by B.R. HOMOLA

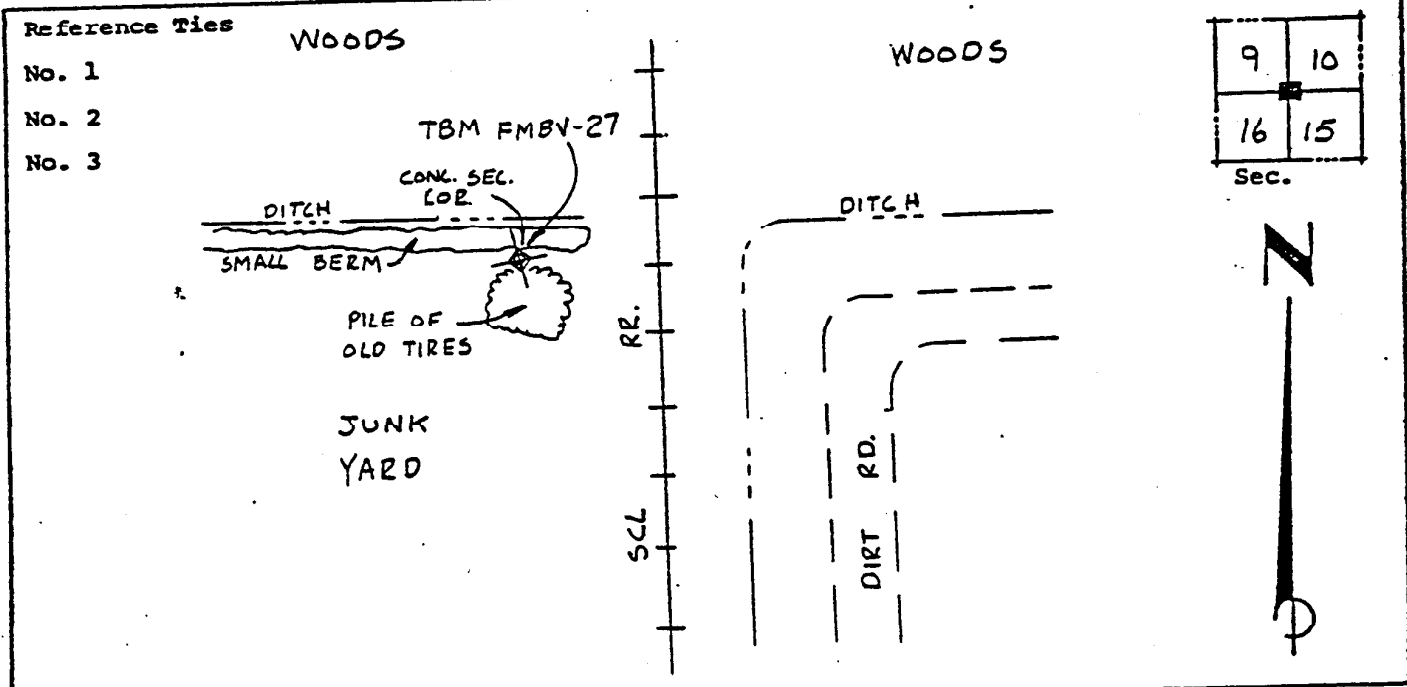

VERTICAL CONTROL originated on 1st order control established by USC&GS agency

in 1966, on National Geodetic Survey Datum of 1929 datum.

Elevation 15.87, 3rd Order Level Book V2 Page 62
(feet)