



Deni Associates

7025 N.W. 4th St. • Plantation, Florida 33317

LEE COUNTY, FLORIDA
AERIAL MAPPING PROJECT

MAPPING BY
HAMRICK AERIAL SURVEYS, INC.
CLEARWATER, FLORIDA

Marker Designation USC & GS BM E 248 County LEE State FL
Located in Sec. 13 Twp. 47S Rge. 24 E U.S.G.S. Quad Map ESTERO 7.5min.

To reach point from U.S. 41 & SR 865 - BONITA BEACH RD IN BONITA SPRINGS
EO W. ON SR. 865 5.8 MI ± TO BM.

Type of Marker STD. DISC ON LONG WHEEL GUARD Date ^{Recovered} AUG. 19 80

HORIZONTAL CONTROL originated on _____ order control established by _____ agency
in _____, on North American 1927 datum.

Coordinates: North (y) _____ East (x) _____
(feet) 3rd Order State and Zone Florida, Mercator West

Reference Bearings to Station or Object:

Description	Bearing	Distance

Field Book _____ Page _____ Sketch by D.W. ALBERTSEN

Reference Ties

- No. 1
- No. 2
- No. 3

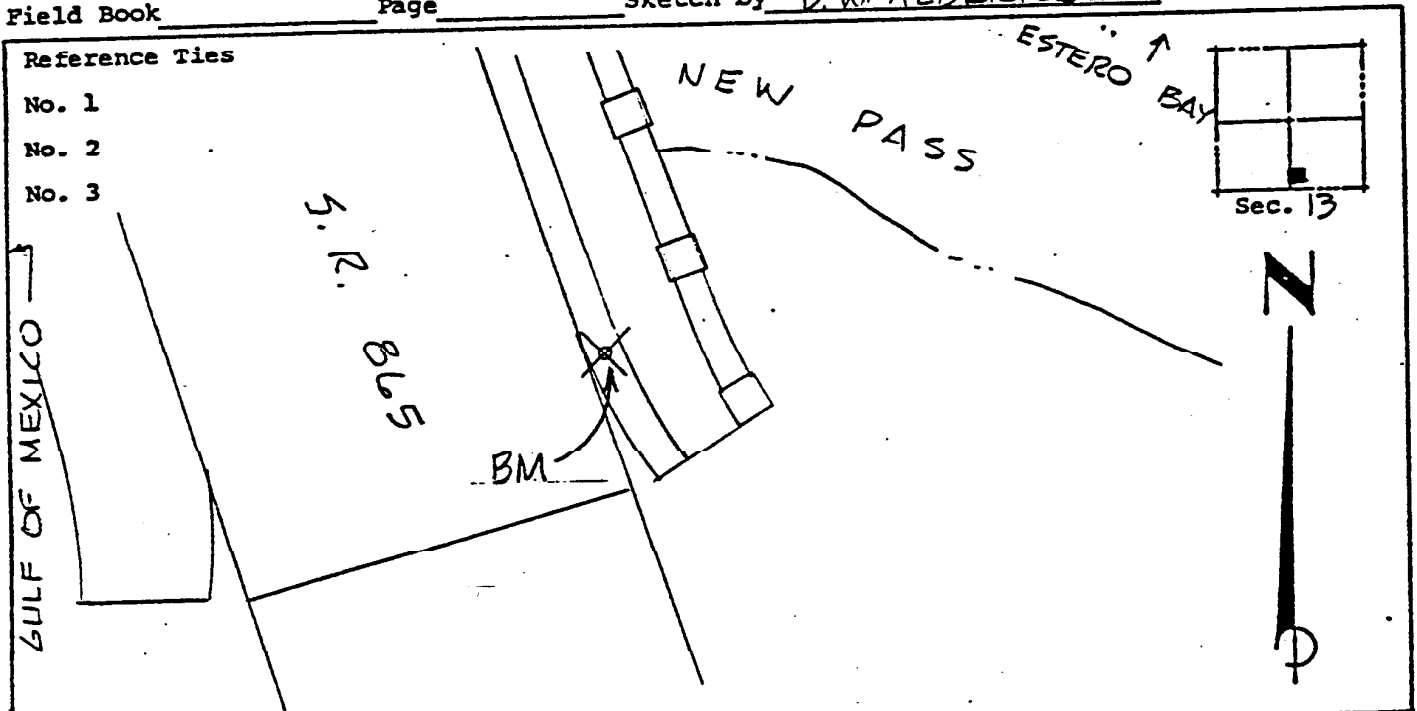

VERTICAL CONTROL originated on 1st order control established by USC & GS agency
in 1966, on National Geodetic Survey Datum of 1929 datum.

Elevation 23.31, 3rd Order Level Book VI Page 37
(feet)