



Deni Associates
 RT. 3, 11335 MARSHWOOD LN. E.W.
 FORT MYERS, FL 33908

LEE COUNTY, FLORIDA
 AERIAL MAPPING PROJECT

MAPPING BY
 HAMRICK AERIAL SURVEYS, INC.
 CLEARWATER, FLORIDA

DESIGNATION TBM SFMV - 29 COUNTY LEE STATE FL

LOCATED IN SEC B TWP 46S RGE 25E USGS QUAD MAP ESTERO

TO REACH SURVEY MARK FROM INTERSECTION OF ALICO RD & US RT4: GO E. 1.04 MI.
TO JEAN RD.; THENCE SOUTH 0.2 MI TO MARK.

TYPE OF MARK RR SPIKE IN W. FACE OF POWER POLE DATE SET FEB. 1982

HORIZONTAL CONTROL ORIGINATED ON _____ ORDER CONTROL ESTABLISHED BY _____
 IN _____, ON _____

COORDINATES (FT) NORTH (Y) _____ EAST (X) _____
 _____ ORDER STATE AND ZONE _____

REFERENCE BEARINGS TO STATION OR OBJECT

| DESCRIPTION | BEARING | DISTANCE |
|-------------|---------|----------|
| | | |
| | | |
| | | |

FIELD BOOK _____ PAGE _____ SKETCH BY KET

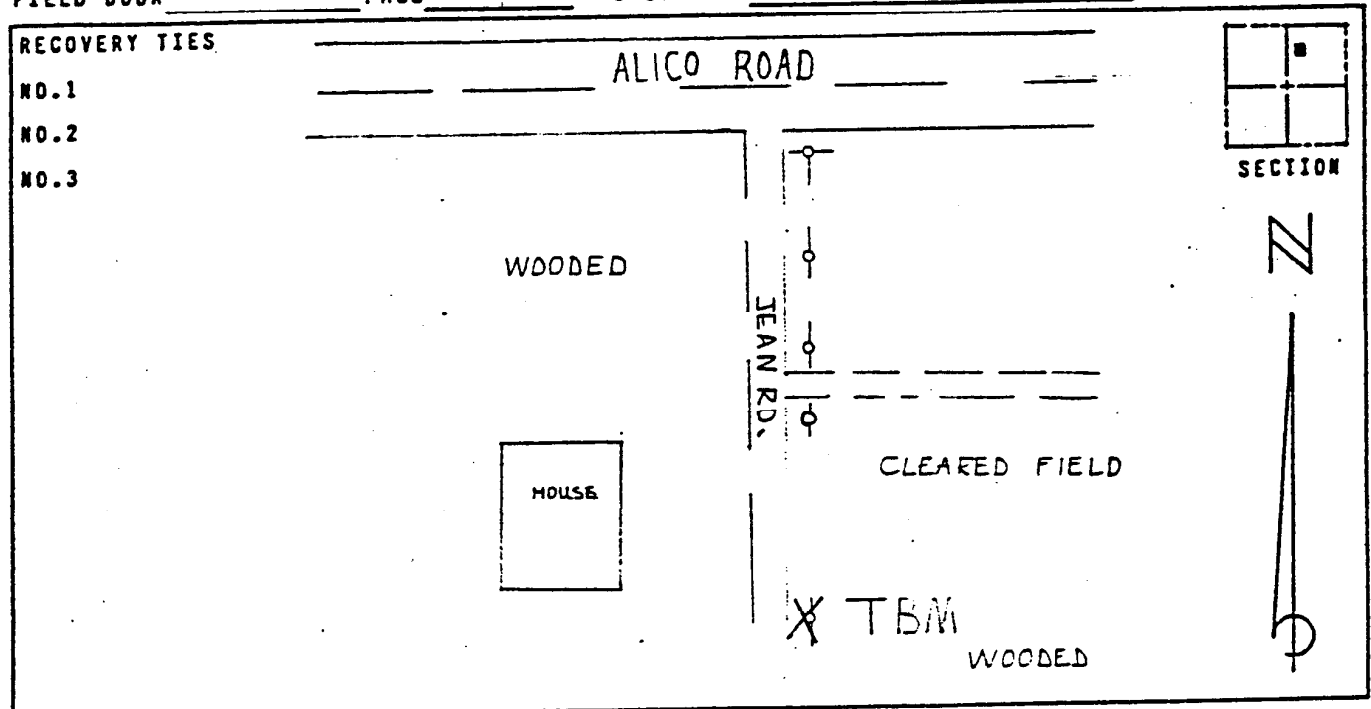

VERTICAL CONTROL ORIGINATED ON 1ST ORDER CONTROL ESTABLISHED BY USC & GS
 IN 1966, ON NATIONAL GEODETIC VERTICAL DATUM 1929

ELEVATION (FT) 15.16, 3RD ORDER LEVEL BOOK VB PAGE 24