

LEE COUNTY, FLORIDA  
AERIAL MAPPING PROJECT



*Deni Associates*  
RT. 3, 11555 MARSHWOOD LN. S.W.  
FORT MYERS, FL 33908

MAPPING BY  
HAMRICK AERIAL SURVEYS, INC.  
CLEARWATER, FLORIDA

DESIGNATION TBM SFMV - 30 COUNTY LEE STATE FL  
LOCATED IN SEC 5 TWP 46S RGE 25E USGS QUAD MAP ESTERO FL

TO REACH SURVEY MARK FROM U.S. 41 E ALICO RD.: GO E 0.4 MI ± TO GRAVEL RD. LEADING N. TO POWERLINES, 300' ± E. OF JEAN ST.; THENCE CONT. N. 1.0 MI ± TO MARK.

TYPE OF MARK 8" SPIKE IN W. FACE OF FENCE COR. DATE SET FEB. 19 82

HORIZONTAL CONTROL ORIGINATED ON \_\_\_\_\_ ORDER CONTROL ESTABLISHED BY \_\_\_\_\_  
IN \_\_\_\_\_, ON \_\_\_\_\_

COORDINATES (FT) NORTH (Y) \_\_\_\_\_ EAST (X) \_\_\_\_\_  
\_\_\_\_\_ ORDER STATE AND ZONE \_\_\_\_\_

REFERENCE BEARINGS TO STATION OR OBJECT  
DESCRIPTION

BEARING

DISTANCE

DESCRIPTION	BEARING	DISTANCE
_____	_____	_____
_____	_____	_____
_____	_____	_____

FIELD BOOK \_\_\_\_\_ PAGE \_\_\_\_\_ SKETCH BY C.L.B.

RECOVERY TIES

- NO. 1
- NO. 2
- NO. 3

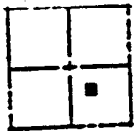

SECTION

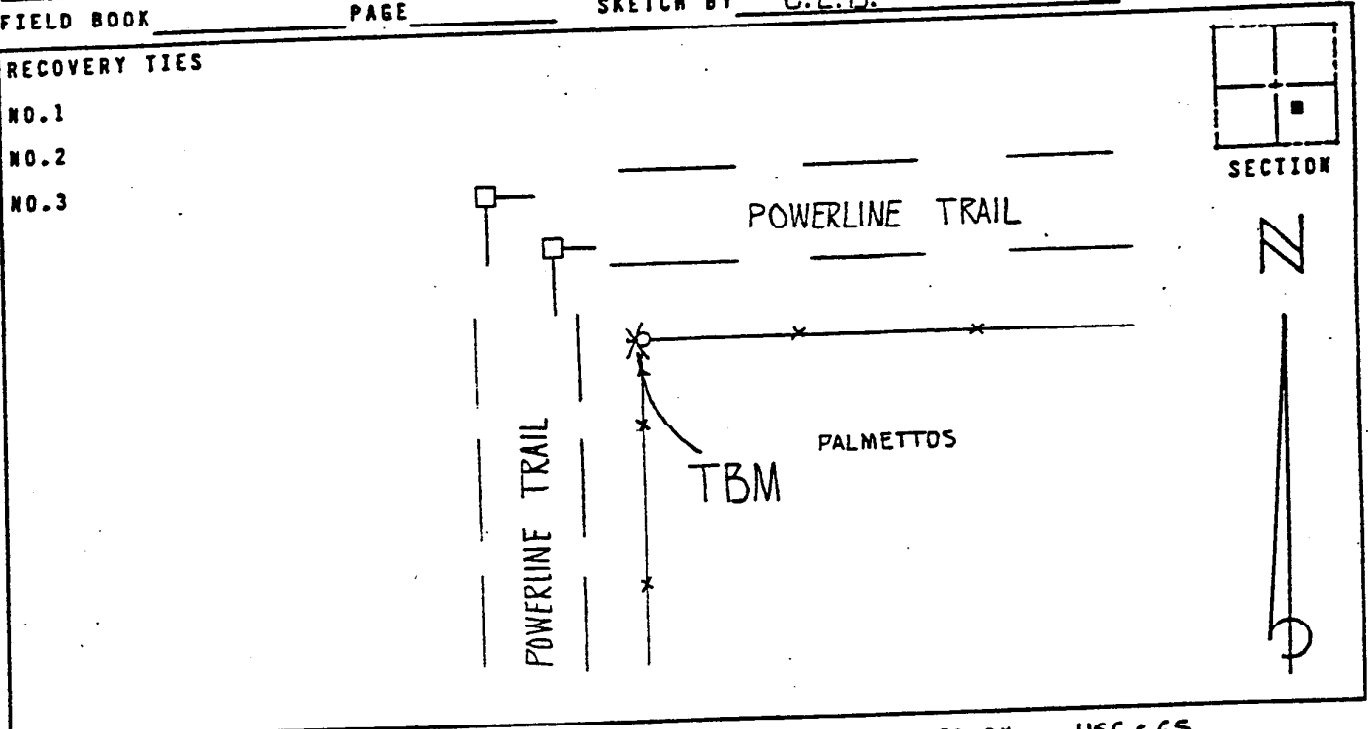

VERTICAL CONTROL ORIGINATED ON 1ST ORDER CONTROL ESTABLISHED BY USC & GS

IN 1966 ON NATIONAL GEODETIC VERTICAL DATUM 1929

ELEVATION (FT) 15.73 3RD ORDER LEVEL BOOK V-9 PAGE 7