



Deni Associates

7025 N.W. 4th St. - Plantation, Florida 33317

LEE COUNTY, FLORIDA
AERIAL MAPPING PROJECT

MAPPING BY
HAMRICK AERIAL SURVEYS, INC.
CLEARWATER, FLORIDA

Marker Designation BM F245 RE 1970 (USC & GS) County LEE State FL

Located in Sec. 19 Twp. 46S Rge. 24E U.S.G.S. Quad Map FORT MYERS BEACH 7.5min.

To reach point from _____
MARKER IN LIBRARY WALL ON ESTERO ISLAND

Type of Marker BRASS CAP SET VERTICAL IN WALL Date set AUGUST 19 80

HORIZONTAL CONTROL originated on 2nd order control established by FLA. D. O. T. agency

in _____, on North American 1927 datum.

Coordinates: North (y) _____ East (x) _____
(feet)

3rd Order State and Zone Florida, Mercator West

Reference Bearings to Station or Object:

| Description | Bearing | Distance |
|-------------|---------|----------|
| | | |
| | | |

Field Book _____ Page _____ Sketch by B.R. HOMOLA

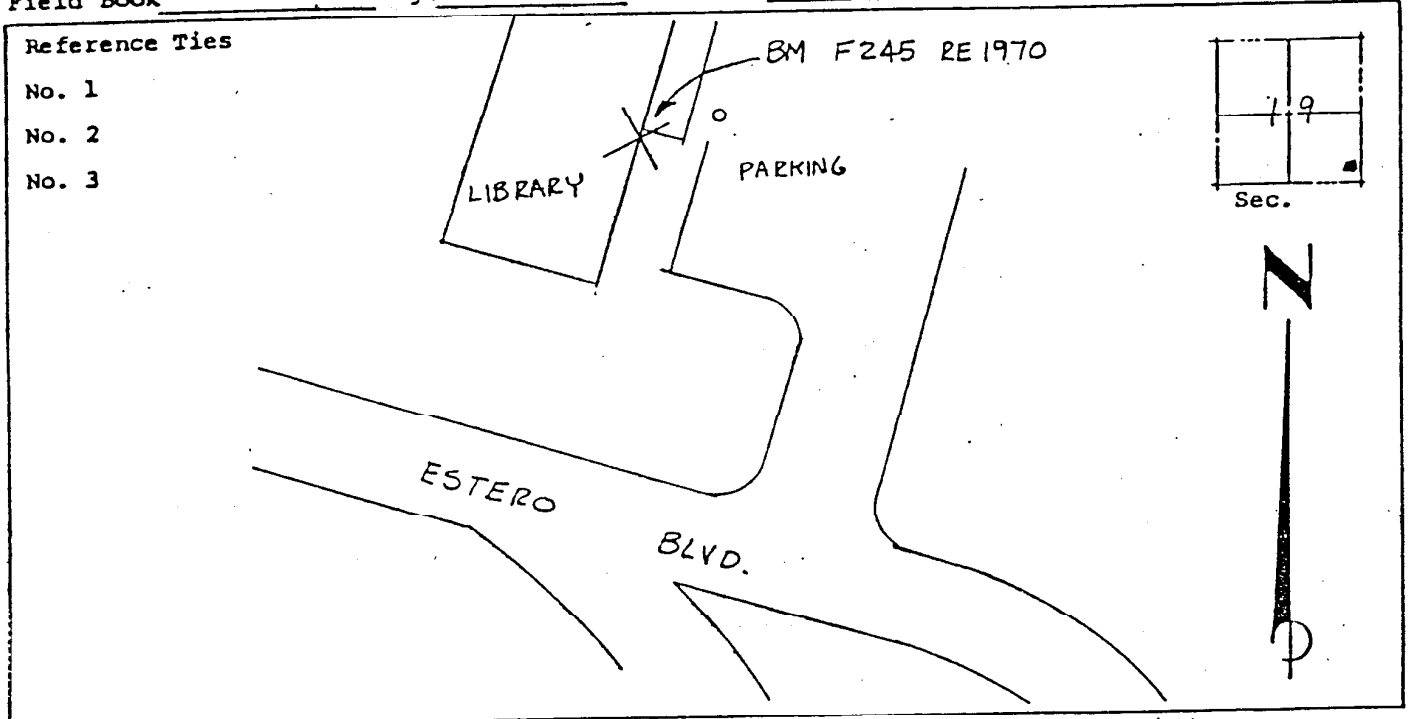

VERTICAL CONTROL originated on 1st order control established by USC & GS agency

in 1966, on National Geodetic Survey Datum of 1929 datum.

year 1966 elevation 07.516 3rd Order Level Book V2 Page 36
07 516 USC & GS