



7025 N.W. 4th St. - Plantation, Florida 33317

MAPPING BY
HAMRICK AERIAL SURVEYS, INC.
CLEARWATER, FLORIDA

Marker Designation TBM SV-54 County LEE State FL

Located in Sec. 34 Twp. 43 S. Rge. 24 E. U.S.G.S. Quad Map FT. MYERS NW 7.5min

To reach point from JCT. OF S.R. 78 / BAYSHORE RD. & U.S. 41 /
CLEVELAND AV. 60 N. 0.8 MI ± TO TBM

Type of Marker SRD DISC ON CONCL. HDWL. Date set NOV. - DEC. 19 80

HORIZONTAL CONTROL originated on _____ order control established by _____ agency
in _____, on _____ North American 1927 _____ datum.

Coordinates: North (y) _____ East (x) _____
(feet) _____
3rd Order State and Zone Florida, Mercator West

Reference Bearings to Station or Object:

Description	Bearing	Distance

Field Book 1 Page _____ Sketch by D.W. ALBERTSEN

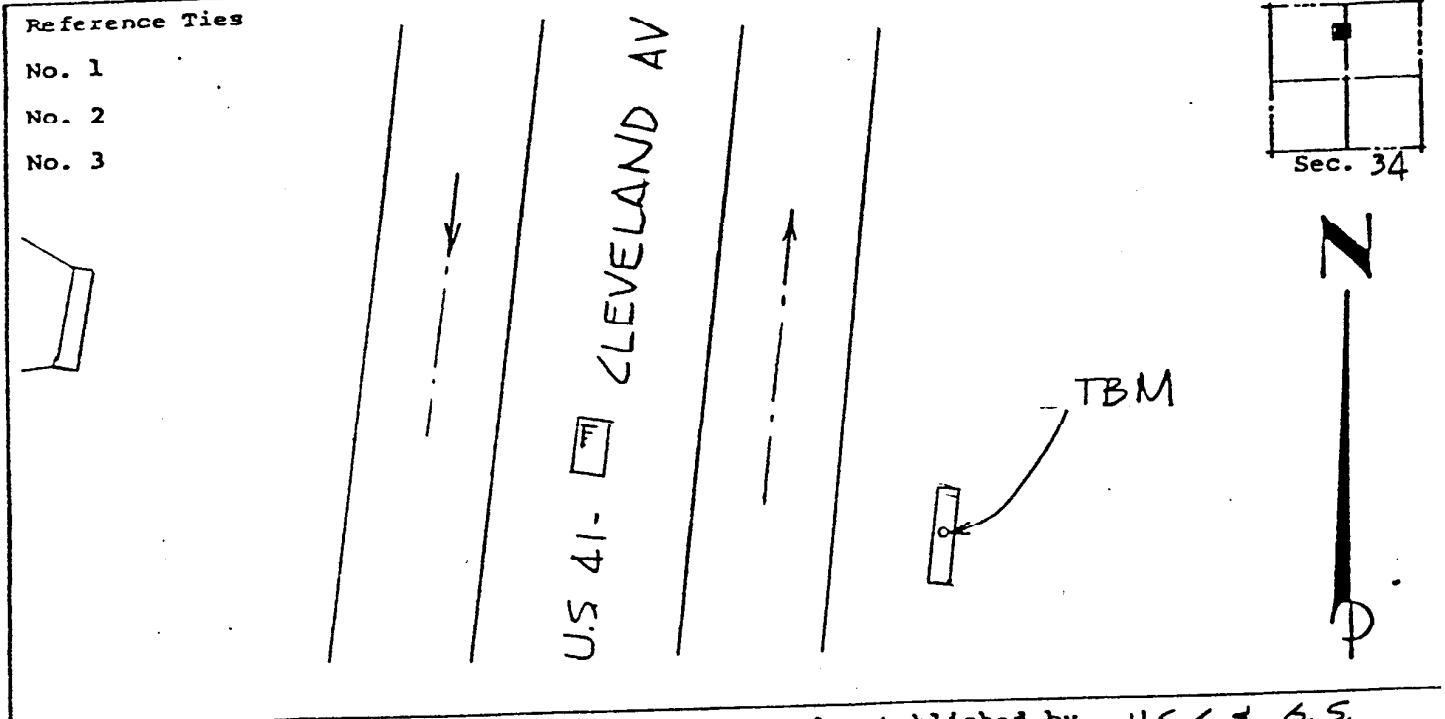

VERTICAL CONTROL originated on 1st order control established by U.S.C. & G.S. agency
in 1966, on National Geodetic Survey Datum of 1929 datum.

Elevation 14.40, 3rd Order Level Book 3 Page 41