



Deni Associates
 RT. 3, 11955 MARSHWOOD LN. S.W.
 FORT MYERS, FL 33908

X

LEE COUNTY, FLORIDA
 AERIAL MAPPING PROJECT

MAPPING BY
 HAMRICK AERIAL SURVEYS, INC.
 CLEARWATER, FLORIDA

DESIGNATION TBM SFMV-5 COUNTY LEE STATE FL

LOCATED IN SEC 5 TWP 46 S. RGE 24 E USGS QUAD MAP FORT MYERS SW.

TO REACH SURVEY MARK FROM INT. OF MCGREGOR BLVD. & GLADIOLUS DR. IN SW. FORT MYERS: GO E. OF GLADIOLUS DR. 0.5 MI. ± TO PINE RIDGE RD.; THENCE S. 1.1 MI. ± TO MARK.

TYPE OF MARK CHISELED "I" END OF CONCL. CULVERT PIPE DATE SET DEC. 19 81

HORIZONTAL CONTROL ORIGINATED ON _____ ORDER CONTROL ESTABLISHED BY _____ IN _____, ON _____

COORDINATES (FT) NORTH (Y) _____ EAST (X) _____

_____ ORDER STATE AND ZONE _____

REFERENCE BEARINGS TO STATION OR OBJECT

DESCRIPTION	BEARING	DISTANCE
_____	_____	_____
_____	_____	_____
_____	_____	_____

FIELD BOOK _____ PAGE _____ SKETCH BY B. R. HOMOLA

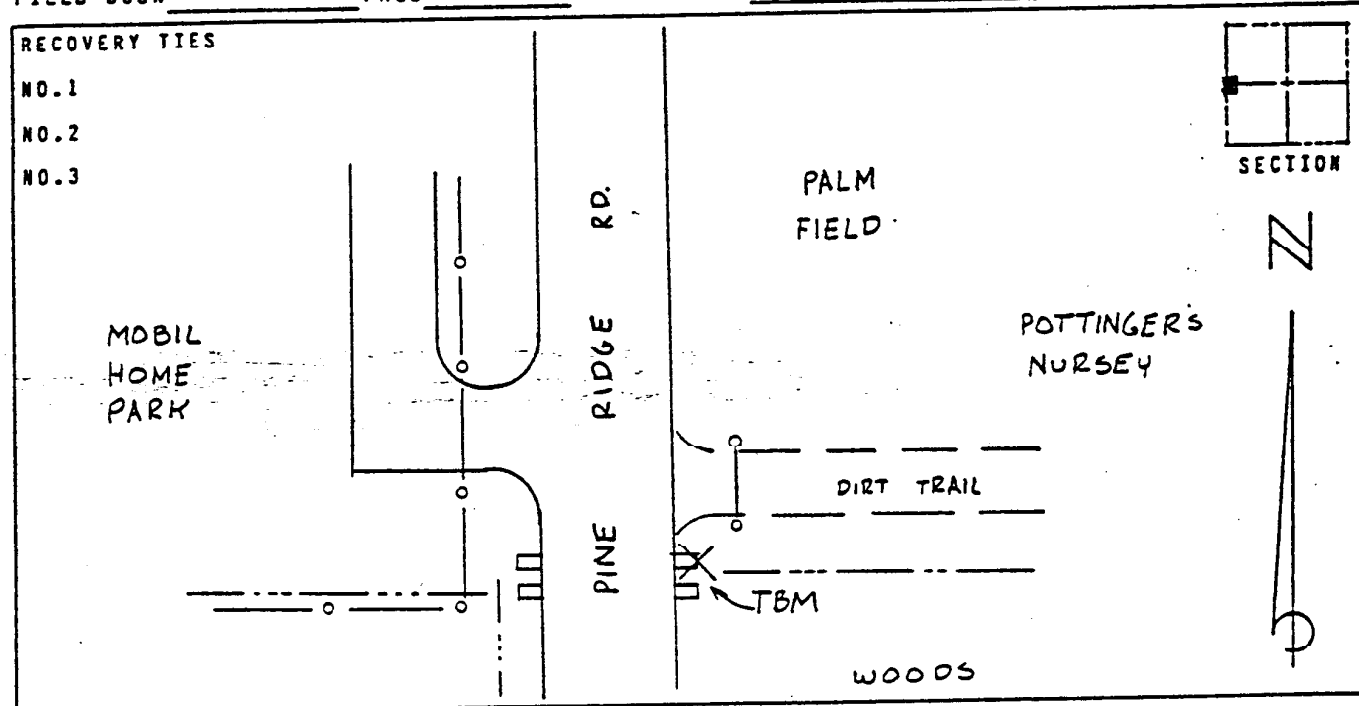

VERTICAL CONTROL ORIGINATED ON 1ST ORDER CONTROL ESTABLISHED BY USC&GS

IN 1966, ON NATIONAL GEODETIC VERTICAL DATUM 1929.

ELEVATION (FT) 05.44, 3RD ORDER LEVEL BOOK V5 PAGE 72