



# Deni Associates

7025 N.W. 4th St. • Plantation, Florida 33317

## AERIAL MAPPING PROJECT

MAPPING BY  
HAMRICK AERIAL SURVEYS, INC.  
CLEARWATER, FLORIDA

Marker Designation BM L240 (USC&GS) County LEE State FL  
Located in Sec. 10 Twp. 46S Rge. 23E, U.S.G.S. Quad Map FORT MYERS BEACH 7.5mir

To reach point from TOLL BOOTH AT THE NE. END OF THE SANIBEL CAUSEWAY.  
GO E. ON SR. 867 0.6 MI ± TO MARKER ON RIGHT.

Type of Marker BRASS CAP SET IN CONC. Date set AUGUST 19 80

HORIZONTAL CONTROL originated on 2nd order control established by FIA. D. O. T.  
in year, on North American 1927 datum. agency

Coordinates: North (y) \_\_\_\_\_ East (x) \_\_\_\_\_  
(feet) 3rd Order State and Zone Florida, Mercator West

Reference Bearings to Station or Object:

Description	Bearing	Distance

Field Book \_\_\_\_\_ Page \_\_\_\_\_ Sketch by B. R. HOMOLA

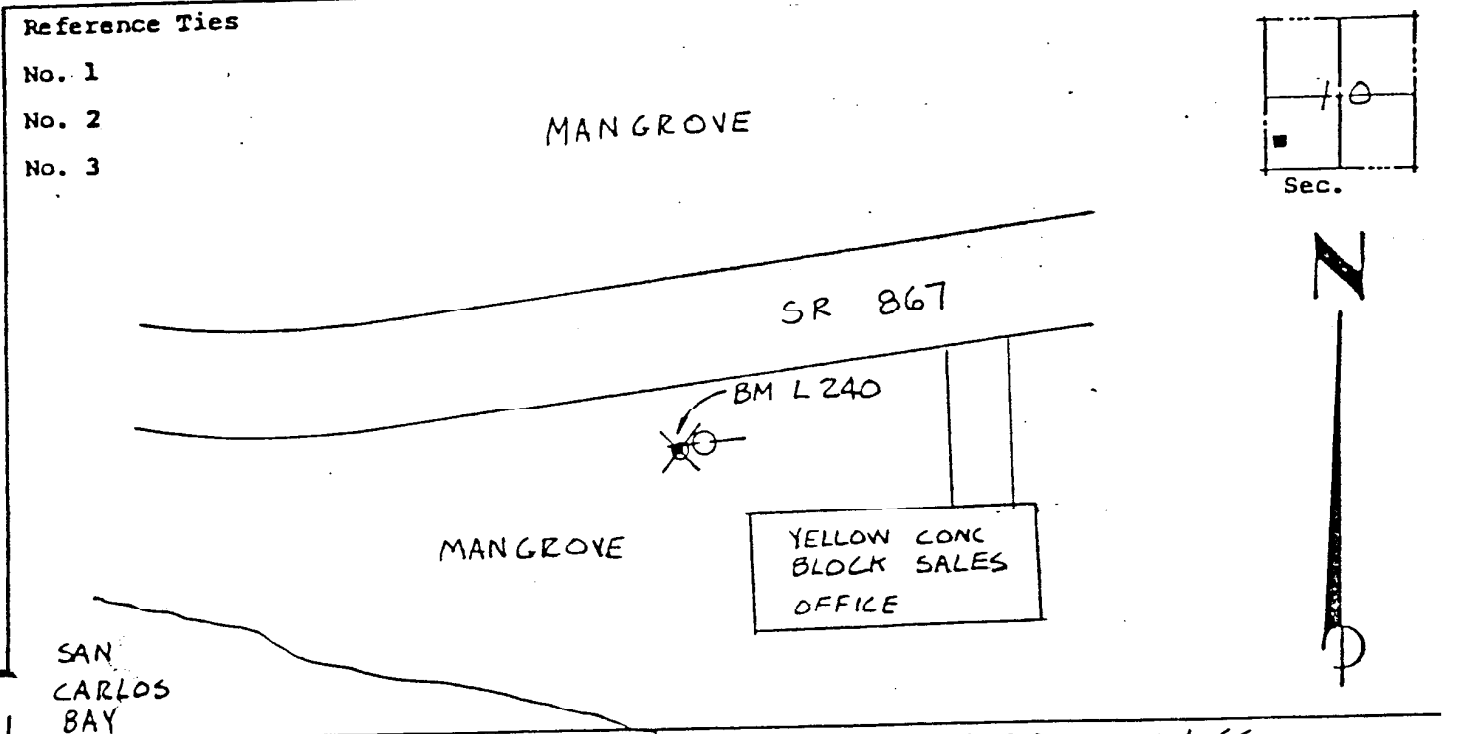

VERTICAL CONTROL originated on 1<sup>st</sup> order control established by USC&GS agency

in 1966, on National Geodetic Survey Datum of 1929 datum.  
year  
Elevation 03.953, 3rd Order Level Book V2 Page 24