



Demi Associates

7025 N.W. 4th St. • Plantation, Florida 33317

LEE COUNTY, FLORIDA
AERIAL MAPPING PROJ.

MAPPING BY
HAMRICK AERIAL SURVEYS, II
CLEARWATER, FLORIDA

Marker Designation TBM FMBV-31 County LEE State FL
Located in Sec. 33/34 Twp. 46 S. Rge. 25 E. U.S.G.S. Quad Map ESTERO 7.5'

To reach point from INT. OF US 41 & CORKSCREW RD. IN ESTERO. GO E. ON CORKSCREW RD. 0.35 MI.± TO DIRT RD S. THENCE S. 0.75 MI.± TO END OF RD. & STEEL GATE & MARKER.

Type of Marker TOP OF CONG. SEC. COR. FLUSH WITH GROUND Date set JAN. 19 81

HORIZONTAL CONTROL originated on _____ order control established by _____ in _____, on _____ North American 1927 _____ datum. _____ agency

Coordinates: North (y) _____ East (x) _____
(feet)

3rd Order

State and Zone Florida, Mercator West

Reference Bearings to Station or Object:

Description	Bearing	Distance

Field Book _____ Page _____ Sketch by B.R. HOMOLA

Reference Ties

- No. 1
- No. 2
- No. 3

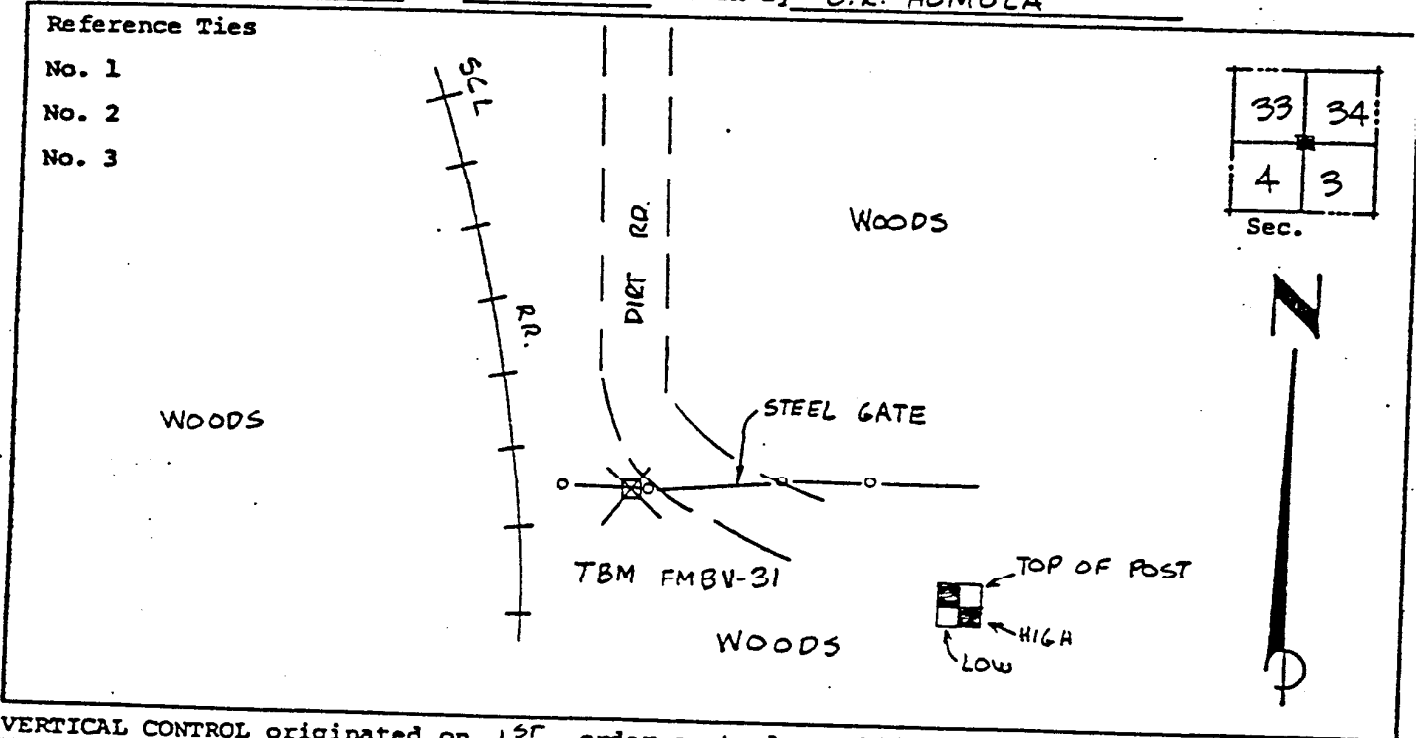

VERTICAL CONTROL originated on 1st order control established by USC & GS in 1966, on National Geodetic Survey Datum of 1929 datum. _____ agency

Elevation 15.36, 3rd Order Level Book V2 Page 64
(feet)