



Deni Associates

7025 N.W. 4th St. • Plantation, Florida 33317

LEE COUNTY, FLORIDA
AERIAL MAPPING PROJECT

MAPPING BY
HAMRICK AERIAL SURVEYS, INC.
CLEARWATER, FLORIDA

Marker Designation TBM FMBV-35 County LEE State FL
Located in Sec. 30 Twp. 46S Rge. 25E U.S.G.S. Quad Map ESTERO 7.5min.

To reach point from US 41 BRIDGE OVER ESTERO RIVER IN ESTERO:
GO N. 0.5 MI ± TO BROADWAY; THENCE W. 1.4 MI ± TO SUBSTATION;
THENCE CONTINUE W. ALONG TRAIL 0.3 MI ± TO TBM

Type of Marker 8" SPK IN N. FACE OF P. POLE Date set JANUARY 19 81

HORIZONTAL CONTROL originated on _____ order control established by _____ agency
in _____, on _____ North American 1927 _____ datum.

Coordinates: North (y) _____ East (x) _____
(feet) 3rd Order State and Zone Florida, Mercator West

Reference Bearings to Station or Object:

Description	Bearing	Distance

Field Book _____ Page _____ Sketch by A. LETHEBY

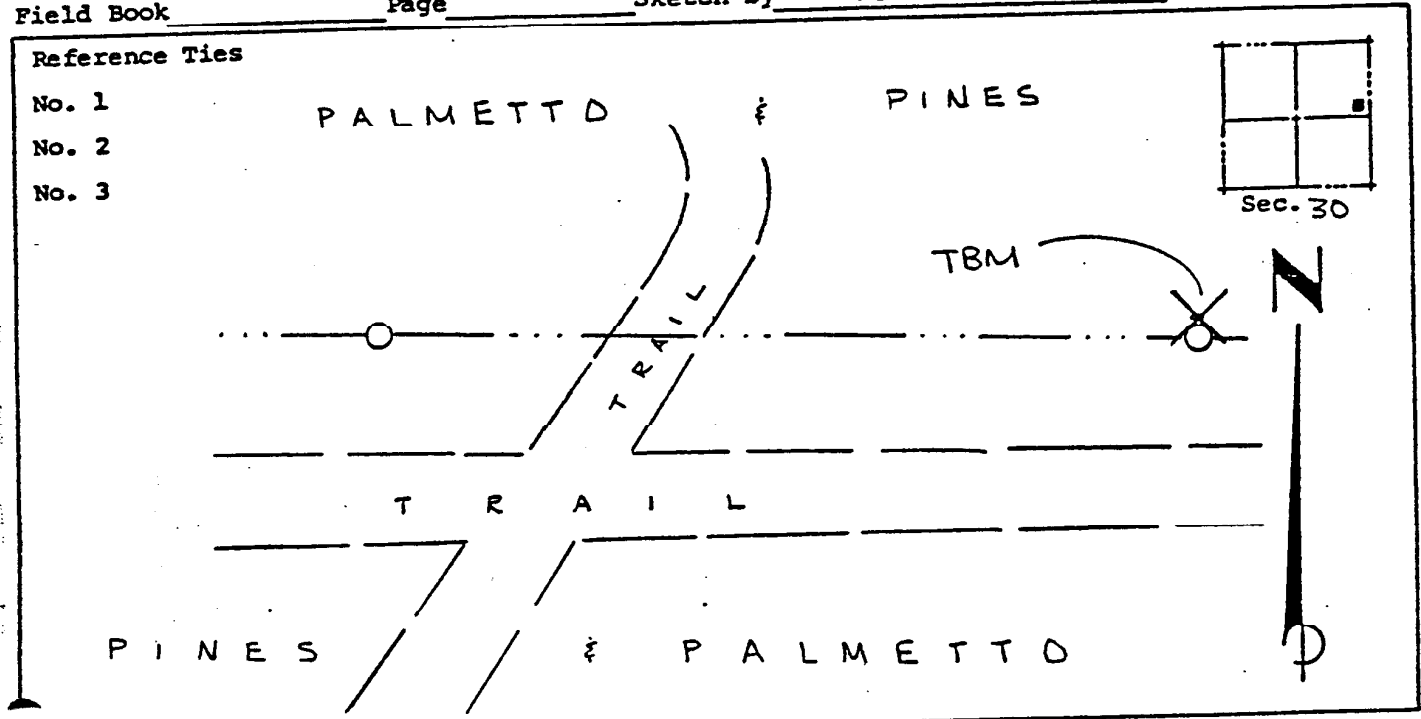

VERTICAL CONTROL originated on 1ST order control established by USC & GS agency
in 1966, on National Geodetic Survey Datum of 1929 datum.
year
Elevation 08.05, 3rd Order Level Book VI Page 61
(feet)