



Deni Associates

7025 N.W. 4th St. • Plantation, Florida 33317

LEE COUNTY, FLORIDA AERIAL MAPPING PROJECT

MAPPING BY
HAMRICK AERIAL SURVEYS, INC.
CLEARWATER, FLORIDA

Marker Designation USL & GS ESTERO NORTH BASE County LEE State FL
Located in Sec. 29 Twp. 46S Rge. 25E U.S.G.S. Quad Map ESTERO 7.5mi

To reach point from US 41 BRIDGE OVER ESTERO RIVER IN ESTERO :
GO N. 0.5 MI ± TO BROADWAY ; THENCE GO W. 1.4 MI ± TO
ESTERO SUBSTATION & BM.

Type of Marker STD. USL & GS BRASS DISC. SET IN CONK Date ^{REMOVED} JANUARY 19 81

HORIZONTAL CONTROL originated on _____ order control established by _____
in _____, on North American 1927 datum. _____ agency

Coordinates: North (y) _____ East (x) _____
(feet)

3rd Order State and Zone Florida, Mercator West

Reference Bearings to Station or Object:

Description	Bearing	Distance

Field Book _____ Page _____ Sketch by A. LETHEBY

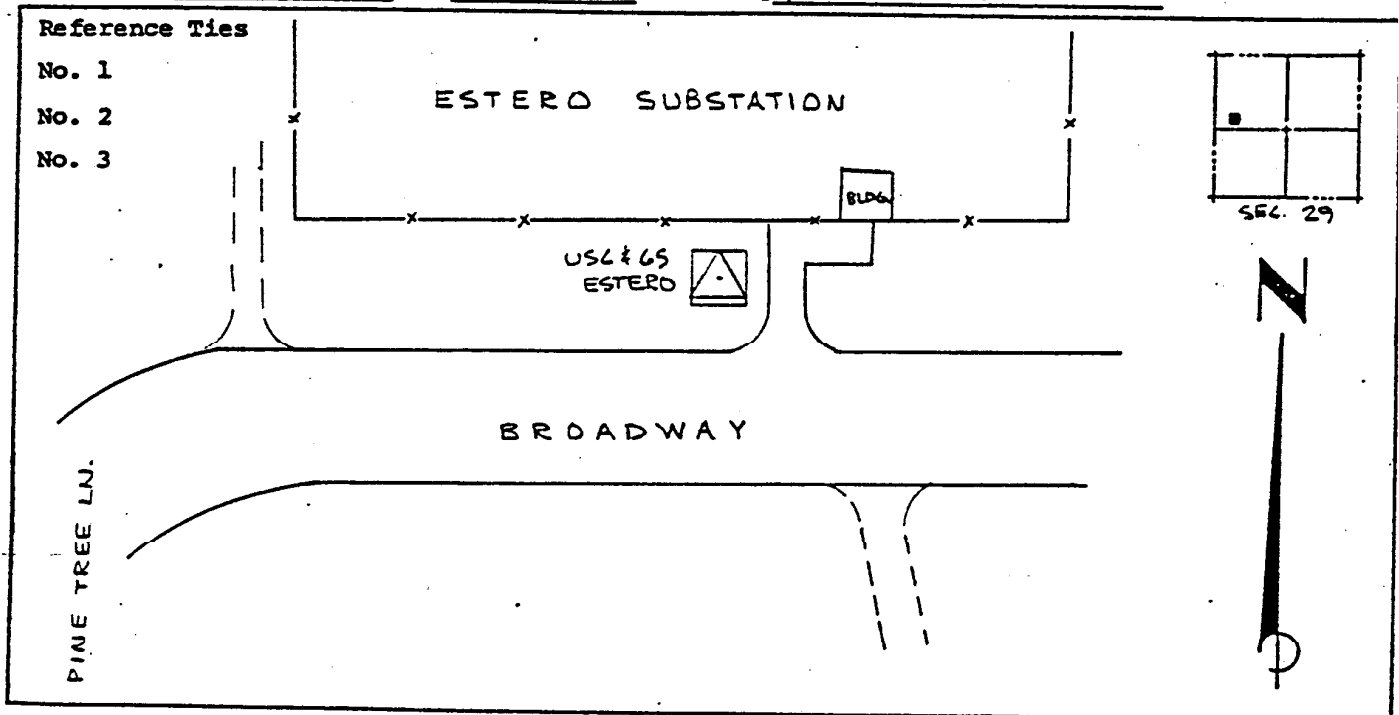

VERTICAL CONTROL originated on 1ST order control established by USL & GS agency

in 1966, on National Geodetic Survey Datum of 1929 datum.

Elevation 9.950, 3rd Order Level Book VI Page 62
(feet)