



Deni Associates

RT. 3, 11355 MARSHWOOD LN. S.W.  
FORT MYERS, FL 33908

LEE COUNTY, FLORIDA  
AERIAL MAPPING PROJECT

MAPPING BY  
HAMRICK AERIAL SURVEYS, INC.  
CLEARWATER, FLORIDA

DESIGNATION TBM NFMV-6 COUNTY LEE STATE FLA

LOCATED IN SEC 33 TWP 43S RGE 24E USGS QUAD MAP FT. MYERS NW

TO REACH SURVEY MARK FROM INT OF U.S. 41 AND SR 78: GO W AND SW  
1.1 MI: TO CORBETT RD.; THENCE N 0.2 MI: TO TBM

TYPE OF MARK 8" SPL IN W FACE OF P POLE DATE SET DEC. 19 81

HORIZONTAL CONTROL ORIGINATED ON \_\_\_\_\_ ORDER CONTROL ESTABLISHED BY \_\_\_\_\_  
IN \_\_\_\_\_, ON \_\_\_\_\_

COORDINATES (FT) NORTH (Y) \_\_\_\_\_ EAST (X) \_\_\_\_\_  
\_\_\_\_\_ ORDER STATE AND ZONE \_\_\_\_\_

REFERENCE BEARINGS TO STATION OR OBJECT

DESCRIPTION	BEARING	DISTANCE
_____	_____	_____
_____	_____	_____
_____	_____	_____

FIELD BOOK \_\_\_\_\_ PAGE \_\_\_\_\_ SKETCH BY ACL

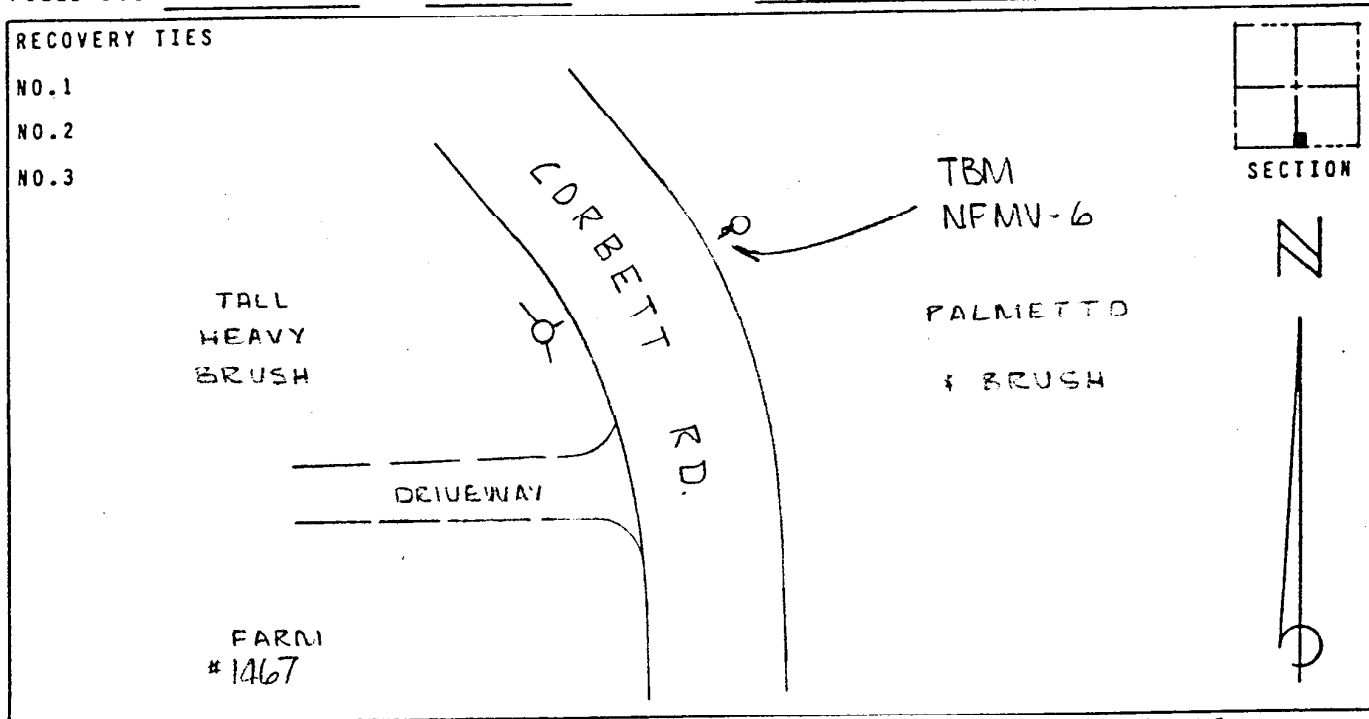

VERTICAL CONTROL ORIGINATED ON 1<sup>ST</sup> ORDER CONTROL ESTABLISHED BY USC & GS  
IN 1965 ON NATIONAL GEODETIC SURVEY DATUM OF 1929

ELEVATION (FT) 12.08, 3<sup>RD</sup> ORDER LEVEL BOOK Y6 PAGE 17