



Deini Associates

7025 N.W. 4th St. - Plantation, Florida 33317

LEE COUNTY, FLORIDA
AERIAL MAPPING PROJECT

MAPPING BY
HAMRICK AERIAL SURVEYS, INC.
CLEARWATER, FLORIDA

Marker Designation TBM SMCV-20 County LEE State FL
Located in Sec. 19 Twp. 45S Rgc. 25 E. U.S.G.S. Quad Map FORT MYERS SE 7.5min.

To reach point from _____
_____ AT NEW DANIELS RD. BRIDGE OVER TEN MILE CANAL _____
_____ 1.0 MI ± EAST OF U.S. RT. 41 _____

Type of Marker CHISELED "D" ON 1/2" CONC HDRL ON BRIDGE Date set JUNE 19 80
HORIZONTAL CONTROL originated on 2nd order control established by FLA. D.O.T. agency
in 1972 year, on North American 1927 datum.
Coordinates: North (y) _____ East (x) _____
(feet) 3rd Order State and Zone Florida, Mercator West

Reference Bearings to Station or Object:

Description	Bearing	Distance

Field Book _____ Page _____ Sketch by A. LETHBY

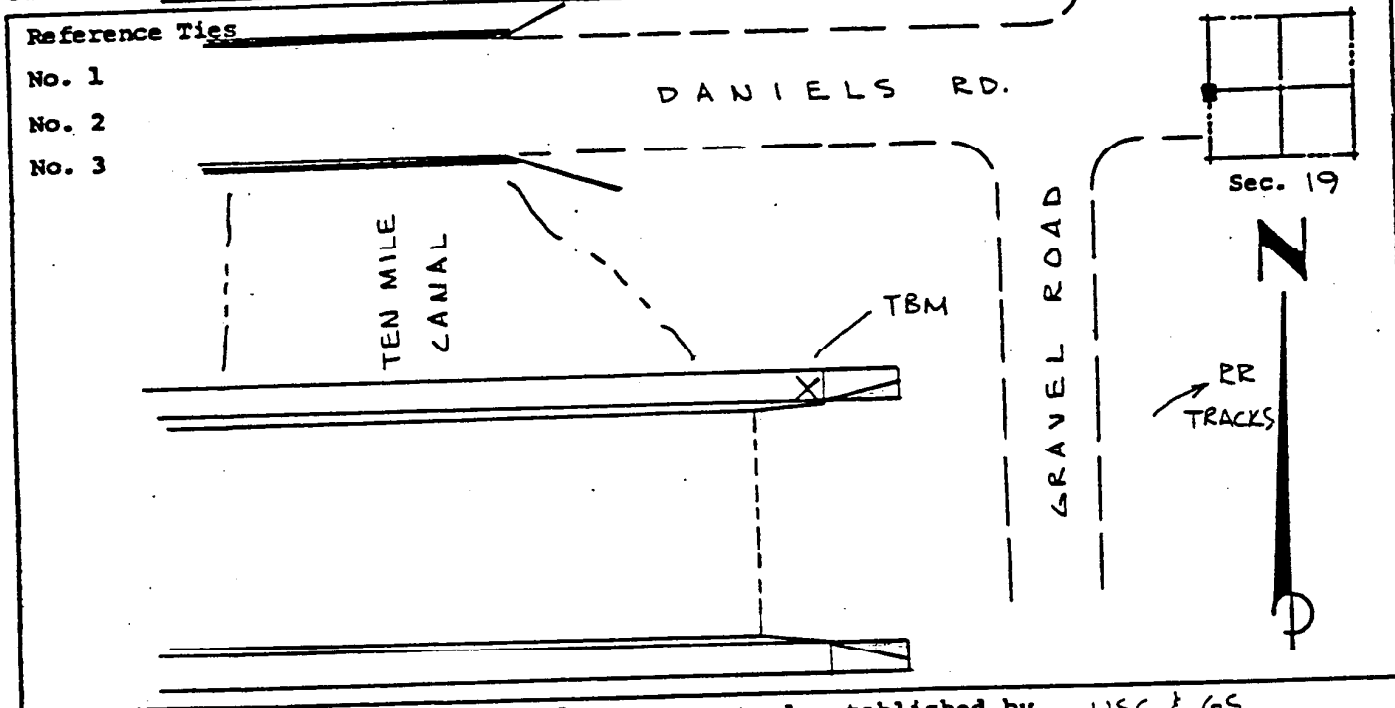

VERTICAL CONTROL originated on 1ST order control established by USC & GS agency
in 1965 year, on National Geodetic Survey Datum of 1929 datum.
Elevation 20.38 (feet), 3rd Order Level Book V2 Page 4