



Deni Associates

RT. 3, 11555 MARSHWOOD LN. S.W.
FORT MYERS, FL 33908

LEE COUNTY, FLORIDA
AERIAL MAPPING PROJECT

MAPPING BY
HAMRICK AERIAL SURVEYS, INC.
CLEARWATER, FLORIDA

DESIGNATION TBM SFMV-43 COUNTY LEE STATE FL.
LOCATED IN SEC 23 TWP 45S RGE 75E USGS QUAD MAP FORT MYERS S.E.

TO REACH SURVEY MARK FROM INT. OF US. 41 & DANIELS RD. IN S. FT. MYERS: GO E. ON DANIELS RD. 5.9 MI.± TO MARK.

TYPE OF MARK 8" BRIDGE SPK. - BENT - IN P. POLE @ L. DATE SET APRIL 19 82

HORIZONTAL CONTROL ORIGINATED ON _____ ORDER CONTROL ESTABLISHED BY _____
IN _____, ON _____

COORDINATES (FT) NORTH (Y) _____ EAST (X) _____
_____ ORDER STATE AND ZONE _____

REFERENCE BEARINGS TO STATION OR OBJECT

DESCRIPTION	BEARING	DISTANCE
_____	_____	_____
_____	_____	_____
_____	_____	_____

FIELD BOOK _____ PAGE _____ SKETCH BY A LETHBY

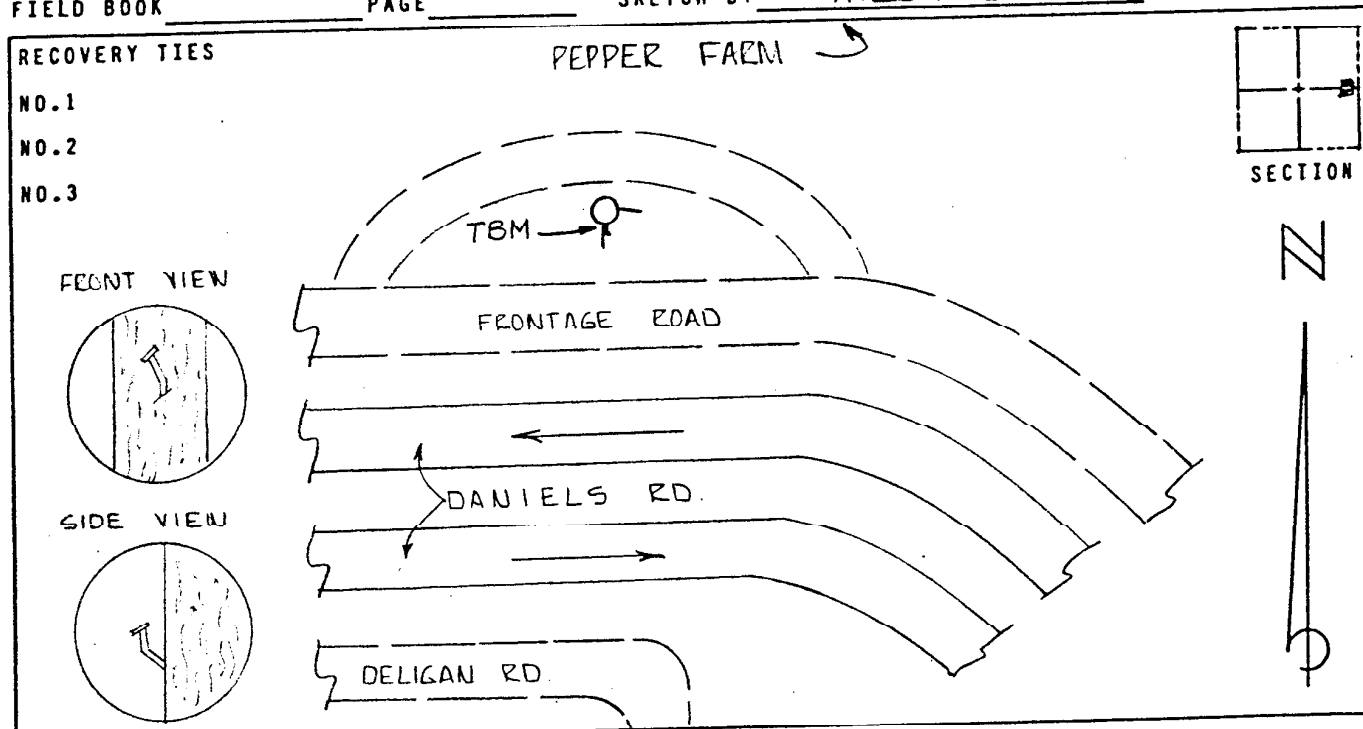

VERTICAL CONTROL ORIGINATED ON 1ST. ORDER CONTROL ESTABLISHED BY USC & GS

IN 1966, ON NATIONAL GEODETIC VERTICAL DATUM 1929

ELEVATION (FT) 25.96, 3RD. ORDER LEVEL BOOK V7 PAGE 41