



Deni Associates

7025 N.W. 4th St. • Plantation, Florida 33317

LEE COUNTY, FLORIDA
AERIAL MAPPING PROJECT

MAPPING BY
HAMRICK AERIAL SURVEYS, INC.
CLEARWATER, FLORIDA

Marker Designation TBM SMCV-14 County LEE State FL
Located in Sec. 8 Twp. 45S Rge. 25 E. U.S.G.S. Quad Map FORT MYERS SE 7.5min.

To reach point from _____
MARKER IS 500' N. AND 700' W. OF THE SE. CORNER OF SECTION 8.
ON S. END OF W. CULVERT PIPE UNDER RANCHETTE RD. AT WEST EDGE
OF SIX MILE CYPRESS.

Type of Marker CHISELED "D" ON TOP OF CONC. PIPE Date set JUNE 19 80
HORIZONTAL CONTROL originated on 2nd order control established by FLA. D.O.T. agency

in 1972, on North American 1927 datum.
Coordinates: North (y) _____ East (x) _____
(feet) 3rd Order State and Zone Florida, Mercator West

Reference Bearings to Station or Object:	Bearing	Distance
Description		
_____	_____	_____
_____	_____	_____

Field Book _____ Page _____ Sketch by B.R. HOMOLA

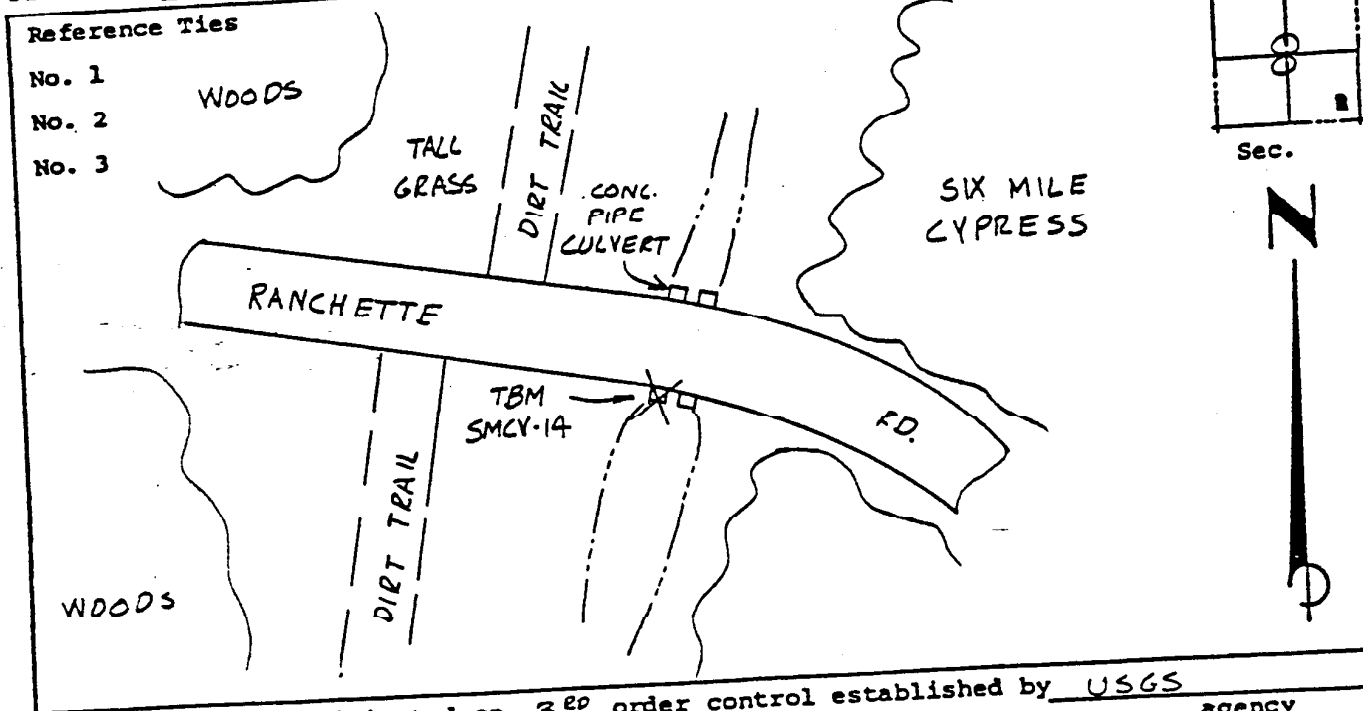

VERTICAL CONTROL originated on 3rd order control established by USGS agency
in 1971, on National Geodetic Survey Datum of 1929 datum.
Elevation 16.77, 3rd Order Level Book V1 Page 13

(DESTROYED)