

LEE COUNTY, FLORIDA
AERIAL MAPPING PROJECT

MAPPING BY
HAMRICK AERIAL SURVEYS, INC.
CLEARWATER, FLORIDA



Deni Associates
RT. 3, 11555 MARSHWOOD LN. S.W.
FORT MYERS, FL 33908

DESIGNATION TBM SEMV-15 COUNTY LEE STATE FL.

LOCATED IN SEC 27 TWP 45S RGE 24E USGS QUAD MAP FORT MYERS S.W.

TO REACH SURVEY MARK FROM INT. GLADIOLUS RD./SR 865 & WINKLER RD. IN SEC 34-
45S-24E: 60. N. MI ± TO ASCOT RD. & MARK.

TYPE OF MARK CH "X" N. RIM OF U.T.S. MANHOLE DATE SET FEB 19 82

HORIZONTAL CONTROL ORIGINATED ON _____ ORDER CONTROL ESTABLISHED BY _____
IN _____, ON _____.

COORDINATES (FT) NORTH (Y) _____ EAST (X) _____
_____ ORDER STATE AND ZONE _____

REFERENCE BEARINGS TO STATION OR OBJECT

DESCRIPTION	BEARING	DISTANCE
_____	_____	_____
_____	_____	_____

FIELD BOOK _____ PAGE _____ SKETCH BY D.W. ALBERTSEN

RECOVERY TIES

- NO. 1
- NO. 2
- NO. 3

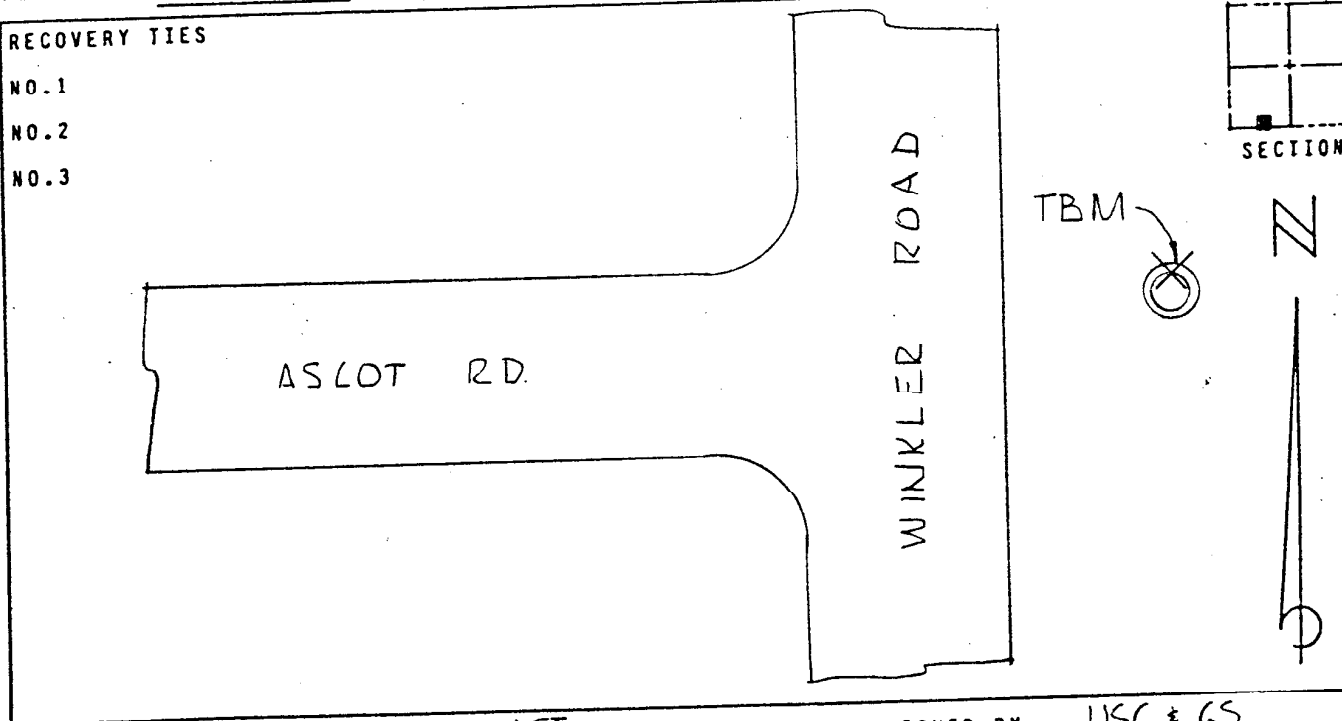

VERTICAL CONTROL ORIGINATED ON 1ST ORDER CONTROL ESTABLISHED BY USC & GS
IN 1966, ON NATIONAL GEODETIC VERTICAL DATUM 1929

ELEVATION (FT) 06.56, 3RD ORDER LEVEL BOOK V6 PAGE 43