



Deni Associates
 RT. 3, 11555 MARSHWOOD LN. S.W.
 FORT MYERS, FL 33908

LEE COUNTY, FLORIDA
 AERIAL MAPPING PROJECT

MAPPING BY
 HAMRICK AERIAL SURVEYS, INC.
 CLEARWATER, FLORIDA

DESIGNATION TBM SFMV-13 COUNTY LEE STATE FL.

LOCATED IN SEC 23 TWP 45S RGE 24E USGS QUAD MAP FORT MYERS S.W.

TO REACH SURVEY MARK FROM _____

@ INT CYPRESS LAKE DR & SR 869 IN SEC 23-45S-24E

TYPE OF MARK CH"Ø" N. END OF CONC. TIP ON MEDIAN DATE SET FEB. 19 82

HORIZONTAL CONTROL ORIGINATED ON _____ ORDER CONTROL ESTABLISHED BY _____
 IN _____, ON _____

COORDINATES (FT) NORTH (Y) _____ EAST (X) _____
 _____ ORDER STATE AND ZONE _____

REFERENCE BEARINGS TO STATION OR OBJECT

DESCRIPTION	BEARING	DISTANCE
SET DRILL HOLE IN THE TOP S. END OF THE M. RIFLNSE OF A CONC. MEDIAN @ THE INT. OF SUMMERLIN & CYPRESS LAKE DRIVE.	_____	_____
B.M. 248-12-02 ELEV. 9.31 CYPRESS LAKE PLANS (HMA)	_____	_____

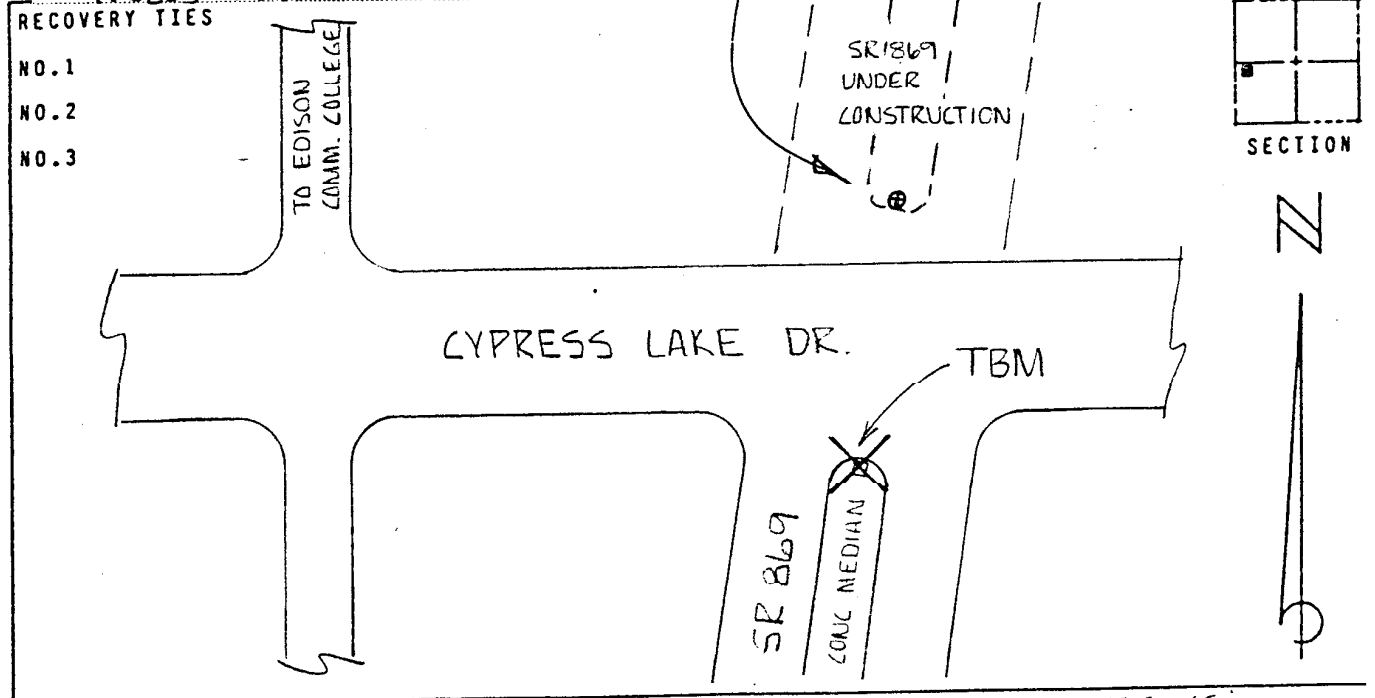

VERTICAL CONTROL ORIGINATED ON 1ST ORDER CONTROL ESTABLISHED BY USC & GS

IN 1966, ON NATIONAL GEODETIC VERTICAL DATUM 1929

ELEVATION (FT) 09.69, 3RD ORDER LEVEL BOOK V8 PAGE 4