



**Deni Associates**  
 RT. 3, 11555 MARSHWOOD LN. S.W.  
 FORT MYERS, FL 33908

LEE COUNTY, FLORIDA  
 AERIAL MAPPING PROJECT

MAPPING BY  
 HAMRICK AERIAL SURVEYS, INC.  
 CLEARWATER, FLORIDA

DESIGNATION TBM SFMV-14 COUNTY LEE STATE FL

LOCATED IN SEC 22 TWP 45S RGE 24E USGS QUAD MAP FORT MYERS S.W.

TO REACH SURVEY MARK FROM INT. GLADIOLUS DR. / SR 865 & WINKLER RD IN SEC 34-45S-24E : GO N. 1.25 MI ± TO MYERLEE COUNTRY CLUB BLVD. & MARK.

TYPE OF MARK CH. "O" E. END CONC. CURB ON MEDIAN DATE SET FEB 19 87

HORIZONTAL CONTROL ORIGINATED ON \_\_\_\_\_ ORDER CONTROL ESTABLISHED BY \_\_\_\_\_  
 IN \_\_\_\_\_, ON \_\_\_\_\_.

COORDINATES (FT) NORTH (Y) \_\_\_\_\_ EAST (X) \_\_\_\_\_  
 \_\_\_\_\_ ORDER STATE AND ZONE \_\_\_\_\_

REFERENCE BEARINGS TO STATION OR OBJECT

DESCRIPTION	BEARING	DISTANCE
_____	_____	_____
_____	_____	_____
_____	_____	_____

FIELD BOOK \_\_\_\_\_ PAGE \_\_\_\_\_ SKETCH BY ACL

RECOVERY TIES

- NO. 1
- NO. 2
- NO. 3

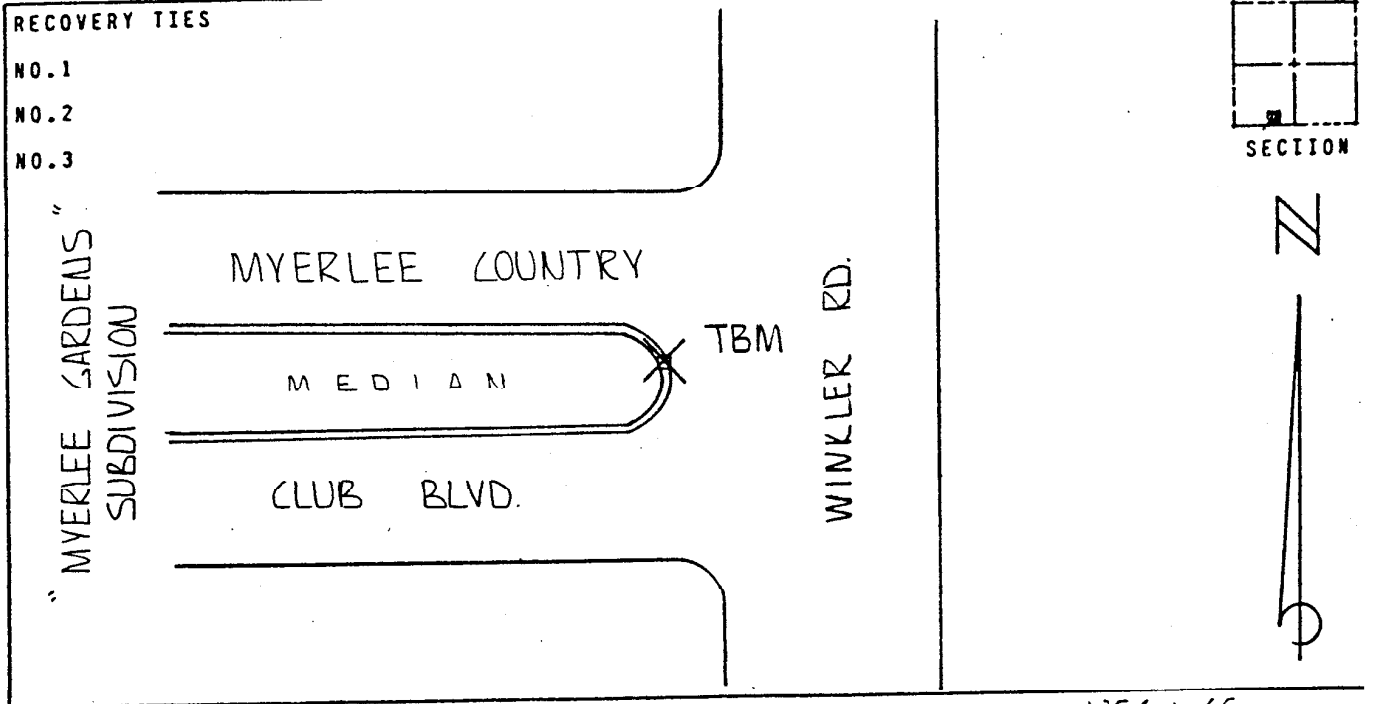
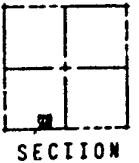

VERTICAL CONTROL ORIGINATED ON 1ST ORDER CONTROL ESTABLISHED BY USC & GS

IN 1966, ON NATIONAL GEODETIC VERTICAL DATUM 1929

ELEVATION (FT) 06.48, 3RD ORDER LEVEL BOOK V8 PAGE 2