

LEE COUNTY, FLORIDA
AERIAL MAPPING PROJECT

MAPPING BY
HAMRICK AERIAL SURVEYS, INC.
CLEARWATER, FLORIDA



Deni Associates
RT. 3, 11555 MARSHWOOD LN. S.W.
FORT MYERS, FL 33908

DESIGNATION TBM-SFMV-22 COUNTY LEE STATE FL.
LOCATED IN SEC 14 TWP 45S. RGE 24E. USGS QUAD MAP FORT MYERS S.W.
TO REACH SURVEY MARK FROM INT. U.S. 41 @ GLADIOLAS DR: GO N. 0.23 MI ± TO COLLEGE PKWY:
THENCE GO W. 0.3 MI ± TO MARK.

TYPE OF MARK CHISELED "I" IN CONC. CURB. DATE SET MAR. 19 82
HORIZONTAL CONTROL ORIGINATED ON _____ ORDER CONTROL ESTABLISHED BY _____
IN _____, ON _____
COORDINATES (FT) NORTH (Y) _____ EAST (X) _____
_____ ORDER STATE AND ZONE _____

REFERENCE BEARINGS TO STATION OR OBJECT	BEARING	DISTANCE
DESCRIPTION		
_____	_____	_____
_____	_____	_____

FIELD BOOK _____ PAGE _____ SKETCH BY C.L.B.

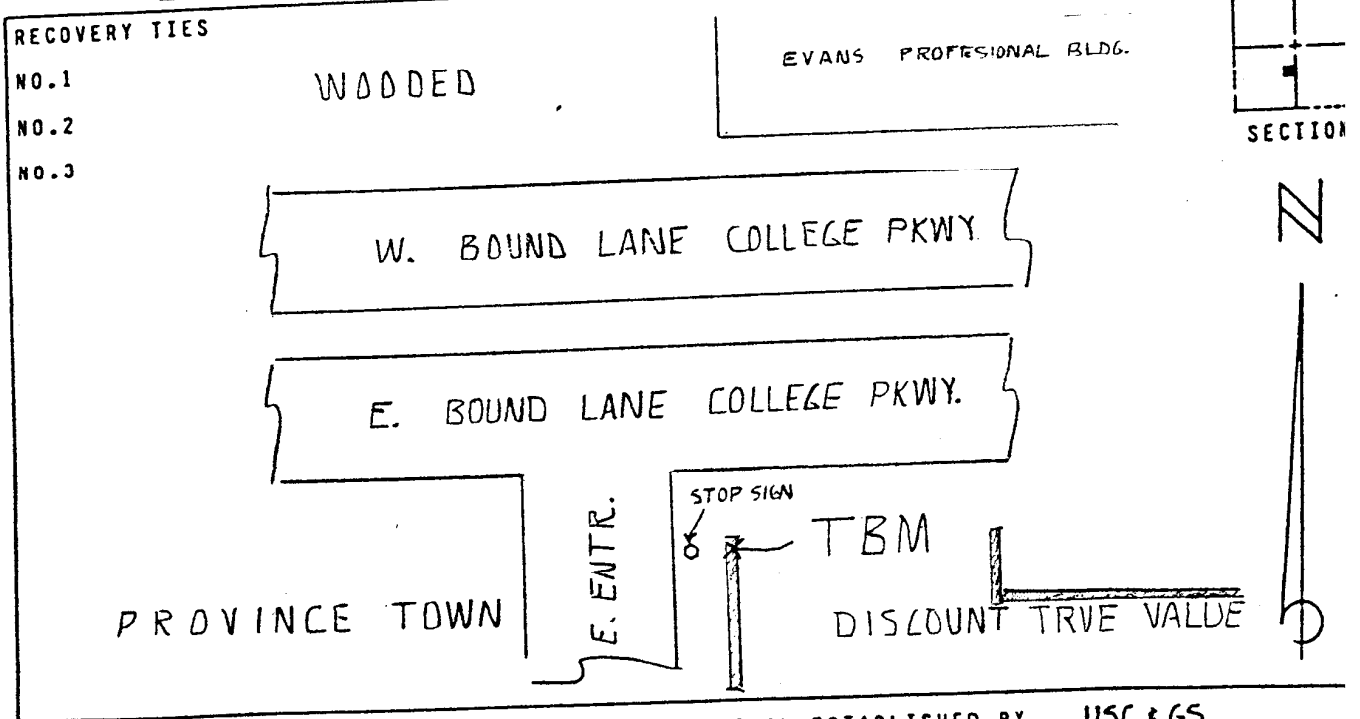

RECOVERY TIES
NO. 1 WOODED
NO. 2
NO. 3
EVANS PROFESSIONAL BLDG.VERTICAL CONTROL ORIGINATED ON 1ST. ORDER CONTROL ESTABLISHED BY USC & GS
IN 1966, ON NATIONAL GEODETIC VERTICAL DATUM 1929.
ELEVATION (FT) 09.65, 3RD ORDER LEVEL BOOK V-9 PAGE 15