



Dani Associates

RT. 3, 11355 MARSHWOOD LN. S.W.  
FORT MYERS, FL 33908

# LEE COUNTY, FLORIDA AERIAL MAPPING PROJECT

MAPPING BY  
HAMRICK AERIAL SURVEYS, INC.  
CLEARWATER, FLORIDA

DESIGNATION TBM SFMV-1 COUNTY LEE STATE FL  
LOCATED IN SEC 35 TWP 45 S. RGE 23 E. USGS QUAD MAP FT MYERS SW

TO REACH SURVEY MARK FROM INT. OF MCGREGOR BLVD. & GLADIOLUS DR. IN SW.  
FORT MYERS: GO SW. ON MCGREGOR BLVD. 2.0 MI.± TO JOHN MORRIS  
RD.; THENCE N. 0.8 MI.± TO IONA RD. & MARK.

TYPE OF MARK CHISELED "D" ON CONC. HDWL. DATE SET DEC. 1981

HORIZONTAL CONTROL ORIGINATED ON \_\_\_\_\_ ORDER CONTROL ESTABLISHED BY \_\_\_\_\_  
IN \_\_\_\_\_, ON \_\_\_\_\_.

COORDINATES (FT) NORTH (Y) \_\_\_\_\_ EAST (X) \_\_\_\_\_  
\_\_\_\_\_ ORDER STATE AND ZONE \_\_\_\_\_

REFERENCE BEARINGS TO STATION OR OBJECT

DESCRIPTION	BEARING	DISTANCE
_____	_____	_____
_____	_____	_____
_____	_____	_____

FIELD BOOK \_\_\_\_\_ PAGE \_\_\_\_\_ SKETCH BY DW ALBERTSEN

RECOVERY TIES

- NO. 1
- NO. 2
- NO. 3

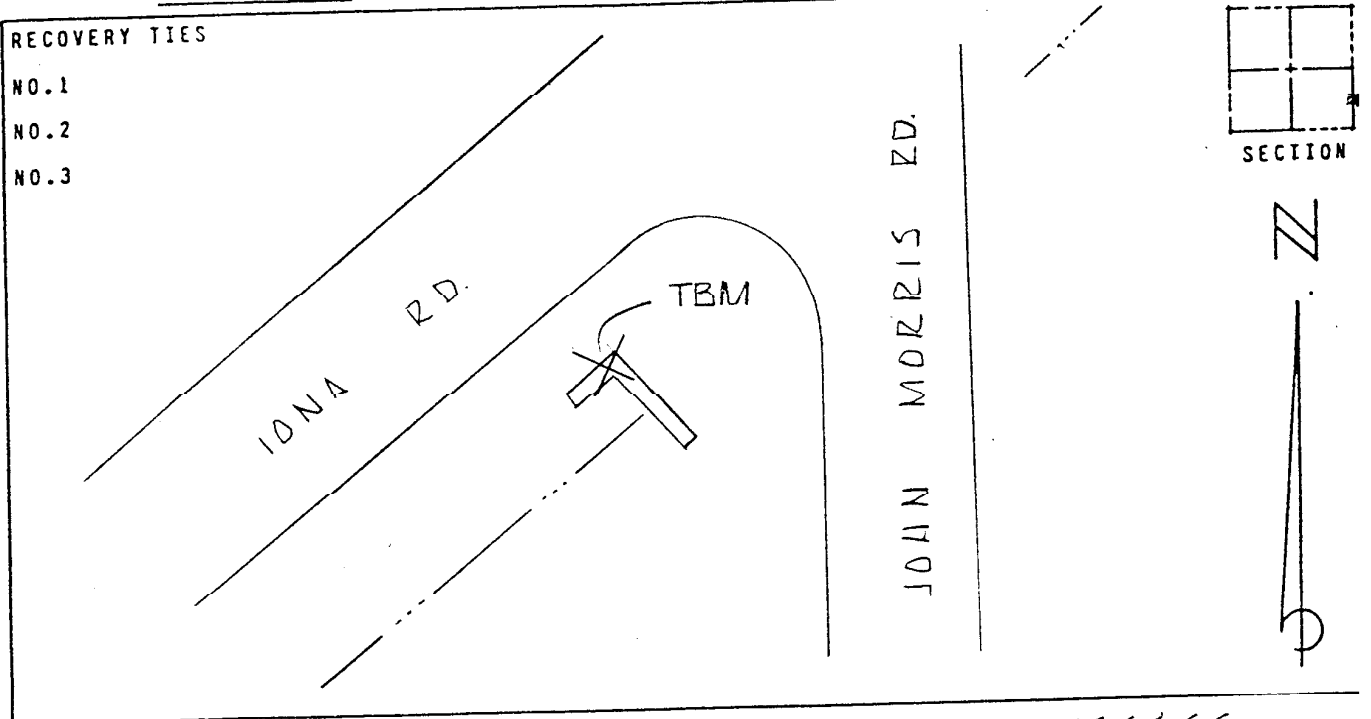

VERTICAL CONTROL ORIGINATED ON 1<sup>ST</sup> ORDER CONTROL ESTABLISHED BY USCEGS

IN 1966, ON NATIONAL GEODETIC VERTICAL DATUM 1929

ELEVATION (FT) 06.24, 3<sup>RD</sup> ORDER LEVEL BOOK V5 PAGE 57