



Deni Associates

7025 N.W. 4th St. - Plantation, Florida 33317

LEE COUNTY, FLORIDA
AERIAL MAPPING PROJECT

MAPPING BY
HAMRICK AERIAL SURVEYS, INC.
CLEARWATER, FLORIDA

Marker Designation TBM P15V-6 County LEE State FL

Located in Sec. 11 Twp. 45S Rge. 22E U.S.G.S. Quad Map PINE ISLAND CENTER 7.5mi

To reach point from INT. OF SR. 78 & 767 IN PINE ISLAND CENTER. GO S. ON
SR. 767 3.65 MI.± TO TRANSMISSION LINE; THENCE E. 0.8 MI.± TO
MARKER.

Type of Marker CHISELED "+" SET VERTICALLY IN S. FACE OF CONC. PP. Date set MAY 19 81

HORIZONTAL CONTROL originated on _____ order control established by _____ agency

in _____, on _____ North American 1927 _____ datum.

Coordinates: North (y) _____ East (x) _____
(feet)

3rd Order

State and Zone Florida, Mercator West

Reference Bearings to Station or Object:

Description	Bearing	Distance

Field Book _____ Page _____ Sketch by B.R. HOMOLA

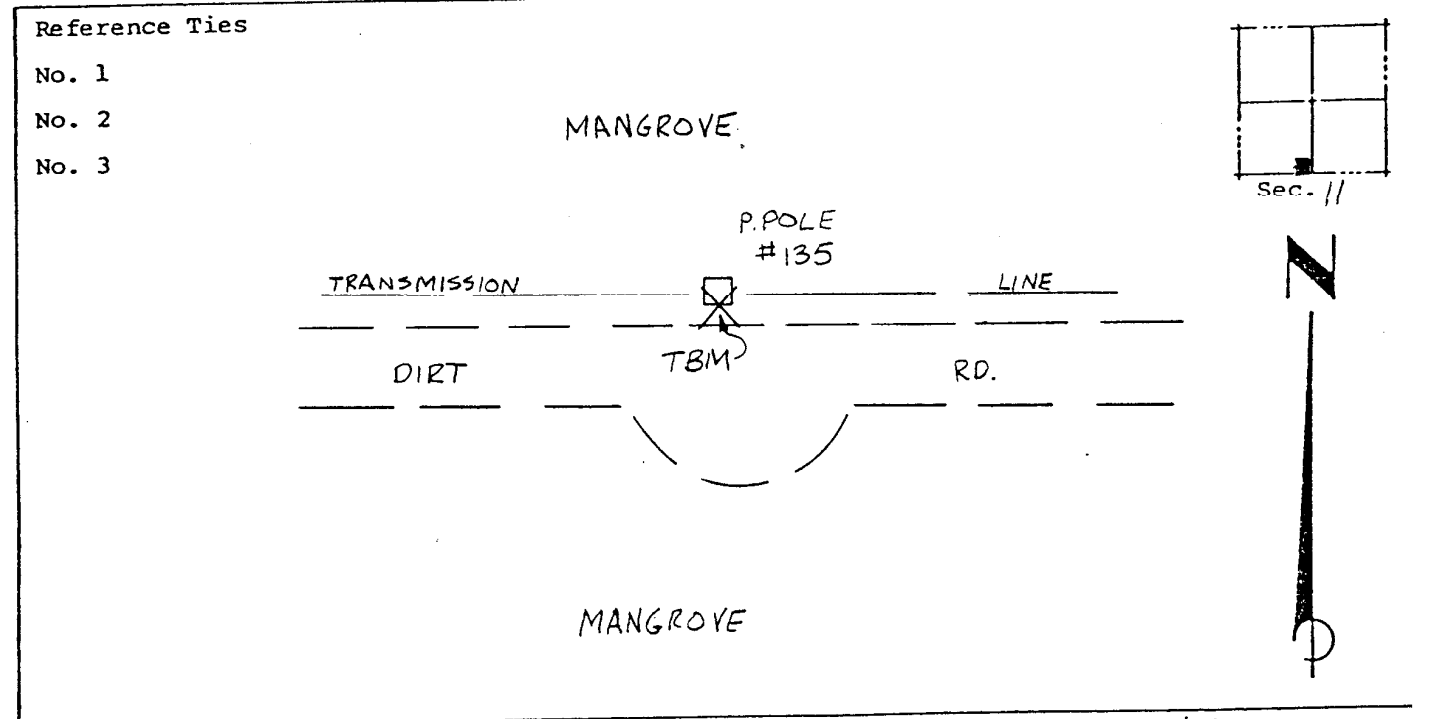

VERTICAL CONTROL originated on 1ST order control established by USCGS agency

in 1966, on _____ National Geodetic Survey Datum of 1929 _____ datum.

Elevation 4.30, 3rd Order Level Book V4 Page 37