



Deni Associates

7025 N.W. 4th St. - Plantation, Florida 33317

LEE COUNTY, FLORIDA AERIAL MAPPING PROJECT

MAPPING BY
HAMRICK AERIAL SURVEYS, INC.
CLEARWATER, FLORIDA

Marker Designation TBM PISV-7 County LEE State FL

Located in Sec. 9 Twp. 455 Rge. 22E U.S.G.S. Quad Map PINE ISLAND CENTER 7.5min

To reach point from INT. OF SR. 78 & 767 IN PINE ISLAND CENTER. GO S. ON
SR. 767 3.0 MI. ± TO FLAMINGO DR.; THENCE SW. 0.6 MI. ± TO
THE END OF THE RD. & MARKER.

Type of Marker 8" SPIKE IN N. FACE P. POLE Date set APRIL 19 81

HORIZONTAL CONTROL originated on _____ order control established by _____
in _____, on _____ North American 1927 _____ datum. _____ agency

Coordinates: North (y) _____ East (x) _____
(feet)

3rd Order State and Zone Florida, Mercator West

Reference Bearings to Station or Object:

Description	Bearing	Distance

Field Book _____ Page _____ Sketch by B. R. HOMOLA

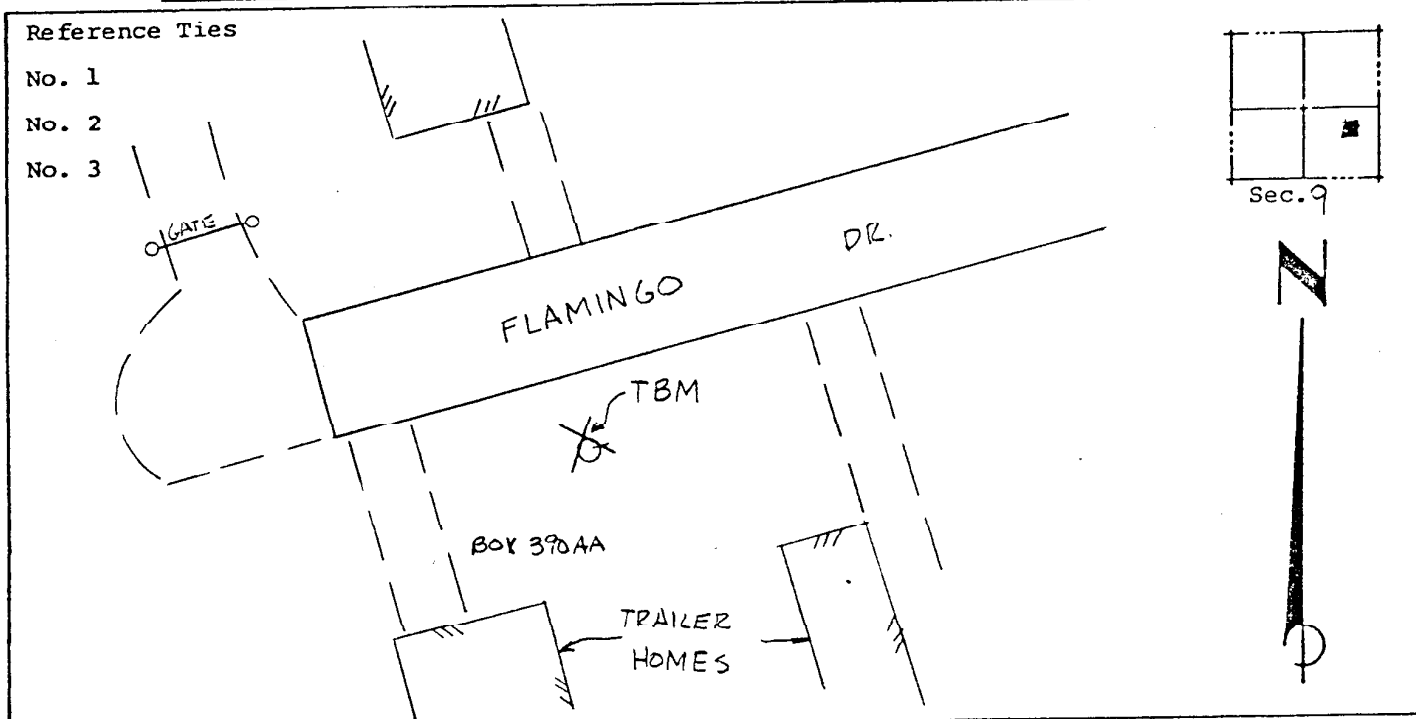

VERTICAL CONTROL originated on 1st order control established by USCGS
agency

in 1966, on National Geodetic Survey Datum of 1929 datum.
year

Elevation 5.74, 3rd Order Level Book V4 Page 7
(feet)