



Deni Associates

7025 N.W. 4th St. • Plantation, Florida 33317

LEE COUNTY, FLORIDA
AERIAL MAPPING PROJE

MAPPING BY
HAMRICK AERIAL SURVEYS, INC.
CLEARWATER, FLORIDA

Marker Designation R-86 & TBM (DNR) County LEE State FL

Located in Sec. 22 Twp. 45 Rge. 21 U.S.G.S. Quad Map CAPTIVA 7.5mi

To reach point from NW END OF BLIND PASS BRIDGE: GO NW 1.5 MI ±
ON CAPTIVA ROAD TO CAPTIVA DRIVE SW.; THENCE N. 2.0 MI ±
ON CAPTIVA DRIVE SW. TO SOUTH SEAS PLANTATION ROAD;
THENCE N. 1.5 MI ± TO MARK.

Type of Marker STD. 4" BRASS DISC IN 4 1/4" x 4 1/2" CONC. Date set MAY 19 81

HORIZONTAL CONTROL ~~originated in~~ 3RD order control established by DNR

in 1974, on North American 1927 datum. agency

Coordinates: North (y) 804,234.606 East (x) 435,386.225
(feet)

3rd Order State and Zone Florida, Mercator West

Reference Bearings to Station or Object:

Description	Bearing	Distance

Field Book Page Sketch by W.T.R.

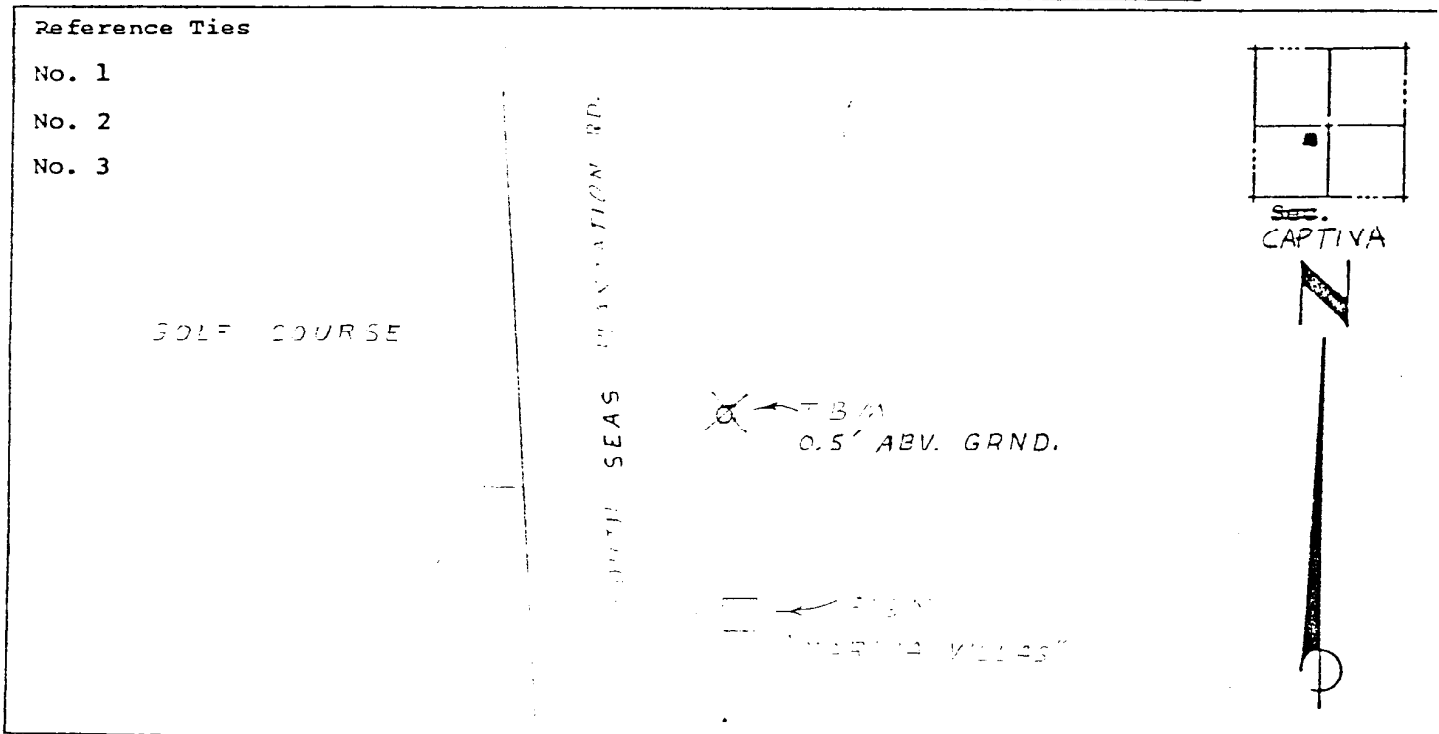

VERTICAL CONTROL ~~originated in~~ 3RD order control established by D.N.R. agency

in 1975, on National Geodetic Survey Datum of 1929 datum.

Elevation 5.20, 3rd Order Level Book 3 Page 71