



Deni Associates
FORT MYERS, FLORIDA

LEE COUNTY, FLORIDA
AERIAL MAPPING PROJECT

MAPPING BY:
WOOLPERT CONSULTANTS

DESIGNATION TBM 20-29 COUNTY LEE STATE FL
LOCATED IN SEC 25 TWP 40S RGE 27E USGS QUAD MAP ALVA SE
TO REACH SURVEY MARK FROM WELLINGTON AV & 5 ST E IN
LEHIGH ACRES; GO SOUTH TO ADDRESS #400 WELLINGTON
AND MARK.

TYPE OF CHIS "D" ON COR. - CONC. DRIVE
MARK _____ DATE SET DEC. 1988

HORIZONTAL CONTROL ORIGINATED ON 2ND ORDER CONTROL BY N.G.S. AND F.D.O.T.

ON NORTH AMERICAN DATUM OF 1927 (1927 ADJ) ON NORTH AMERICAN DATUM OF 1983

COORDINATES (FT) COORDINATES (FT)

NORTHING (Y) _____ NORTHING (Y) _____

EASTING (X) _____ EASTING (X) _____

3RD ORDER COORDINATES STATE AND ZONE FLORIDA, MERCATOR WEST

FIELD BOOK _____ PAGE _____ SKETCH BY DSW

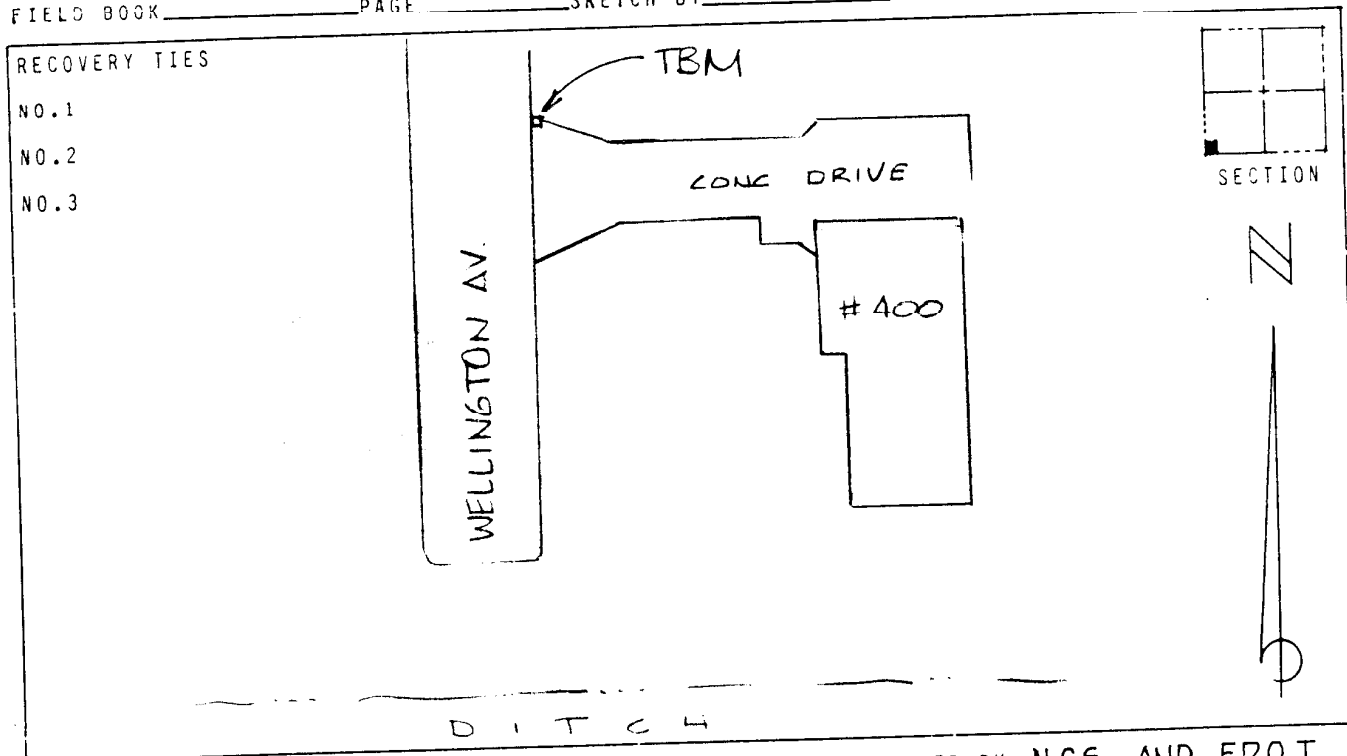

VERTICAL CONTROL ORIGINATED ON 2ND ORDER CONTROL ESTABLISHED BY N.G.S. AND F.D.O.T.

ON NATIONAL GEODETIC VERTICAL DATUM OF 1929

ELEVATION (FT) 25.80 . 3RD ORDER LEVEL BOOK V20 PAGE 29