



Deni Associates
FORT MYERS, FLORIDA

LEE COUNTY, FLORIDA
AERIAL MAPPING PROJECT

MAPPING BY:
WOOLPERT CONSULTANTS

DESIGNATION TBM 20-25A COUNTY LEE STATE FL

LOCATED IN SEC 23 | 24 | 26 | 25 TWP 44 S RGE 27 E USGS QUAD MAP ALVA

TO REACH SURVEY MARK ~~FROM~~ _____

AT INTERSECTION AS SHOWN
IN LEHIGH ACRES.

TYPE OF 3/4" PIPE IN 6" X 6" CONC. MONUMENT, PROJ. 1.5' ABV. GRD.

MARK - SEC. COR. DATE SET DEC. 1988

HORIZONTAL CONTROL ORIGINATED ON 2ND ORDER CONTROL BY N.G.S. AND F.D.O.T.

ON NORTH AMERICAN DATUM OF 1927 (1927 ADJ) ON NORTH AMERICAN DATUM OF 1983

COORDINATES (FT) COORDINATES (FT)

NORTHING (Y) _____ NORTHING (Y) _____

EASTING (X) _____ EASTING (X) _____

3RD ORDER COORDINATES STATE AND ZONE FLORIDA, MERCATOR WEST

FIELD BOOK _____ PAGE _____ SKETCH BY DSW

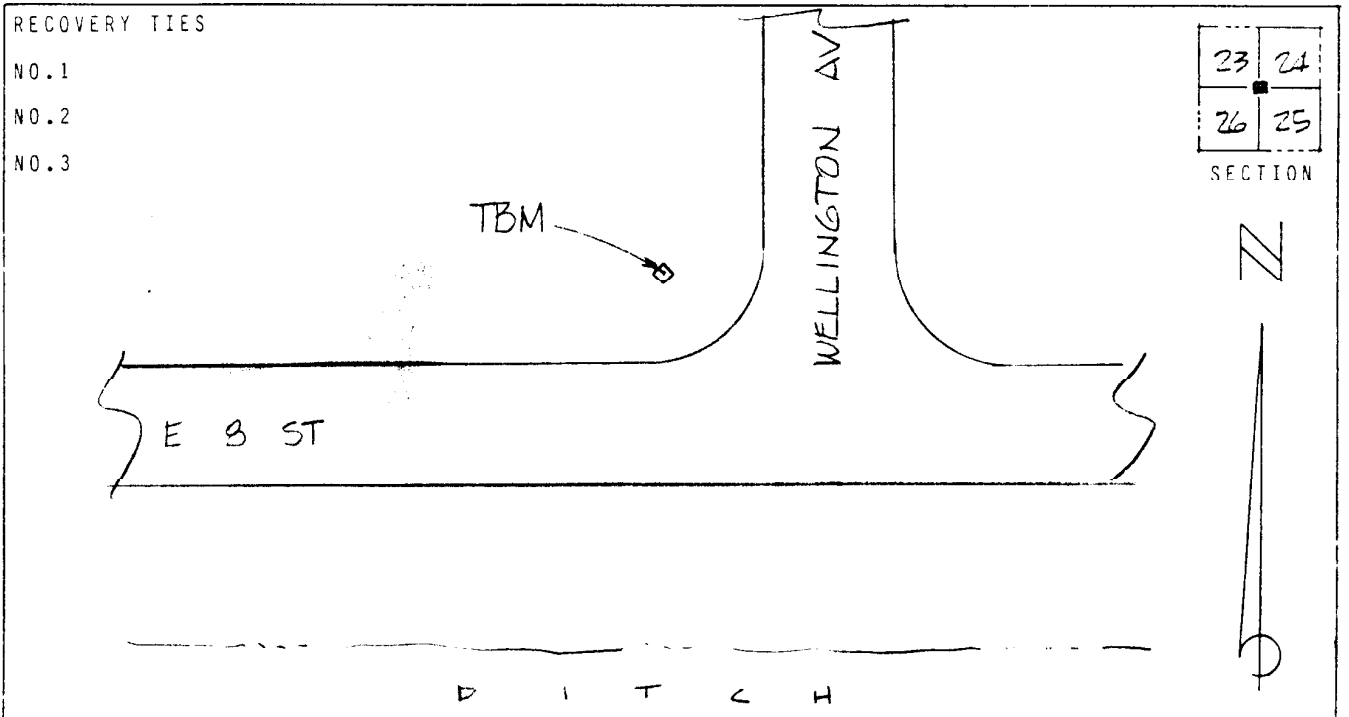

VERTICAL CONTROL ORIGINATED ON 2ND ORDER CONTROL ESTABLISHED BY N.G.S. AND F.D.O.T.

ON NATIONAL GEODETIC VERTICAL DATUM OF 1929

ELEVATION (FT) 25.76 , 3RD ORDER LEVEL BOOK V20 PAGE 25