



Deni Associates  
FORT MYERS, FLORIDA

LEE COUNTY, FLORIDA  
AERIAL MAPPING PROJECT

MAPPING BY:  
WOOLPERT CONSULTANTS

DESIGNATION TBM 21-50 COUNTY LEE STATE FL  
LOCATED IN SEC 17 TWP 44S RGE 27E USGS QUAD MAP OLCA  
TO REACH SURVEY MARK FROM AT INTERSECTION AS SHOWN  
IN LEHIGH ACRES

TYPE OF FD. SPK & TAB (P.C.P.) & INT.  
MARK \_\_\_\_\_ DATE SET DEC. 1988

HORIZONTAL CONTROL ORIGINATED ON 2ND ORDER CONTROL BY N.G.S. AND F.D.O.T.

ON NORTH AMERICAN DATUM OF 1927 (1927 ADJ) ON NORTH AMERICAN DATUM OF 1983  
COORDINATES (FT) COORDINATES (FT)

NORTHING (Y) \_\_\_\_\_ NORTHING (Y) \_\_\_\_\_

EASTING (X) \_\_\_\_\_ EASTING (X) \_\_\_\_\_

3RD ORDER COORDINATES STATE AND ZONE FLORIDA, MERCATOR WEST

FIELD BOOK \_\_\_\_\_ PAGE \_\_\_\_\_ SKETCH BY WGH

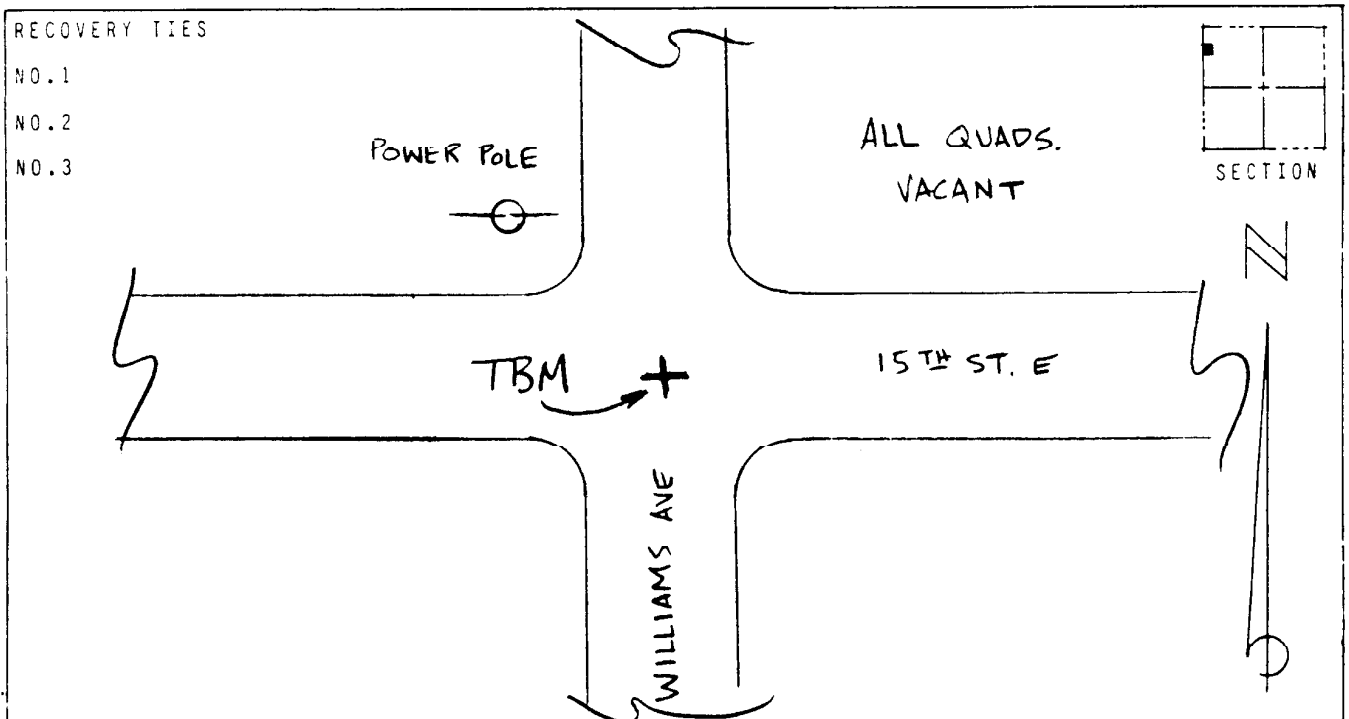

VERTICAL CONTROL ORIGINATED ON 2ND ORDER CONTROL ESTABLISHED BY N.G.S. AND F.D.O.T.

ON NATIONAL GEODETIC VERTICAL DATUM OF 1929

ELEVATION (FT) 21.43 3RD ORDER LEVEL BOOK V 21 PAGE 50