



LEE COUNTY, FLORIDA
AERIAL MAPPING PROJECT

MAPPING BY:
WOOLPERT CONSULTANTS

DESIGNATION LH 49 & TBM COUNTY LEE STATE FL
LOCATED IN SEC 16 TWP 44 S. RGE 27 E. USGS QUAD MAP OLGA
TO REACH SURVEY MARK FROM _____
AT INTERSECTION AS SHOWN IN LEHIGH ACRES

TYPE OF 2 ALUM. CAP ON RE-BAR
MARK 2 BLOWN TO DATE SET AUGUST 1988
HORIZONTAL CONTROL ORIGINATED ON 2ND ORDER CONTROL BY N.G.S. AND F.D.O.T.
ON NORTH AMERICAN DATUM OF 1927 (1927 ADJ) ON NORTH AMERICAN DATUM OF 1983
COORDINATES (FT) COORDINATES (FT)
NORTHING (Y) 822 535.123 NORTHING (Y) _____
EASTING (X) 622 522.999 EASTING (X) _____
3RD ORDER COORDINATES STATE AND ZONE FLORIDA, MERCATOR WEST

FIELD BOOK H8 PAGE 76 SKETCH BY DSW

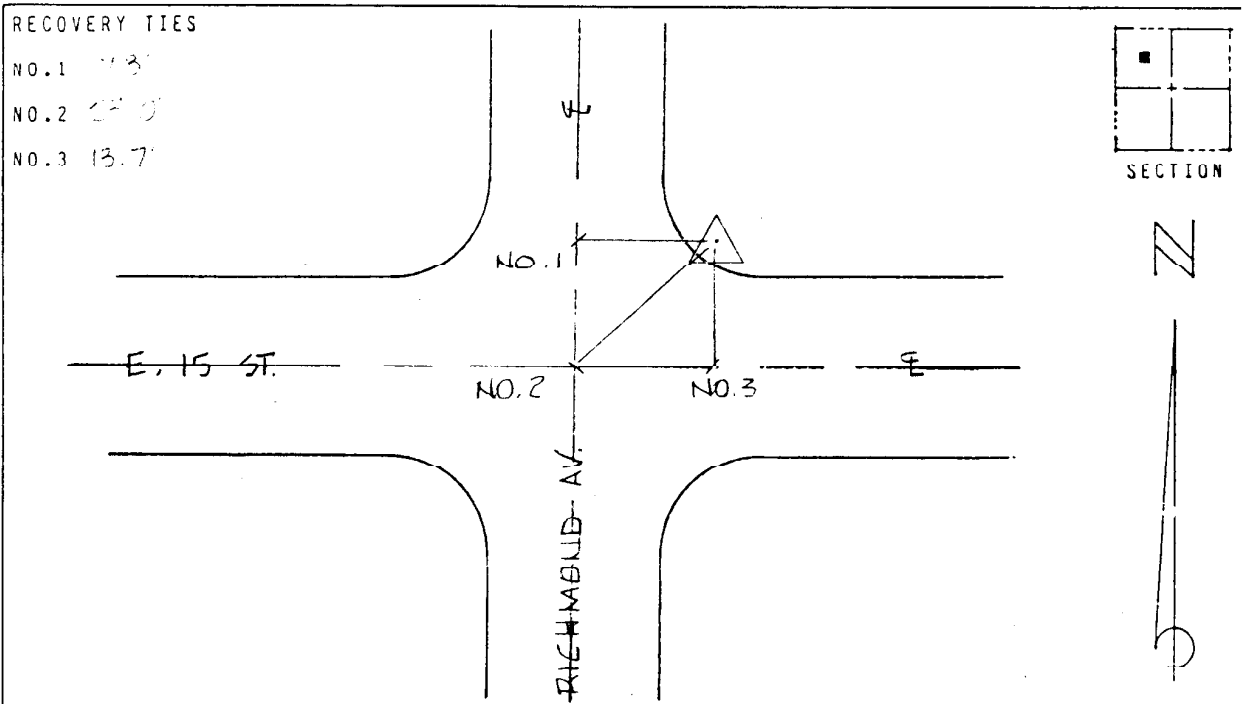

VERTICAL CONTROL ORIGINATED ON 2ND ORDER CONTROL ESTABLISHED BY N.G.S. AND F.D.O.T.
ON NATIONAL GEODETIC VERTICAL DATUM OF 1929
ELEVATION (FT) 21.93 . 3RD ORDER LEVEL BOOK V 18 PAGE 9