



Deni Associates
FORT MYERS, FLORIDA

LEE COUNTY, FLORIDA
AERIAL MAPPING PROJECT

MAPPING BY:
WOOLPERT CONSULTANTS

DESIGNATION TBM 20-22A COUNTY LEE STATE FL
 LOCATED IN SEC 13 TWP 04S RGE 27E USGS QUAD MAP ALVA
 TO REACH SURVEY MARK FROM _____
AT INTERSECTION AS SHOWN.
IN LEHIGH ACRES.

TYPE OF 3" SPIKE & 2" DENI DISC SET FLUSH IN PAVEMENT.
 MARK _____ DATE SET DEC. 1988
 HORIZONTAL CONTROL ORIGINATED ON 2ND ORDER CONTROL BY N.G.S. AND F.D.O.T.
 ON NORTH AMERICAN DATUM OF 1927 (1927 ADJ) ON NORTH AMERICAN DATUM OF 1983
 COORDINATES (FT) COORDINATES (FT)
 NORTHING (Y) _____ NORTHING (Y) _____
 EASTING (X) _____ EASTING (X) _____
3RD ORDER COORDINATES STATE AND ZONE FLORIDA, MERCATOR WEST

FIELD BOOK _____ PAGE _____ SKETCH BY RLIV

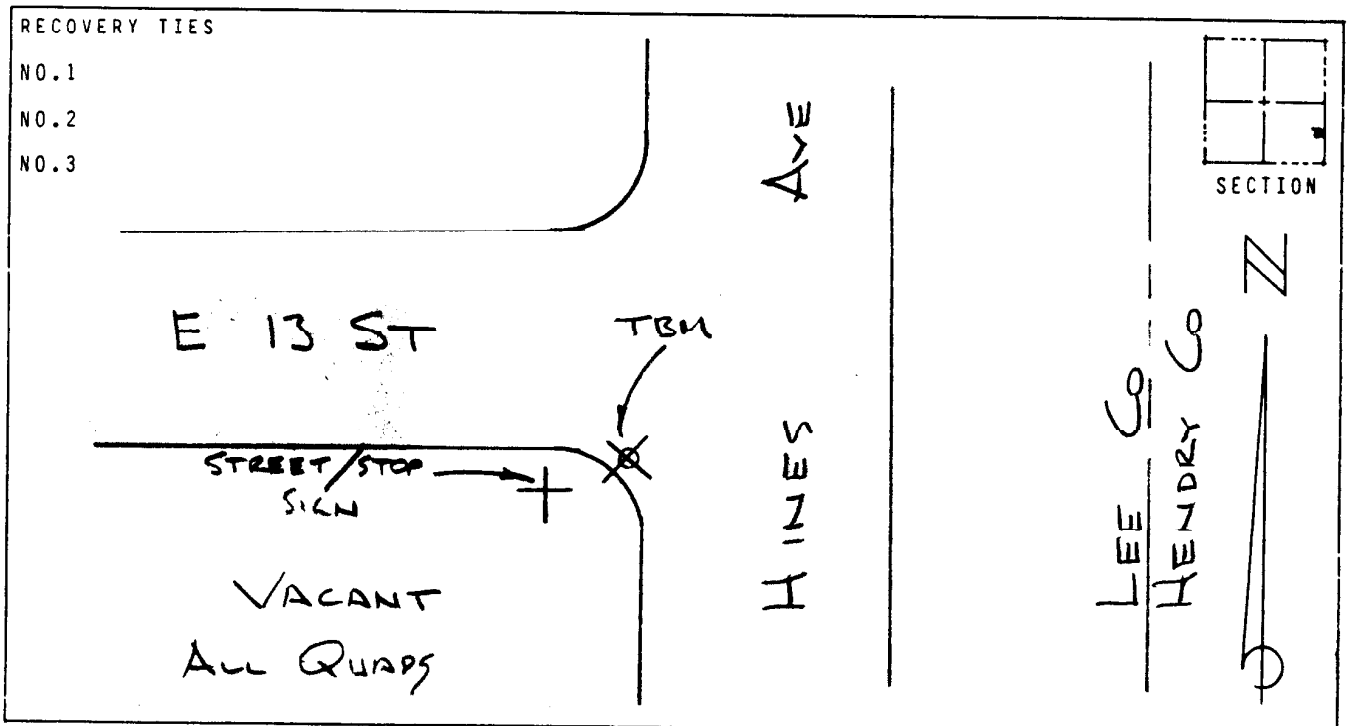

VERTICAL CONTROL ORIGINATED ON 2ND ORDER CONTRCL ESTABLISHED BY N.G.S. AND F.D.O.T.
 ON NATIONAL GEODETIC VERTICAL DATUM OF 1929
 ELEVATION (FT) 24.80 , 3RD ORDER LEVEL BOOK V20 PAGE 22